

A. 1823 W. Charleston #24
B. 1823 W. Charleston #25
C. 1823 W. Charleston #26

D. 1823 W. Chas. #27
E. 1823 W. Chas. #28

Lula Collins 4-23-82

CITY OF LAS VEGAS, NEVADA

3-65-001

LOT NO. & AREA

DEPARTMENT OF PUBLIC SERVICES
DIVISION OF BUILDING AND SAFETY

APPLICATION & BUILDING PERMIT - for:
Dwellings, Duplexes, Misc. Residential Const.

ADDRESS OF CONSTRUCTION

1823 W. Charleston

OWNER:

Ernest A. Quillen

LOT(s)

BLOCK

SUBDIVISION

ZONE: R-6

Existing structure on lot:

Dwelling

Accessory Bldgs.

Vacant Lot

Other

PROPOSED CONSTRUCTION

Mobile home set up

USE:

MATERIALS OF CONSTRUCTION:

Wood Frame

Concrete Block

Reinforced Concrete

Steel Frame

SQUARE FEET OF FLOOR AREAS: 1st

2nd

3rd

Other

TOTAL SQ. FT.

FIRE ZONE:

Occupancy Group

CONST. TYPE:

ARCHITECT:

ENGINEER:

NO. of UNITS

NO. of STORIES

Plans Submitted:

Yes

No

Calculations Submitted:

Yes

No

Sewer Fee Req'd.

Yes

No

CONTRACTOR:

Owner

STATE LICENSE #

CITY LICENSE #

ADD'L. PERMITS REQ'D.:

Air Cond.

Elec.

Plumbing

Signs

Paving

Fence

Public Walks

Curb-gutters

Incinerators

Fire Sprinkling System

CONDITIONS OF THE PERMIT:

1. I agree to call the City Building Department for inspections before concrete is poured, before rough wiring, electrical, plumbing, framing is covered. Also for Air conditioning, drywall and sheathing inspection.
2. I agree that when the job is completed that I will call for final inspection before occupancy.
3. I agree to perform all construction in accordance with City Ordinances and Building Codes.
4. The Contractor's signature below denotes authority from the owner to sign in his behalf and that the owner is aware of all requirements of this application and permit. Separate permits must be taken out for work outlined above this agreement.
5. I have read and understand the contents of this application and permit; I hereby state that the information I have supplied on this application is true and correct.

Approval for the work under this permit will be given only after refuse and debris have been removed from job site and public right of way. Separate permits are required for work within the public right of way.

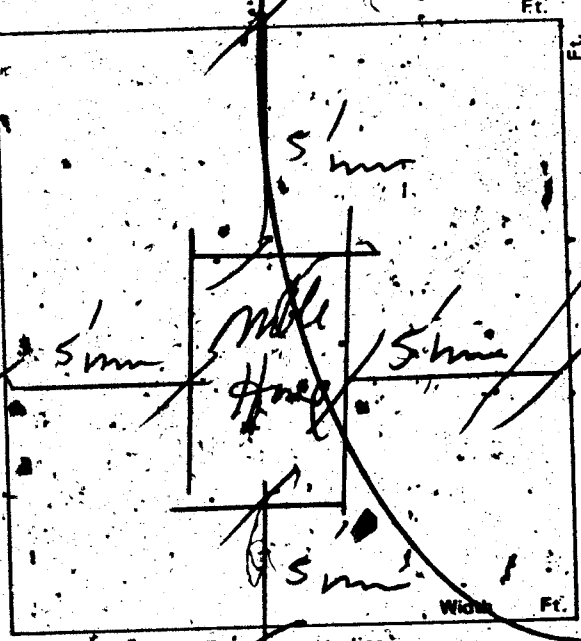

SIGNED: Ernest A. Quillen (Contractor)

BY: _____ (Agent or Owner)

PLANNING DEPT.:

[Signature]

Date:

4/9/82

PUBLIC WORKS DEPT.:

N/A

Date:

4-9-82

BUILDING DIVISION:

[Signature]

Date:

4/9/82

PERMIT NO.:

9588

PERMIT FEE \$

40.00

2300-2401

RECEIPT

MUST BE MACHINE VALIDATED

L. Collins

OWNER	Ernest A. Guillen ADDRESS 1823 W. Charleston #	
DATE	4/9/82	GEN. CONT. Owner 24
TYPE OF STRUCTURE	MOBILE HOME set up	
	PERMIT NO. 9588	FINAL INSPECTION
LEGAL DESCRIPTION	LOG NO.	AREA NO.
APPROVED FOR OCCUPANCY & METER		
BUILDING		MECHANICAL
Investigation		Plumbing Cont.
Location & Footing		Permit No. Date
Concrete Slab Floor		Heat & Vent. A/E Cont.
Fireplace Footing		Permit No. Date
Chimney Steel		Sewer Cont.
Vert. Steel Roof.		Permit No. Date
Horiz. Steel Roof.		Rough Soil
Framing		Rough Water
Ext. Lath		Top-Out
Ext. Brown		Rough Gas
Drywall		A/C Rough Duct
Final Building	25426-87	Final Plumbing
Appr. for Occu.		Final Gas
ELECTRICAL		Final Air Cond.
Temp. Pole Cont.		Final Sewer
Permit No.	Date	REMARKS
Inspection	Date	
Electrical Cont.		
Permit No.	Date	
Rough		PLEASE NOTE ADDITIONAL REMARKS ON REVERSE SIDE
Final Rough		DEPT. OF BLDG. & SAFETY
Final Electrical		CITY OF LAS VEGAS
Temporary Service		REV: 02-3-79

Sign Wisely 8-20-82

CITY OF LAS VEGAS, NEVADA

LOG NO. & AREA _____ CONST VAL \$ _____

DEPARTMENT OF PUBLIC SERVICES
DIVISION OF BUILDING AND SAFETY

APPLICATION & BUILDING PERMIT - for:
Dwellings, Dwellings, Misc. Residential Const.

ADDRESS OF CONSTRUCTION: 1823 W. Charleston Rd OWNER: Ernest Guillen

LOT(s) _____ BLOCK _____ SUBDIVISION: Pt NW 1/4 NE 1/4 Sec 4, T21S R4E ONE RE

Existing structure on lot: Dwelling Accessory Bldg. Vacant Lot Other

PROPOSED CONSTRUCTION: Shed USE: _____

MATERIALS OF CONSTRUCTION: Wood Frame Concrete Block Reinforced Concrete Steel Frame

SQUARE FEET OF FLOOR AREAS: 1st _____ 2nd _____ 3rd _____ Other _____ TOTAL SQ. FT. _____

FIRE ZONE: _____ Occupancy Group _____ CONST. TYPE: _____

ARCHITECT: _____ ENGINEER: _____ NO. of UNITS _____ NO. of STORIES _____

Plans Submitted: Yes No Calculations Submitted: Yes No Sewer Fee Req'd: Yes No

CONTRACTOR: Durwin STATE LICENSE # _____ CITY LICENSE # _____

ADD'L. PERMITS REQ'D.: Air Cond. Elec. Plumbing Signs Paving Fences Public Walks Curb-gutters
Incinerators Fire Sprinkling System

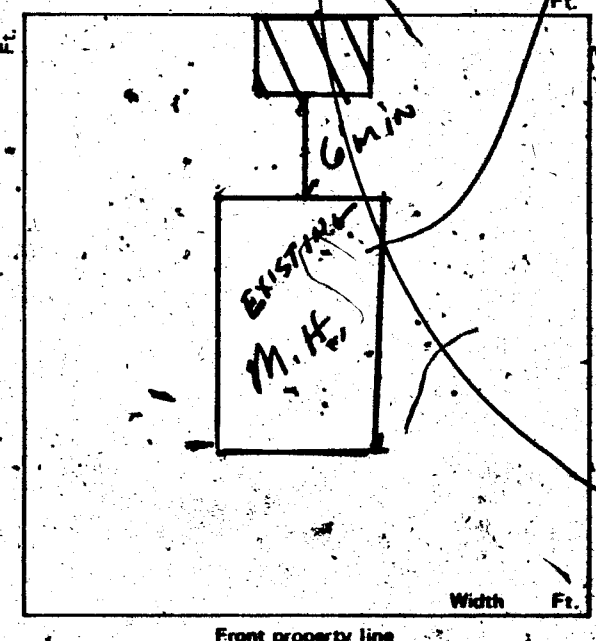

CONDITIONS OF THE PERMIT:

- I agree to call the City Building Department for inspections before concrete is poured, before rough wiring, electrical, plumbing, framing is covered. Also for Air conditioning, drywall and sheathing inspection.
- I agree that when the job is completed that I will call for final inspection before occupancy.
- I agree to perform all construction in accordance with City Ordinances and Building Codes.
- The Contractor's signature below denotes authority from the owner to sign in his behalf and that the owner is aware of all requirements of this application and permit. Separate permits must be taken out for work outlined above this agreement.
- I have read and understand the contents of this Application and permit; I hereby state that the information I have supplied on this application is true and correct.

Approval for the work under this permit will be given only after refuse and debris have been removed from job site and public right of way. Separate permits are required for work within the public right of way.

SIGNED: Ernest A. Guillen Contractor

BY: _____ Agent or Owner

IBILL \$ 0.00
MISC \$ 10.00
STL \$ 10.00
TOTL \$ 10.00

PLANNING DEPT.: [Signature] Date: 25 Aug 82

PUBLIC WORKS DEPT.: [Signature] Date: 8-25-82

BUILDING DIVISION: [Signature] Date: 8-25-82

PERMIT NO.: 3055 PERMIT FEE \$ 10.00

CASH \$ 10.00
RECEIVED
#3055 SR#001/01
CITY - LAS VEGAS
BLDG. & SAFETY
08/25/82

2300-2401

MUST BE MACHINE VALIDATED

Home Holding 12-21-82

OWNER Ernest Guilliam		ADDRESS 1823 W. Charleston	
DATE	8-25-82	GEN. CONT.	owner #24
TYPE OF STRUCTURE	shed	PERMIT NO.	3055
LEGAL DESCRIPTION	See application		
LOG NO.		AREA NO.	
APPROVED FOR OCCUPANCY & METER			
BUILDING		MECHANICAL	
Investigation		Plumbing Cont.	
Location & Footing		Permit No.	Date
Concrete Slab Floor		Heat & Vent. A/C Cont.	
Fireplace Footing		Permit No.	Date
Chimney Steel		Sewer Cont.	
Vert. Steel Reinf.		Permit No.	Date
Horiz. Steel Reinf.		Rough Soil	
Framing		Rough Water	
Ext. Lath		Top-Out	
Ext. Brown		Rough Gas	
Drywall		A/C Rough Duct	
Final Building	8-23-82	Final Plumbing	
Appr. for Occu.		Final Gas	
ELECTRICAL		Final Air Cond.	
Temp. Pole Cont.		Final Sewer	
Permit No.	Date	REMARKS	
Inspection	Date		
Electrical Cont.			
Permit No.	Date		
Rough		PLEASE NOTE ADDITIONAL REMARKS ON REVERSE SIDE	
Final Rough		DEPT. OF BLDG. & SAFETY	
Final Electrical		CITY OF LAS VEGAS	
Temporary Service		REV: 88-3-29	

Marjorie Francis 10-1-84

CITY OF LAS VEGAS, NEVADA

PHONE # _____

LOG NO. & AREA _____ DATE _____ CONST. VAL. \$ _____

DEPARTMENT OF BUILDING AND SAFETY

DEVELOPMENT PERMIT AND BUILDING PERMIT

FOR: Dwellings, Duplexes, Misc. Residential Const.

PHONE 386-6251

ADDRESS OF CONSTRUCTION 1823 W. Chino #28

OWNER Betty J. & Ford Miller

CONTRACTOR Owner

STATE LICENSE NO. _____

CITY LICENSE NO. _____

LOT(S) Block 4 Sec 4 T215 RR1B

ZONE R-1E

PROPOSED CONSTRUCTION Travel Trailer

USE _____

BUILDING PERMIT NO. 2103

ELECTRIC PERMIT NO. _____

PLUMBING PERMIT NO. _____

AIR COND. PERMIT NO. _____

ADD'L. PERMITS REQ'D: Air Cond. Elec. Plumbing Signs Paving Fence

Incinerators Fire Sprinkling System Off-Site Permit

MATERIALS OF CONSTRUCTION: Wood Frame Concrete Block Reinforced Concrete Steel Frame

SQUARE FEET OF FLOOR AREAS: 1st _____ 2nd _____ 3rd _____ Other _____ TOTAL SQ. FT. _____

ARCHITECT _____ ENGINEER _____ NO. OF UNITS _____ NO. OF STORIES _____

OTHER INSPECTIONS AND FEES

1. Inspections outside of normal business hours = \$25.00 per hour (minimum charge three hours)
2. Inspection fee during normal business hours assessed under provisions of TABLE 3-A of the Uniform Building Code = \$15.00 each
3. Inspections during normal business hours for which no fee is specifically indicated = \$15.00 per hour (minimum charge one half hour)
4. Additional plan review required by changes, additions or revisions at approved plans = \$25.00 per hour (minimum charge two hours)

CONDITIONS OF THE PERMIT:

1. I agree to call the City Building Department for inspections before concrete is poured, before rough wiring, electrical, plumbing, framing is covered. Also for air conditioning, drywall and sheathing inspection.
2. I agree that when the job is completed that I will call for final inspection before occupancy.
3. I agree to perform all construction in accordance with City Ordinances and Building Codes.
4. The Contractor's signature below denotes authority from the owner to sign in his behalf and that the owner is aware of all requirements of this application and permit. Separate permits must be taken out for work outlined above this agreement.
5. I have read and understand the contents of this application and permit. I hereby state that the information I have supplied on this application is true and correct.

Approval for the work under this permit will be given only after refuse and debris have been removed from job site and public right of way.

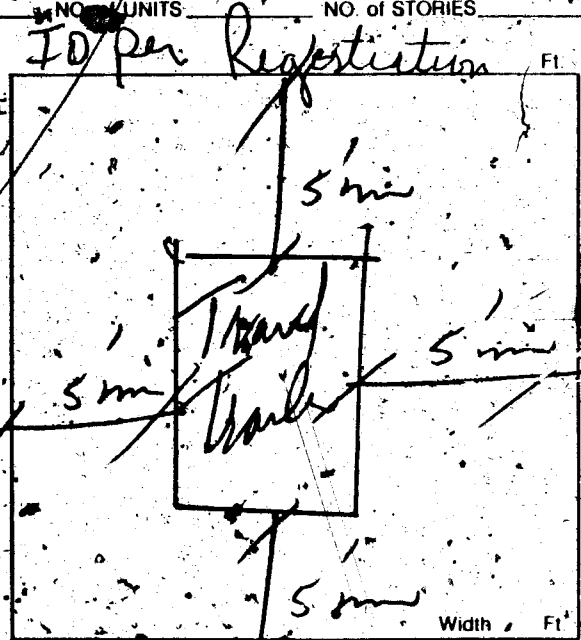

SIGNED Gary K. Miller CONTRACTOR

LICENSE DEPT. [Signature] DATE 9/27/84

PLANNING DEPT. M.S. DATE 9/27/84

BUILDING DEPT. _____ DATE _____

I hereby certify that I have reviewed this application and the proposed plans and have found that the proposed development meets the requirements of the City of Las Vegas Flood Hazard Reduction Ordinance for the issuance of this Development Permit # 2310-2401

Kent Nash 9-27-84
LAND DEVELOPMENT AND FLOOD CONTROL ENGINEER DATE

SEWER CONNECTION

7114-3654 DATE 09/27/84

FIXTURES X

PLAN REVIEW FEE _____

PERMIT FEE _____

TOTAL FEES 30

RECEIPT
 0004
 SFD 30.00
 CASH 30.00
 2103A000 13:35

Permit Expires 180 Days After Abandonment of Work

MUST BE MACHINE VALIDATED.

M. Wayne Francis 10-22-84

OWNER **Betty & Ford Miller** ADDRESS **1823 W. Chas. #28**
DATE **9-27-84** GEN. CONT. **owner**
TYPE OF STRUCTURE **travel trailer** PERMIT No. **2103**
LEGAL DESCRIPTION **SEE APPLICATION** LOG No. AREA No.
APPROVED FOR OCCUPANCY & METER

BUILDING		MECHANICAL	
Foundation & Footing		Plumbing Cont.	
Concrete Slab Floor		Permit No.	Date
Fireplace Footing		Htg. / Vt. / A.C. Cont.	
Chimney Steel		Permit No.	Date
Vert. Steel Reinf.		Sewer Cont.	
Horiz. Steel Reinf.		Permit No.	Date
Framing		Rough Soil	
Ext. Lath		Rough Water	
Roof Sheathing		Top-Out	
Ext. Brown		Rough Gas	
Insulation		A/C Rough Duct	
Drainage		Final Plumbing	
Final Building	RS 10-1784	Final Gas	
Appr. for Occu.		Final Air Cond.	
ELECTRICAL		Final Sewer	
Temp. Pole cont.		REMARKS	
Permit No.	Date		
Inspection	Date		
Electrical Cont.			
Permit No.	Date		
Rough			
Final Electrical			
Temporary Service			

PLEASE NOTE ADDITIONAL REMARKS ON REVERSE SIDE
DEPT. OF BLDG. & SAFETY
CITY OF LAS VEGAS
REV 82-3-29

Debbie Ingraham 2-25-85

CITY OF LAS VEGAS, NEVADA

LOG NO. & AREA _____ DATE _____ CONST. VAL. \$ _____

DEPARTMENT OF BUILDING AND SAFETY

BUILDING PERMIT - FOR: Single Family Dwelling, Remodel, Additions, Misc. Residential Construction

ADDRESS OF CONSTRUCTION 1823 W. Chas - #28 PHONE 386-6251 OWNER Mary E. Black PHONE NO. _____

LOT(S) RTE 1/2 N 1/2 E 1/4 S 1/4 T 24S R 6E BLDG. DIVISION _____ ZONE R-E

PROPOSED CONSTRUCTION Travel Trailer USE _____

THIS PERMIT FOR BLDG. AC ELEC. PLBG. OTHER PERMITS REQD.: FENCE OFF SITE SWIM POOL

FLOOR AREA SMT _____ 1ST _____ 2ND _____ GARAGE _____ PORCH _____ TOTAL _____

CONTRACTOR _____ STATE LICENSE NO. _____ CITY LICENSE NO. _____

ARCHITECT _____ ENGINEER _____

MASTER PLUMBER _____ MASTER ELECTRICIAN _____

OTHER INSPECTIONS AND FEES

1. Inspections outside of normal business hours = \$25.00 per hour (minimum charge three hours)
2. Re-inspection fee during normal business hours assessed under provisions of TABLE 3-A of the Uniform Building Code = \$15.00 per hour
3. Inspections during normal business hours for which no fee is specifically indicated = \$15.00 per hour (minimum charge one-half hour)
4. Final plan review required by changes, additions or revisions to approved plans = \$25.00 per hour (minimum charge one hour)

CONDITIONS OF THE PERMIT:

1. I agree to call the City Building Department for inspections before concrete is poured, before rough wiring, electrical, plumbing, framing is covered. Also for air conditioning, drywall and sheathing inspection.
2. I agree that when the job is completed that I will call for final inspection before occupancy.
3. I agree to perform all construction in accordance with City Ordinances and Building Codes.
4. The Contractor's signature below denotes authority from the owner to sign in his behalf and that the owner is aware of all requirements of this application and permit. Separate permits must be taken out for work outlined above this agreement.
5. I have read and understand the contents of this application and permit; I hereby state that the information I have supplied on this application is true and correct.
6. Approval for the work under this permit will be given only after refuse and debris have been removed from job site and public right of way.
7. 24 HOUR MINIMUM NOTICE REQUIRED FOR INSPECTIONS.

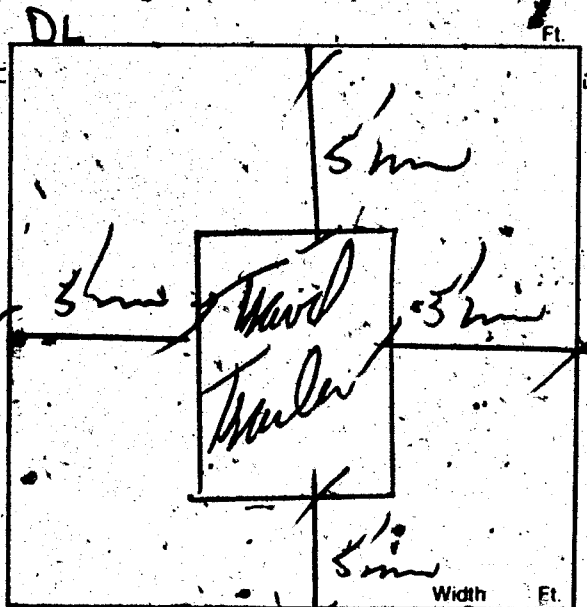

BY: Mary E. Black OWNER

BY: _____ AGENT

I hereby certify that I have reviewed this application and the proposed plans and have found that the proposed development meets the requirements of the City of Las Vegas Flood Hazard Reduction Ordinance for the issuance of this Development Permit.

NOT IN FLOOD ZONE 386-222-85 DATE

LAND DEVELOPMENT AND FLOOD CONTROL ENGINEER

PLANNING DEPT. _____ DATE

BUILDING DEPT. _____ DATE

PLUMBING	FEE	ELECTRICAL	FEE
WATER DISTRIBUTION	6.00	RECEPTACLE SWITCH	.40
SEWER SYSTEM - NEW OR MODIFICATION	10.00	EACH LIGHT FIXTURE OR SOCKET	.30
FIXTURES - WATER SOFTENER, H.W. HEATER	2.00	SPECIAL OUTLET, APPLIANCE ETC.	.70
GARBAGE DISPOSAL - WASHER	2.00	SERVICE/PANEL - SUB/3.00 - 200A/6.00 - 400A/12.50	
FUEL PIPING	6.00	A.C. UNIT OR MOTORS	3.00
GAS APPL. OR A/C UNIT - 3 TON = 6.00/OVER = 11.00		2310 - 2402	TOTAL
IRRIGATION SYSTEM	8.00	MISC.	
2310 - 2403	TOTAL	2310 - 2401 ISSUANCE FEE	
AIR-CONDITIONING	FEE	7114 - 3654 SEWER CONNECTION	
NEW UNIT - 3 TON = 6.00 OVER = 11.00		2310 - 2401 PLAN REVIEW FEE	
FURNACE TO 100,000/6.00 OVER/7.50		2310 - 2401 BLDG. PERMIT FEE	
VAPORATIVE COOLER	4.50	TOTAL FEES	<u>30-</u>
VENTILATION FAN	1.50		
2310 - 2405	TOTAL		

RECEIVED 04**
SFD 30.00
CASH 30.00
5802A000 11:29

PERMIT NO. 5802
MUST BE MACHINE VALIDATED

PERMIT EXPIRES 180 DAYS AFTER ABANDONMENT OF WORK

Delli Ingham 3-6-85

OWNER Mary Black		ADDRESS 1823 W. Chas. #28	
DATE 2-22-85		GEN. CONT. owner	
BUILD. TYPE travel trailer		PERMIT No. 5802	
LEGAL SEE APPLICATION		LOG No.	
BUILDING		MECHANICAL	
Pt. Loc. & Ft. <input type="checkbox"/>		Plumbing Cont.	
Location & Footing <input type="checkbox"/>		Permit No.	Date
Stemwall <input type="checkbox"/>		A/C Cont.	
Concrete Slab Floor <input type="checkbox"/>		Permit No.	Date
Chimney Steel <input type="checkbox"/>		Sewer Fog	
Fireplace Footing <input type="checkbox"/>		Irrig. Cont.	
Vert. Steel Reinf. <input type="checkbox"/>		Permit No.	Date
Horiz. Steel Reinf. <input type="checkbox"/>		Hood Cont.	
Roof Sheathing		Permit No.	Date
Insulation		Rough Soil <input type="checkbox"/>	
Framing		Rough Water <input type="checkbox"/>	
Ext. Lath		Top-Out	
Ext. Scratch		Rough Gas	
Ext. Brown		A/C Rough Duct.	
Drywall		Final Plumbing	
Final Building R33485		Final Gas	
Appr. for Occ. Final Building		Final Air Cond.	
		Final Sewer	
		Rough Hood <input type="checkbox"/>	
		Final Hood <input type="checkbox"/>	
		Final Irrig.	
ELECTRICAL			
Electrical Cont.			
Permit No.	Date		
PT Rough			
Ground Electrode		ELECTRICAL	
Temporary Power		Temp. Pole Cont.	
Meter Tag		Permit No.	Date
Final Electrical		Inspection	Date

JAKIE B.

1-30-86

[Empty box]

OWNER Ehmer Wikan ADDRESS 1823 W. Charleston

DATE 11-29-83 GEN. CONT. Owner #43

TYPE OF STRUCTURE Travel Trailer & sheds PERMIT NO. 4558 FINAL INSPECTION

LEGAL DESCRIPTION "SEE APPLICATION" LOG NO. AREA NO.

APPROVED FOR OCCUPANCY & METER

BUILDING		MECHANICAL	
Investigation		Plumbing Cont.	
Location & Footing		Permit No.	Date
Concrete Slab Floor		Heat & Vent. A/C Cont.	
Fireplace Footing		Permit No.	Date
Chimney Steel		Sewer Cont.	
Vert. Steel Reinf.		Permit No.	Date
Horiz. Steel Reinf.		Rough Soil	
Framing		Rough Water	
Ext. Lath		Top-Out	
Ext. Brown		Rough Gas	
Drywall	<u>Travel Trailer only R92-4482</u>	Rough Duct	
Final Building		Final Plumbing	
Appr. for Occu.		Final Gas	
ELECTRICAL		Final Air Cond.	
Temp. Pole Cont.		Final Sewer	

Permit No.	Date	REMARKS
Inspection	Date	

Permit No.	Date
Electrical Cont.	

Rough	Final Building	Final Electrical	Temporary Service

PLEASE NOTE ADDITIONAL REMARKS ON REVERSE SIDE.
 DEPT. OF BLDG. & SAFETY
 CITY OF LAS VEGAS
 REV: 82-3-29