

100 BREEZE CT.

LOT 34 BK 5 CHARLESTON RAINBOW #12-B ZNE R-1

D. Gatewood 1-30-79

CITY OF LAS VEGAS, NEVADA

LOG NO. & AREA 722-3  
DEPARTMENT OF BUILDING & SAFETY

CONST. VAL. \$ 30584

APPLICATION & BUILDING PERMIT — for:  
Dwellings, Duplexes, Multiple Residential Const.

ADDRESS OF CONSTRUCTION: 100 Breeze Court

OWNER: Sproul Homes of Nevada

LOT(s) 34 BLOCK 5 SUBDIVISION Charleston Rainbow Unit No. 12-B ZONE: R-1

Existing structure on lot: Dwelling  Accessory bldg.  Vacant lot  Other

PROPOSED CONSTRUCTION: Single Family Dwelling USE: Same

MATERIALS OF CONSTRUCTION: Wood Frame  Concrete Block  Reinforced Concrete  Steel Frame

SQ. FEET OF FLOOR AREAS: 1st 1632 2nd 484 3rd 0 Other 0 TOTAL SQ.-FT. 2116

FIRE ZONE: 1 2 3 Occupancy Group: 1 1-2 CONST. TYPE I II III IV V

ARCHITECT: \_\_\_\_\_ ENGINEER: \_\_\_\_\_ NO. of UNITS 1 NO. of STORIES 1

Plans Submitted: Yes  No  Calculations Submitted: Yes  No  Sewer Fee Req'd. Yes  No

CONTRACTOR: Sproul Homes of Nevada STATE LICENSE # 6011B CITY LICENSE # 6427

ADD'L. PERMITS REQ'D: Air Cond.  Elec.  Plumbing  Signs  Paving  Fence  Public Walks  Curb-gutters   
Incinerators  Fire Sprinkling System

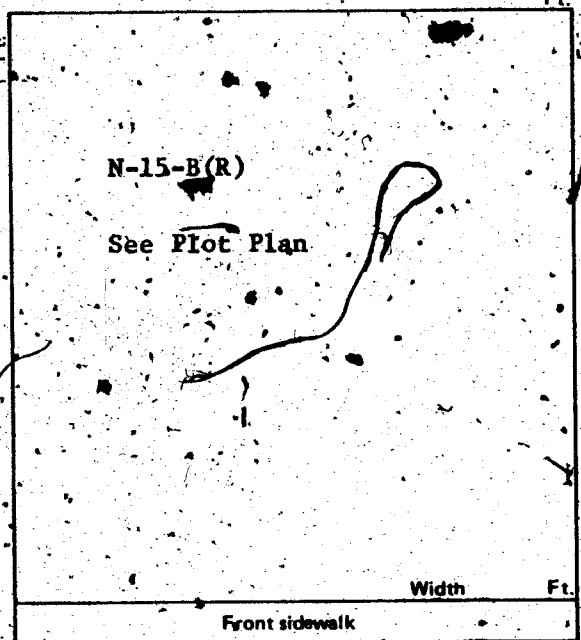

CONDITIONS OF THE PERMIT:

- 1. I agree to call the City Building Department for inspections before concrete is poured, before rough wiring, electrical, plumbing, framing is covered. Also for air conditioning, sheet-rock and sheathing inspection.
- 2. I agree that when the job is completed that I will call for final inspection before occupancy.
- 3. I agree to perform all construction in accordance with City Ordinances and Building Codes.
- 4. The Contractor's signature below denotes authority from the owner to sign in his behalf and that the owner is aware of all requirements of this application and permit. Separate permits must be taken out for work outlined above this agreement.
- 5. I have read and understand the contents of this application and permit; I hereby state that the information I have supplied on this application is true and correct.

Approval for the work under this permit will be given only after refuse and debris have been removed from job site and public right of way.

SIGNED: SPROUL HOMES OF NEVADA Contractor

BY: [Signature] Agent or Owner

CLARK COUNTY HEALTH DEPT. \_\_\_\_\_ Date \_\_\_\_\_  
LAS VEGAS FIRE DEPARTMENT \_\_\_\_\_ Date \_\_\_\_\_

PLANNING DEPT.: [Signature] Date: 12/22/75  
PUBLIC WORKS DEPT.: [Signature] Date: 12-22  
BUILDING DEPT.: [Signature] Date: 12/22/75  
# 12850 PERMIT NO.: 5420 PERMIT FEE \$ 119.00

RECEIPT  
4935 \$119.00 - 8  
CITY OF LAS VEGAS  
DEPT. OF BUILDING & SAFETY  
MUST BE MACHINE VALIDATED  
- 5 JUN 76

G. Gatewood 1-30-79

CITY OF LAS VEGAS, NEVADA  
DEPARTMENT OF BUILDING & SAFETY

RECEIPT  
FOR  
SEWER CONNECTION FEE

JOB ADDRESS: 100 Breeze Court OWNER'S NAME: Sproul Homes of Nevada

LOT 34 BLOCK 5 SUBDIVISION Charleston Rainbow Unit No. 12-B

QUANTITY	OCCUPANCY	UNIT FEE	AMOUNT
1	Sewer Connection Fee for SFD		\$150.00

PAID BY: <u>Sproul Homes of Nevada</u>	TOTAL <u>\$150.00</u>
	Less Credit <u>    </u>
	TOTAL FEE \$ <u>150.00</u>

\*Credit for existing sewer is applied to the new sewer connection fee based on previous type of occupancy and only when the new occupancy requires an additional fee

This receipt does not authorize the owner or his representative to start any work without obtaining a plumbing permit.

WRG  
DEPARTMENT OF BUILDING & SAFETY

12/22/75  
DATE

RECEIPT NO. 3307 SEWER FEE \$ 150.00

# 73102

RECEIPT  
4969. \$150.00 - 3  
CITY OF LAS VEGAS  
DEPT. OF BUILDING & SAFETY  
MUST BE MACHINE VALIDATED

G. Gatewood 1-30-79

### CITY OF LAS VEGAS, NEVADA

#### DEPARTMENT OF BUILDING & SAFETY - ELECTRICAL APPLICATION & PERMIT

ADDRESS OF CONSTRUCTION: 100 Breeze Court

OWNER'S NAME: Special

CIRCLE: New Bldg.; Add'n.; Remodel; TYPE OF BLDG.: SFD. APT. PUBLIC COMM.

CONTRACTOR'S NAME: Roberts Electric

STATE LICENSE # 4528

CITY LICENSE # 5392

NUMBER	FIXTURE OR INSTALLATION	UNIT PRICE	TOTAL
	Rm addition, carport or garage enclosure	4.00	
	Temporary power	4.00	
67	Light, receptacle or switch outlet	.20	13.40
	Wall or ceiling space heater	.35	
1	Garbage grinder outlet	.35	.35
	Dishwasher outlet	.35	
	Clothes dryer outlet	.35	
	Automatic clothes washer	.35	
1	Electric range outlet	.35	.35
	Electric water heater outlet	.35	
	Special purpose outlet	.35	
	X-ray unit and its appurtenances	5.00	
	Watts of festoon lighting (Watts) First 3,000 watts for each additional thousand watts	4.00 1.50	
	Horsepower each motor first horsepower or less for each additional horsepower	1.75 .35	
1	Electric service (including any single meter socket) for each additional socket	3.00 .35	3.00
1	Air conditioning service	1.50	1.50
	Each KW(KVA) Generator (Transformer, Welder) First 100 KVA for each additional KW(KVA)	2.00 .01	
	Speaker, signal or alarm outlet	.15	
	Amplifiers	.50	
	Control panels	.25	
	Main control racks	1.00	
	T.V. and radio antennas-master system only	.75	
	Minimum fee for any permit	4.00	
	TOTAL FEE		18.00

Approval for the work under this permit will be given only after refuse and debris have been removed from job site and public right of way.

I hereby certify that I have carefully examined and read the above application; that the same is true and correct; and that the work herein described is to be done in accordance with all the provisions of the applicable Ordinances of the City of Las Vegas, Nevada and State laws whether herein specified or not.

SIGNED RP Waugh  
MASTER (ELECTRICIAN) (TECHNICIAN) (OWNER)

DATE

BUILDING DEPARTMENT LH

DATE 1-12-79

#12860

PERMIT NO. 72

PERMIT FEE: \$ 18.00

RECEIPT  
5328 \$018.60 - 6  
CITY OF LAS VEGAS  
DEPT. OF BUILDING & SAFETY  
MUST BE MACHINE VALIDATED  
1-2-79

D. Gatewood - 1-30-79

**CITY OF LAS VEGAS, NEVADA**

34-5

**DEPARTMENT OF BUILDING & SAFETY - APPLICATION AND PERMIT FOR PLUMBING**

ADDRESS OF CONSTRUCTION: 100 BREEZE COURT OWNER'S NAME: SPRAWL HOMES INC.

CIRCLE: New Bldg. Add'n.; Remodel; TYPE OF BLDG. SFD APT. PUBLIC COMM.

CONTRACTOR'S NAME: UNITED PLUMBER STATE LICENSE # 1295 CITY LICENSE # 904

UNITS	DESCRIPTION	FEE	TOTAL
1	Bathtub	1.00	1-
1	Shower	1.00	1-
2	Lavatory	1.00	2-
2	Toilet	1.00	2-
	Urinal	1.00	
	Floor Drain	1.00	
	Floor Sink	1.00	
	Wash Tray	1.00	
1	Sink	1.00	1-
	Garbage Disposal	1.00	
	Garbage Disposal (comm.)	3.00	
	Clothes Dryer (gas)	1.00	
1	Clothes Washer	1.00	1-
	Clothes Washer (comm.)	5.00	
	Dishwasher	1.00	
	Dishwasher (commercial)	5.00	
	Dental Unit	10.00	
	Drinking Fountain	1.00	
	Any Water using Equipment	1.00	
1	Water Heater (gas) (elect.)	1.00	1-
1	Sewer System - New, Replacement, or any Drainage System	4.00	4-
	Grease or Sand Trap	2.00	
	Trailer Trap	2.00	
	Septic Disposal System	4.00	
WATER SOFTENERS			
	Nonpermanent Type	4.00	
	Permanent Type (connected to Drainage)	5.00	
SWIMMING POOLS			
	Private or Wading Pool	10.00	
	Public or Semi-public	20.00	

UNITS	DESCRIPTION	FEE	TOTAL
WATER-DISTRIBUTION SYSTEM			
1	Single Family Dwelling	4.00	4-
	Multiple Family Dwelling plus each unit	4.00	
		2.00	
	Bldg. Group "A" thru "G" per each floor	6.00	
	Hotel or Motel plus each bath	4.00	
		1.50	
	Trailer Park plus each space	20.00	
		1.00	
	Irrigation	4.00	
GAS PIPING SYSTEM			
1	Single Family Dwelling	3.00	3-
	Multiple Family Dwelling plus each unit	6.00	
		1.00	
	Commercial Bldg. per floor plus each unit	3.00	
		3.00	
	Gas Appliance (any type)	1.00	
AUTOMATIC FIRE EXTINGUISHING SYSTEM			
	Underground Piping	10.00	
	Distribution Piping ea. ft.	.01	
	Sprinkler Head each	.10	
	In Range Hood and Vent	5.00	
DRY STANDPIPE SYSTEM			
	Piping	50.00	
	Each Outlet	1.00	
WET STANDPIPE SYSTEM			
	Piping	5.00	
	Fire Hose Cabinet	1.00	
MINIMUM PERMIT FEE 4.00			
PIPELINE CONTRACTOR; SECT. 14-B.P.F. \$			
TOTAL PERMIT FEE \$ <u>20-</u>			

I hereby certify that I have carefully examined and read the above application; that the same is true and correct; and that the work herein described is to be done in accordance with all the provisions of the applicable Ordinances of the City of Las Vegas, Nevada and the State Laws, whether herein specified or not.

Approval for the work under this permit will be given only after refuse encumbrances have been removed from job site and public right of way.

Signed: [Signature] Date: 1-5-76  
 Registered Master Plumber, Spec. Contr. or Owner  
 Building Department: N Miller Date: 1-13-76  
 Permit No. 116 Permit Fee \$ 20-

#12870

RECEIPT  
 5430 \$020.00 - 7  
 CITY OF LAS VEGAS  
 DEPT. OF BUILDING & SAFETY  
 MUST BE MACHINE VALIDATED  
13 JAN 76

H. Gatewood 1-30-79

**CITY OF LAS VEGAS, NEVADA**

**DEPARTMENT OF BUILDING & SAFETY - AIR CONDITIONING APPLICATION & PERMIT**

ADDRESS OF CONSTRUCTION: 100 Breeze Court OWNER'S NAME: Sproul Homes

CIRCLE: Addition; Remodel; New Bldg TYPE OF BLDG.: SFD APT. COMM. PUBLIC

CONTRACTOR'S NAME: Gearing Air Conditioning STATE LICENSE # 6058 CITY LICENSE # 7618

UNITS	DESCRIPTION	FEE	TOTAL	UNITS	DESCRIPTION	FEE	TOTAL
	Unit heater - floor, wall or suspended	4.00			<b>EVAPORATIVE COOLERS:</b>		
	FOR EACH FORCED-AIR OR GRAVITY-TYPE FURNACE OR BURNER INCLUDING DUCTS AND VENT ATTACHED TO SUCH APPLIANCES:				5 outlets or under	3.00	
	Up to and including 100,000 B.t.u.'s	4.00			Over 5 and up to and including 10	5.00	
	Over 100,000 B.t.u.'s	6.00			Each additional outlet over 10	.25	
	FOR EACH HEATING APPLICATION, REFRIGERATION UNIT, COMFORT COOLING AND HEATING UNIT, ABSORPTION UNIT, COMPRESSOR OR BOILER:				<b>VENTILATION:</b>		
	Up to and including 3 ton or horsepower, or absorption system up to and including 100,000 B.t.u.'s	4.00		3	For each fan connected to a single duct	1.00	3.00
1	Over 3 ton or 3 horsepower up to and including 10, or absorption system over 100,000 B.t.u.'s up to and including 250,000 B.t.u.'s	7.00	7.00		For each commercial or industrial ventilation system	5.00	
	Over 10 ton or 10 horsepower up to and including 30, or absorption system over 250,000 B.t.u.'s up to and including 1,000,000 B.t.u.'s	12.00			For each commercial kitchen hood	5.00	
	Over 30 ton or 30 horsepower up to and including 50, or absorption system over 1,000,000 B.t.u.'s up to and including 1,700,000 B.t.u.'s	30.00			<b>MISCELLANEOUS:</b>		
	Over 50 ton or 50 horsepower, or absorption system over 1,700,000 B.t.u.'s	30.00			For each water cooling tower	8.00	
	FOR EACH AIR HANDLING UNIT INCLUDING DUCTS ATTACHED THERETO:				Duct work only - each opening	.25	
	Up to and including 10,000 CFM	2.00			For installation or relocation of each commercial or industrial incinerator	15.00	
	Over 10,000 CFM	4.00			Gas piping related to the air cond. work in single family dwelling only	3.00	
					For each appliance, piece of equipment, any mechanical work or alteration or replacement not included in this schedule, the permit fee shall be computed the same as building permit fees by using the cost of installation for the valuation amount.		
					<b>FOR THE ISSUANCE OF EACH PERMIT</b>		3.00
					<b>TOTAL PERMIT FEE \$</b>	<b>13.00</b>	

I hereby certify that I have carefully examined and read the above application; that the same is true and correct; and that the work herein described is to be done in accordance with all the provisions of the applicable Ordinances of the City of Las Vegas, Nevada and the State Laws, whether herein specified or not.

Approval for the work under this permit will be given only after refuse and debris have been removed from job site and public right of way.

SIGNED [Signature] Date 1-29-76  
Air Conditioning Contractor - Owner

BUILDING DEPARTMENT LH Date 2-2-76

PERMIT NO. 104 PERMIT FEE \$ 13.00

RECEIPT  
6410 \$013.00 - 4  
CITY OF LAS VEGAS  
DEPT. OF BUILDING & SAFETY  
MUST BE MACHINE VALIDATED

H. Gatewood 1-30-79

9-07

CITY OF LAS VEGAS, NEVADA

CONSTR. VAl. \$ 564

LOG NO. & AREA DEPARTMENT OF BUILDING & SAFETY

APPLICATION & BUILDING PERMIT - for: Fence, Wall, Retaining Wall.

ADDRESS OF CONSTRUCTION: 100 BREEZE COURT OWNER: ALBERT L. GUISLER

LOT(s) 34 BLOCK 5 SUBDIVISION Charlotte Rainbow D-13 ZONE R-1

Materials of Construction: Block [X] Concrete [ ] Wire [ ] Wood [ ] Other [ ]

PLANS: [ ] [ ] CALCS: [ ] [ ]

ARCHITECT: ENGINEER:

CONTRACTOR: OWNER STATE LICENSE # CITY LICENSE #

TOTAL SQUARE FEET: TOTAL LINEAL FEET: 80'

Remarks:

CONDITIONS OF THE PERMIT:

- 1. Any type of retaining wall must be engineered by a Civil or Structural Engineer.
2. If a home owner takes out the Building Permit and if the owner sublets the work to a Contractor, then the Contractor must take out the permit and pay for it.
3. No fence or wall can be built on City property or rights-of-way, but this is not intended to preclude construction within utility easements if utilities will not be damaged or made inaccessible.
4. The fence or wall shall not enclose any water meter, light standard, or fire alarm box and shall not come closer than 24" from the nearest fire hydrant outlet.
5. Department inspectors must approve footings before concrete is poured and block wall reinforcing before grouting is done.
6. Maximum height of any wall or fence is 6', side and rear yards; 4' maximum in front yard with the vertical surface above the height of 2' - 50% open.
7. I must not obstruct required onsite parking space (2 spaces for each dwelling unit) by the erection of this fence or wall.
8. By the signing of this application I herewith agree to the requirements outlined above.

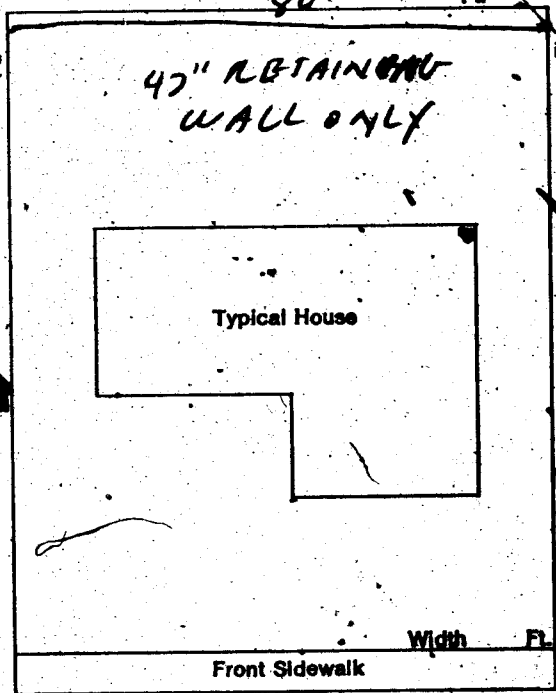

SIGNED: [Signature] DATE: [ ] [ ] [ ]

CONTRACTOR [ ] AGENT [ ] OWNER [ ]

PLANNING DEPT: [Signature] Date: 1-18-77

PUBLIC WORKS DEPT: Date:

BUILDING DEPT: [Signature] Date:

PERMIT NO: 280 PERMIT FEE \$ 800

154-01-220

RECEIPT 3299 \$800.00 - 8 CITY OF LAS VEGAS MUST BE MACHINE VALIDATED

J. Gatorwood 12-6-79

16-01

CITY OF LAS VEGAS, NEVADA

CONST. VAL. \$ 1950<sup>00</sup>

LOG NO. & AREA

DEPARTMENT OF PUBLIC SERVICES  
DIVISION OF BUILDING & SAFETY

APPLICATION & BUILDING PERMIT - for:  
Fence, Wall, Retaining Wall

ADDRESS OF CONSTRUCTION: 100 BEEBEE CR. OWNER: CARLO NUNDA

LOT(s) 34 BLOCK 5 SUBDIVISION Char. Number 12-B ZONE R-1

Materials of Construction: Block  Concrete  Wire  Wood  Other  PLANS:

ARCHITECT: ENGINEER: CALCS:

CONTRACTOR: ENCINO STATE LICENSE # 13178 CITY LICENSE # 6116749

TOTAL SQUARE FEET: 780 TOTAL LINEAL FEET: 130'

Remarks:  
130' x 6' block

CONDITIONS OF THE PERMIT:

1. Any type of retaining wall must be engineered by a Civil or Structural Engineer.
2. If a home owner takes out the Building Permit and if the owner sublets the work to a Contractor, then the Contractor must take out the permit and pay for it.
3. No fence or wall can be built on City property or rights-of-way, but this is not intended to preclude construction within utility easements if utilities will not be damaged or made inaccessible.
4. The fence or wall shall not enclose any water meter, light standard, or fire alarm box and shall not come closer than 24" from the nearest fire hydrant outlet.
5. Department Inspectors must approve footings before concrete is poured and block wall reinforcing before grouting is done.
6. Maximum height of any wall or fence is 6', side and rear yards: 4' maximum in front yard with the vertical surface above the height of 2' - 50% open.
7. I must not obstruct required onsite parking space (2 spaces for each dwelling unit) by the erection of this fence or wall.
8. By the signing of this application I herewith agree to the requirements outlined above.

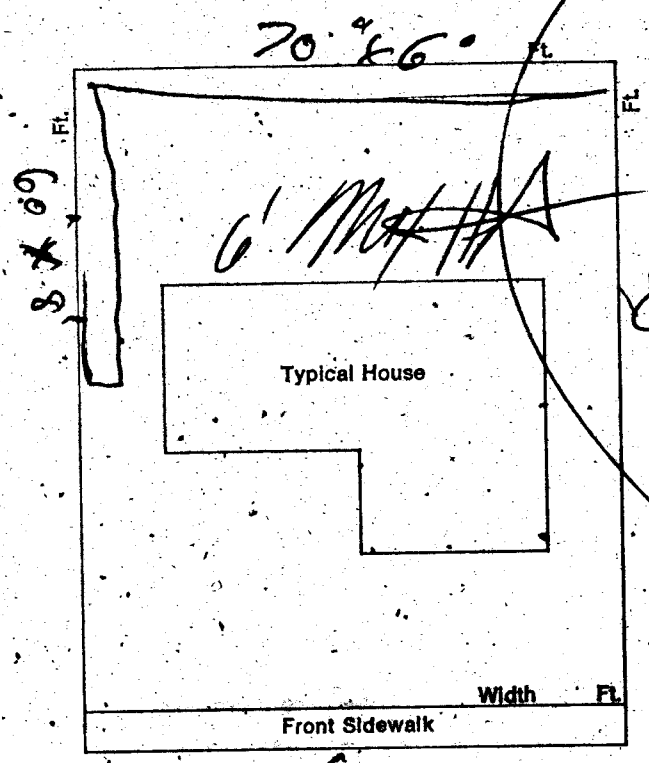

SIGNED: [Signature] DATE: 10/26/79  
CONTRACTOR  AGENT  OWNER

PLANNING DEPT: [Signature] Date: 10-26-79  
PUBLIC WORKS DEPT: [Signature] Date: 10/26/79  
BUILDING DIVISION: [Signature] Date: 10/26/79  
PERMIT NO: 7959-a PERMIT FEE \$ 1500

RECEIPT  
MUST BE MACHINE VALIDATED

FENCE & RETAINING WALLS		
OWNER Carlo Manda	DATE 10-26-78	
ADDRESS 100 Essex Ct.		
CONTRACTOR Mucino Const.	PERMIT NO. 7959-2	FINAL INSPECTION BIR wall
LOT 24	BLOCK 5 Char Rainbow	SUBDIVISION 2-B
AREA		

FENCES (wire, wood, block, & retaining walls)

1	Location	
2	Footings	B.M. 7-24-80
3	Wall Section	
	1st	2nd
4	Bond Beam	
	1st	2nd
5	Final	
		B.M. 7-24-80

Specify Type Of Fence

DEPT. of BLDG. & SAFETY - CITY of LAS VEGAS, NEVADA  
 OWNER Sproul Homes ADDRESS 100 Breeze Court DATE 1-2-76  
 GEN. CONT. Same TYPE OF STRUCTURE SFD & FP  
 PERMIT NO. 5420 LEGAL DESCRIPTION L 34 B 5 Charleston Rainbow unit 12 B

BUILDING	MECHANICAL	ELECTRICAL
Investigation	Plumbing Cont. <u>Unit 1</u>	Temp. pole cont.
Location & Footing <u>BW 1-8-76</u>	Permit No. <u>116</u> Date <u>1-18-76</u>	Permit No. _____ Date _____
Stem Wall <u>BW 1-14-76</u>	Heat & Vent. A/C Cont. <u>Gas</u>	Inspection _____ Date _____
Concrete Slab Floor <u>BW 1-22-76</u>	Permit No. <u>104</u> Date <u>2-2-76</u>	Electrical Cont. <u>Roberts</u>
Floor Framing	Sewer Cont. <u>Sproul Homes</u>	Permit No. <u>72</u> Date <u>1-2-76</u>
Fireplace Footing	Permit No. <u>3307</u> Date _____	Fixtures Cont. _____
Chimney Steel	Rough Soil <u>WEP 1-15-76</u>	Permit No. _____ Date _____
Vert. Steel Reinf.	Rough Water <u>WEP 1-15-76</u>	Slab _____
Horiz. Steel Reinf.	Top-Out <u>WEP 2-18-76</u>	Rough <u>HD 2-18-76</u>
Roof Sheathing <u>Q 9 2-16-76</u>	Rough Gas _____	Final Rough _____
Framing <u>BW 2-2-76</u>	A/C Rough Duct <u>WEP 2-2-76</u>	Final Fixture _____
Backing for siding	Ref. Rough Piping _____	Final Electrical <u>HD 3-18-76</u>
Ext. Lath	Final Plumbing <u>WEP 3-17-76</u>	Temporary Service _____
Ext. Scratch	Final Gas <u>WEP 3-17-76</u>	MISCELLANEOUS
Ext. Brown	Final Air Cond. <u>WEP 3-17-76</u>	Grading & Drainage _____
Int. Lath	Final Refrig. _____	On-Site Parking Spaces _____ App _____
Int. Brown	Final Sewer <u>WEP 2-11-76</u>	Eng. Approval of _____
Drywall <u>BW 2-17-76</u>	Final Septic Tank _____	Off-Site Improvements _____
Permit No. _____		
Final Building <u>BW 3-18-76</u>		
Appr. for Occu. _____		

INSPECTOR: \_\_\_\_\_ DATE \_\_\_\_\_  
 APPROVED FOR OCCUPANCY & METER BW 3-18-76  
 PLEASE NOTE REMARKS ON REVERSE SIDE 100 Breeze Court LOG # \_\_\_\_\_ AREA # \_\_\_\_\_ T 22-3

DEPARTMENT OF BUILDING & SAFETY  
 CITY OF LAS VEGAS, NEVADA  
 OWNER Albert Gesler ADDRESS 100 Breeze Court DATE 1-18-77  
 CONTRACTOR Owner PERMIT NO. 280

KARDEX CARD  
 FENCE & RETAINING WALLS

Fence (wire, wood, etc.)	Walls (masonry, rock, etc.)
Location _____	Location <u>SE 1-25-77</u>
Final Inspection _____	Footing <u>SE 1-25-77</u>
	Wall Steel 1st <u>SE 1-25-77</u> 2d _____ 3d _____
	Final Inspection _____
Retaining Wall (masonry)	Retaining Wall (concrete)
Location _____	Location _____
Footing _____	Footing _____
Wall Steel 1st _____ 2d _____ 3d _____	Wall Steel 1st _____ 2d _____ 3d _____
Bond Beam 1st _____ 2d _____ 3d _____	Final Inspection _____
Final Inspection _____	