

4816 APALIANA

LOT 4 BLK12 GOLFRIDGE TREEACR #5 ZONE R-1

Howe Jan 1979

1967

CITY OF LAS VEGAS, NEVADA

LOG NO. & AREA \_\_\_\_\_ CONST. VAL. \$ \_\_\_\_\_  
DEPARTMENT OF BUILDING & SAFETY APPLICATION & BUILDING PERMIT for:

ADDRESS OF CONSTRUCTION: 4816 Apawana Lane OWNER: FHA  
Dwellings, Duplexes, Misc. Residential Const.

LOT(s) 4 BLOCK 12 SUBDIVISION Hollyridge Terrace #5 ZONE: R-1

Existing structure on lot: Dwelling  Accessory bldgs.  Vacant lot  Other

PROPOSED CONSTRUCTION: Rehabilitate House USE: \_\_\_\_\_

MATERIALS OF CONSTRUCTION: Wood Frame  Concrete Block  Reinforced Concrete  Steel Frame

SQUARE FEET OF FLOOR AREAS: 1st \_\_\_\_\_ 2nd \_\_\_\_\_ 3rd \_\_\_\_\_ Other \_\_\_\_\_ TOTAL SQ. FT. \_\_\_\_\_

FIRE ZONE: 1 2 3 Occupancy Group A B C D E F G H I J-1-2-3-4-5 CONST. TYPE: I II HI IV V

ARCHITECT: \_\_\_\_\_ ENGINEER: \_\_\_\_\_ NO. of UNITS \_\_\_\_\_ NO. of STORIES \_\_\_\_\_

Plans Submitted: Yes  No  Calculations Submitted: Yes  No  Sewer Fee Req'd. Yes  No

CONTRACTOR: CHISM HOMES, INC. STATE LICENSE # 7834 CITY LICENSE # 11466

ADD'L. PERMITS REQ'D: Air Cond.  Elec.  Plumbing  Signs  Paving  Fence  Public Walks  Curb-gutters   
Incinerators  Fire Sprinkling System

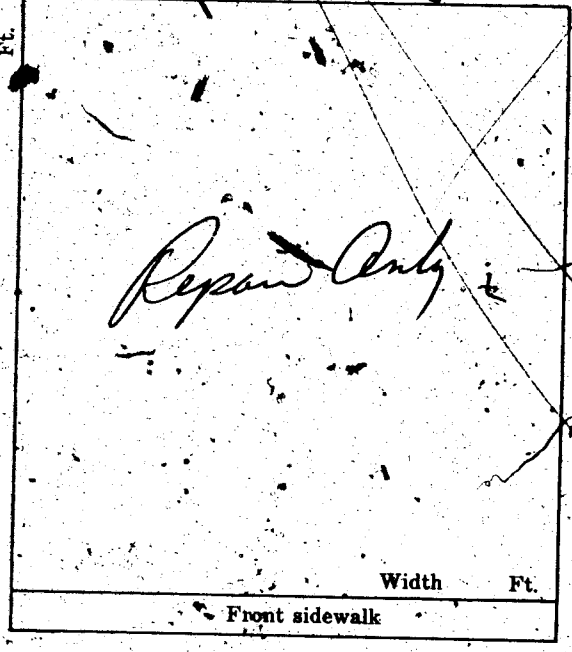

CONDITIONS OF THE PERMIT:

1. I agree to call the City Building Department for inspections before concrete is poured, before rough wiring, electrical, plumbing, framing is covered. Also for Air conditioning, sheet-rock and sheathing inspection.
2. I agree that when the job is completed that I will call for final inspection before occupancy.
3. I agree to perform all construction in accordance with City Ordinances and Building Codes.
4. The Contractor's signature below denotes authority from the owner to sign in his behalf and that the owner is aware of all requirements of this application and permit. Separate permits must be taken out for work outlined above this agreement.
5. I have read and understand the contents of this application and permit; I hereby state that the information I have supplied on this application is true and correct.

SIGNED: Christina Garcia Contractor

BY: [Signature] Agent or Owner

CLARK COUNTY HEALTH DEPT. \_\_\_\_\_ Date \_\_\_\_\_

LAS VEGAS FIRE DEPARTMENT \_\_\_\_\_ Date \_\_\_\_\_

PLANNING DEPT: [Signature] Date: 3/28/67

ENGINEERING DEPT: \_\_\_\_\_ Date: \_\_\_\_\_

BUILDING DEPT: John Replege Date: 3-28-67

#1285 PERMIT NO: 36638 PERMIT FEE \$ 4.00

RECEIPT  
450 \$004.00 - 8  
CITY OF LAS VEGAS  
DEPT. OF BUILDING & SAFETY  
MUST BE MACHINE VALIDATED  
28 MAR 67

*Done Jan 2, 1979*

CITY OF LAS VEGAS, NEVADA  
DEPARTMENT OF BUILDING & SAFETY

PERMIT FEE \$ 4  
APPLICATION & PERMIT FOR  
PLUMBING

JOB ADDRESS: 4816 ARAWANA

OWNER'S NAME: F.H.A. RENAR

LOT      BLOCK      SUBDIVISION      Bldg. type: SFD APT COMM

Circle: New bldg; Old bldg; Add'n; Remodel; Pool; Wtr. Sftner; Lawn Sprkr; Other

CONTRACTOR: RAY PLUMBING CO.

State Lic.# 6025 City Lic.# 8056

QUANTITY	FIXTURE OR INSTALLATION	Unit Price	AMOUNT
	Bathtub	1.00	
	Clothes dryer (gas)	1.00	
	Clothes washer	1.00	
	Dental unit	1.00	
	Dishwasher	1.00	
	Drinking fountain	1.00	
	Fire sprinkling - underground piping	5.00	
	Fire sprinkling - distribution piping per each foot	.01	
	Fire sprinkling heads - per each head	.10	
	Floor drain \$1.00 Floor sink	1.00	
	Gas appliance (any type)	1.00	
	Gas piping system - single family dwelling	3.00	
	Gas piping system - multiple family \$3 per each unit plus	1.00	
	Gas piping system - commercial bldg. per each floor	3.00	
	Grease trap	1.00	
	Irrigation system	4.00	
	Lavatory	1.00	
	Minimum fee for any permit	4.00	
	Piping, Drainage	4.00	
	Sewer replacement	4.00	
	Septic disposal system - Health Dept. approval required	4.00	
	Shower	1.00	
	Sink - kitchen type	1.00	
	Swimming pool - private - wading pool	8.00	
	Swimming pool - public - semi-public	12.00	
	Toilet	1.00	
	Urinal	1.00	
	Water distribution system, single family dwelling	4.00	
	Water distribution system multiple dwg. \$4 + each unit	1.00	
	Water distribution system, Group "A" thru "G" per each floor	4.00	
	Water distribution system, Group "H" (hotel) \$4 + per bath*	.50	
<u>1</u>	Water heater (gas) (electric)	1.00	<u>1.00</u>
	Water using equipment	1.00	
	Water softener nonpermanent type	4.00	
	Water softener permanent (connected to drainage)	5.00	
	Wash tray	1.00	

TOTAL FEE \$ 4.00

I hereby certify that I have carefully examined & read the above application; that the same is true & correct; and the work herein described is to be done in accordance with the provisions of City of Las Vegas Ordinances & State Laws, whether herein specified or not. \* As defined in City Code and Ordinances.

SIGNED: Troy A Ray Date: 3-31-67  
Registered Plumber, Spec. Contr., Owner

Engineering Dept. Date Building Department Date

Sewer Conn. Fees      PERMIT NO 20784 PERMIT FEE \$ 4

Paid in Engr. Dept. 23.10 #1287

RECEIPT  
662 \$004.00 - 7

CITY OF LAS VEGAS  
DEPT. OF BUILDING & SAFETY

Must be machine validated.  
- 5 APR 67

Done 4/13/73, 1973

# CITY OF LAS VEGAS, NEVADA

Job #1109

## DEPARTMENT OF BUILDING & SAFETY - ELECTRICAL APPLICATION & PERMIT

ADDRESS OF CONSTRUCTION: 4816 Apawana

OWNER'S NAME: James McNamee

CIRCLE:  New Bldg.;  Add'n.;  Remodel; TYPE OF BLDG.: SFD APT. PUBLIC COMM.

CONTRACTOR'S NAME: ELECTRIC CONSTRUCTION COMPANY

STATE LICENSE # 9383

CITY LICENSE # 2193

NUMBER	FIXTURE OR INSTALLATION	UNIT PRICE	TOTAL
	Rm addition, carport or garage enclosure	4.00	
	Temporary power	4.00	
	Light, receptacle or switch outlet	.20	
	Wall or ceiling space heater	.35	
	Garbage grinder outlet	.35	
	Dishwasher outlet	.35	
	Clothes dryer outlet	.35	
	Automatic clothes washer	.25	
	Electric range outlet	.35	
	Electric water heater outlet	.35	
	Special purpose outlet	.35	
	X-ray unit and its appurtenances	5.00	
	Watts of festoon lighting (Watts) First 3,000 watts for each additional thousand watts	4.00 1.50	
	Horsepower each motor first horsepower or less for each additional horsepower	2.75 .85	
	Electric service (including any single meter socket) for each additional socket	3.00 .35	
	Air conditioning service	1.50	1.50
	Each KW(KVA) Generator (Transformer, Welder) First 100 KVA for each additional KW(KVA)	2.00 .01	
	Speaker, signal or alarm outlet	.15	
	Amplifiers	.50	
	Control panels	.25	
	Main control racks	1.00	
	T.V. and radio antennas-master system only	.75	
	Minimum fee for any permit.	4.00	4.00
	<b>TOTAL FEE</b>		<b>4.00</b>

Approval for the work under this permit will be given only after repairs and debris have been removed from job site and public part of way.

I hereby certify that I have carefully examined and read the above application; that the same is true and correct, and that the work herein described is to be done in accordance with all the provisions of the applicable Ordinances of the City of Las Vegas, Nevada and State laws whether herein specified or not.

SIGNED [Signature] #69 MASTER (ELECTRICIAN) [Signature]

DATE 4-16-73

BUILDING DEPARTMENT [Signature]

DATE

#12860 PERMIT NO. 6132

PERMIT FEE: \$ 4.00

RECEIPT  
 #615 \$0:04.00 - 6  
 CITY OF LAS VEGAS  
 DEPT. OF BUILDING & SAFETY  
 MUST BE MACHINE VALIDATED  
 18 APR 73

4/20/73

4

# CITY OF LAS VEGAS, NEVADA DEPARTMENT OF BUILDING & SAFETY — AIR CONDITIONING APPLICATION & PERMIT

ADDRESS OF CONSTRUCTION: 4816 Apawana OWNER'S NAME: Mr. Kamey

CIRCLE: Addition, Remodel, New Bldg; TYPE OF BLDG.:  SFD  APT.  COMM.  PUBLIC

CONTRACTOR'S NAME: Robert S. A-C STATE LICENSE: 9723 CITY LICENSE: 0953E

UNITS	DESCRIPTION	FEE	TOTAL	UNITS	DESCRIPTION	FEE	TOTAL
	Unit heater — floor, wall or suspended	4.00			<b>EVAPORATIVE COOLERS:</b>		
FOR EACH FORCED-AIR OR GRAVITY-TYPE FURNACE OR BURNER INCLUDING DUCTS AND VENT ATTACHED TO SUCH APPLIANCES:					5 outlets or under	3.00	
	Up to and including 100,000 B.t.u.'s	4.00		Over 5 and up to and including 10	5.00		
	Over 100,000 B.t.u.'s	6.00		Each additional outlet over 10	.25		
FOR EACH HEATING APPLICATION, REFRIGERATION UNIT, COMFORT COOLING AND HEATING UNIT, ABSORPTION UNIT, COMPRESSOR OR BOILER:					<b>VENTILATION:</b>		
	Up to and including 3 ton or horsepower, or absorption system up to and including 100,000 B.t.u.'s	4.00	4.00	For each fan connected to a single duct	1.00		
	Over 3 ton or 3 horsepower up to and including 10, or absorption system over 100,000 B.t.u.'s up to and including 250,000 B.t.u.'s	7.00		For each commercial or industrial ventilation system	5.00		
	Over 10 ton or 10 horsepower up to and including 30, or absorption system over 250,000 B.t.u.'s up to and including 1,000,000 B.t.u.'s	12.00		For each commercial kitchen hood	5.00		
	Over 30 ton or 30 horsepower up to and including 50, or absorption system over 1,000,000 B.t.u.'s up to and including 1,700,000 B.t.u.'s	20.00		<b>MISCELLANEOUS:</b>			
	Over 50 ton or 50 horsepower, or absorption system over 1,700,000 B.t.u.'s	30.00		For each water cooling tower	1.00		
FOR EACH AIR HANDLING UNIT INCLUDING DUCTS ATTACHED THERETO:					Duct work only — each opening	.25	
	Up to and including 10,000 CFM	4.00		For installation or relocation of each commercial or industrial incinerator	15.00		
	Over 10,000 CFM	4.50		Gas piping related to the air cond. work in single family dwelling only	3.00		
					For each appliance, piece of equipment, any mechanical work or alteration or replacement not included in this schedule, the permit fee shall be computed the same as building permit fees by using the cost of installation for the valuation amount.		
				FOR THE ISSUANCE OF EACH PERMIT			
				TOTAL PERMIT FEE \$ <u>200</u>			

I hereby certify that I have carefully examined and read the above application; that the same is true and correct; and that the work herein described is to be done in accordance with all the provisions of the applicable Ordinances of the City of Las Vegas, Nevada and the State Laws, whether herein specified or not.

SIGNED: [Signature] Date: 4-20-73  
Air Conditioning Contractor - Owner

BUILDING DEPARTMENT: [Signature] Date: 4-23-73

PERMIT NO. 3654 PERMIT FEE \$ 200

RECEIPT  
\$007.00 - 4  
CITY OF LAS VEGAS  
DEPT. OF BUILDING & SAFETY  
MUST BE MACHINE VALIDATED  
23 APR 73

Done January, 1979

CITY OF LAS VEGAS, NEVADA  
Department of Building and Safety

# CERTIFICATE OF INSPECTION

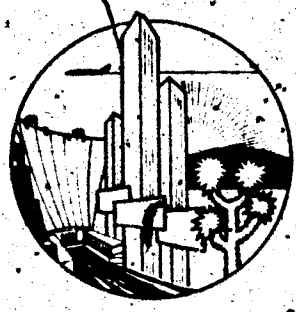

Address 4816 Apawana Owner J B Mc Kamey  
Legal Lot 4 block 12 Date 7-22-76  
Halfridge #5

This certificate issued pursuant to the requirements of Section 306 of the UNIFORM BUILDING CODE certifying that at the time of this issuance the improvements on this property were in compliance with CITY OF LAS VEGAS, HOUSING, BUILDING, ELECTRICAL, PLUMBING and MECHANICAL CODES

DIRECTOR  
Department of Building & Safety

*by William R. Fitzgerald*

This Certificate does not include conditions subject to normal maintenance.

RECEIPT  
Must be machine validated.  
*Paid 7/21/76*  
*WRT*

No. 241041

Fee \$ 10.00

12850

*2007*

Done Jan 2, 1979

3418

### CITY OF LAS VEGAS, NEVADA

LOG NO. & AREA \_\_\_\_\_ CONST. VAL. \$ 630  
DEPARTMENT OF BUILDING & SAFETY APPLICATION & BUILDING PERMIT — for:

ADDRESS OF CONSTRUCTION: 4816 Apawena OWNER: J. B. McNamey  
Dwellings, Duplexes, Misc. Residential Const.

LOT(s) 4 BLOCK 12 SUBDIVISION Selfridge #5 ZONE \_\_\_\_\_

Existing structure on lot: Dwelling  Accessory bldgs.  Vacant lot  Other

PROPOSED CONSTRUCTION: Metal Patio Cover + Deck 10x18 USE: \_\_\_\_\_

MATERIALS OF CONSTRUCTION: Wood Frame  Concrete Block  Reinforced Concrete  Steel Frame

SQ. FEET OF FLOOR AREAS: 1st 1 2nd \_\_\_\_\_ 3rd \_\_\_\_\_ Other \_\_\_\_\_ TOTAL SQ. FT. 180

FIRE ZONE: 1 2 3 \_\_\_\_\_ Occupancy Group 1 J 1a 2 \_\_\_\_\_ CONST. TYPE I II III IV V \_\_\_\_\_

ARCHITECT: \_\_\_\_\_ ENGINEER: \_\_\_\_\_ NO. of UNITS \_\_\_\_\_ NO. of STORIES \_\_\_\_\_

Plans Submitted: Yes  No  Calculations Submitted Yes  No  Sewer Fee Req'd. Yes  No

CONTRACTOR: Owner STATE LICENSE # \_\_\_\_\_ CITY LICENSE # \_\_\_\_\_

ADD'L. PERMITS REQ'D: Air Cond.  Elec.  Plumbing  Signs  Paving  Fence  Public Walks  Curb-gutters   
Incinerators  Fire Sprinkling System

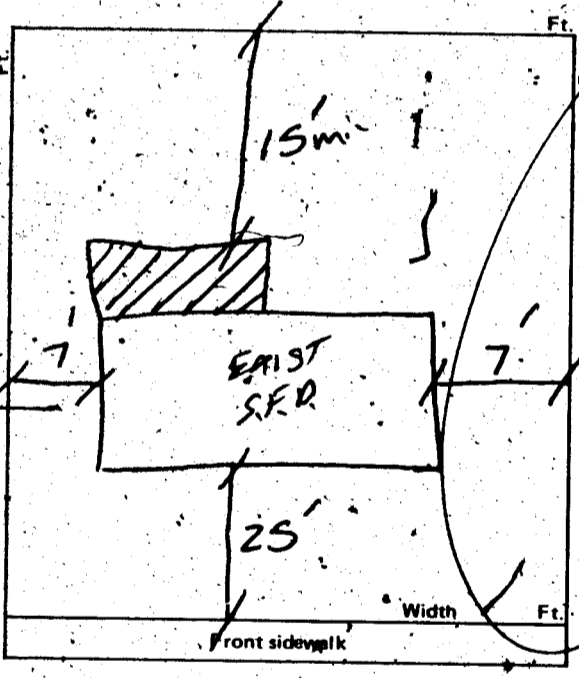

#### CONDITIONS OF THE PERMIT:

1. I agree to call the City Building Department for inspections before concrete is poured, before rough wiring, electrical, plumbing, framing is covered. Also for air conditioning, sheet-rock and sheathing inspection.
2. I agree that when the job is completed that I will call for final inspection before occupancy.
3. I agree to perform all construction in accordance with City Ordinances and Building Codes.
4. The Contractor's signature below denotes authority from the owner to sign in his behalf and that the owner is aware of all requirements of this application and permit. Separate permits must be taken out for work outlined above this agreement.
5. I have read and understand the contents of this application and permit; I hereby state that the information I have supplied on this application is true and correct.

Approval for the work under this permit will be given only after refuse and debris have been removed from job site and public right of way.

SIGNED: \_\_\_\_\_ Contractor  
BY: Phyllis McNamey Agent or Owner

CLARK COUNTY HEALTH DEPT. \_\_\_\_\_ Date \_\_\_\_\_  
LAS VEGAS FIRE DEPARTMENT \_\_\_\_\_ Date \_\_\_\_\_

PLANNING DEPT.: \_\_\_\_\_ Date: 7/22/76  
PUBLIC WORKS DEPT.: \_\_\_\_\_ Date: \_\_\_\_\_  
BUILDING DEPT.: lc Date: 7-23-76  
PERMIT NO.: 3804 PERMIT FEE \$ 900

RECEIPT  
5207 \$009.00 - 8  
CITY OF LAS VEGAS  
BUILDING & SAFETY  
MUST BE MACHINE VALIDATED  
7/23/76

Torres - Kynok - 11-12-80.

DEPT. of BLDG & SAFETY - CITY of LAS VEGAS, NEVADA

OWNER FHA ADDRESS 4816 Apawana Lane DATE 3/28/67  
 GEN CONT. Chism Homes Inc TYPE OF STRUCTURE Rehab  
 PERMIT NO. 36638 LEGAL DESCRIPTION 1 1/2 B-12 Golfridge Terrace #5

BUILDING	MECHANICAL	ELECTRICAL
LOCATION	PLUMBING CONT. <u>Ray Plumb</u>	TEMP. POLE CONT.
FIREPLACE FTG.	PERMIT NO. <u>20784</u> DATE <u>3-67</u>	PERMIT NO. _____ DATE _____
FOOTINGS	HEAT & VENT. A/C CONT.	INSPECTION _____ DATE _____
FOUNDATION WALL	PERMIT NO. _____ DATE _____	ELECTRICAL CONT.
FLOOR FRAMING	SEWER CONT.	PERMIT NO. _____ DATE _____
SLAB	PERMIT NO. _____ DATE _____	FIXTURES CONT.
CHIMNEY STEEL (FIREPLACE)	ROUGH SOIL	PERMIT NO. _____ DATE _____
WALL STEEL	ROUGH WATER	SLAB
COLUMN STEEL	TOP-OUT	ROUGH
BEAM STEEL	ROUGH GAS	FINAL ROUGH
FRAMING	A/C ROUGH DUCT	FINAL FIXTURE
ROOF SHEATHING	REF. ROUGH PIPING	FINAL ELECTRICAL
INTERIOR	FINAL PLUMBING <u>WEP 4-4-67 4-13-67</u>	TEMPORARY SERVICE
DRYWALL	FINAL GAS	MISCELLANEOUS
LATHING	FINAL AIR COND.	GRADING & DRAINAGE
BACKING (SIDS)	FINAL REFRIG.	ON-SITE PARKING SPACES _____ APP. _____
PLASTER SCRATCH	FINAL SEWER	ENG. APPROVAL OF _____
PLASTER BROWN	FINAL SEPTIC TANK	OFF-SITE IMPROVEMENTS
URBAN REDEVELOPMENT APPROVAL		
FINAL BLDG. <u>John</u> DATE <u>4-15-67</u>		

APPROVED FOR OCCUPANCY & METER \_\_\_\_\_ INSPECTOR \_\_\_\_\_ DATE \_\_\_\_\_

PLEASE NOTE REMARKS ON REVERSE SIDE 4816 Apawana Lane LOG # \_\_\_\_\_ AREA # \_\_\_\_\_ 23.04

DEPT. of BLDG & SAFETY - CITY of LAS VEGAS, NEVADA

OWNER J. B. McKamey ADDRESS 4816 Apawana DATE 7-23-76  
 GEN CONT. owner TYPE OF STRUCTURE metal patio cover/slab  
 PERMIT NO. 3804 LEGAL DESCRIPTION lot 4, block 12, Golfridge #5 (certification)

BUILDING	MECHANICAL	ELECTRICAL
Investigation	Plumbing Cont.	Temp. pole cont.
Location & Footing	Permit No. _____ Date _____	Permit No. _____ Date _____
Stem Wall	Heat & Vent. A/C Cont.	Inspection _____ Date _____
Concrete Slab Floor	Permit No. _____ Date _____	Electrical Cont.
Floor Framing	Sewer Cont.	Permit No. _____ Date _____
Fireplace Footing	Permit No. _____ Date _____	Fixtures Cont.
Chimney Steel	Rough Soil	Permit No. _____ Date _____
Vert. Steel Reinf.	Rough Water	Slab
Horiz. Steel Reinf.	Top-Out	Rough
Roof Sheathing	Rough Gas	Final Rough
Framing	A/C Rough Duct	Final Fixture
Backing for siding	Ref. Rough Piping	Final Electrical
Ext. Lath	Final Plumbing	Temporary Service
Ext. Scratch	Final Gas	MISCELLANEOUS
Ext. Brown	Final Air Cond.	Grading & Drainage
Int. Lath	Final Refrig.	On-Site Parking Spaces _____ App. _____
Int. Brown	Final Sewer	Eng. Approval of _____
Drywall	Final Septic Tank	Off-Site Improvements
Permit No.		
Final Building		
Appr. for Occu.		

INSPECTOR: \_\_\_\_\_ DATE \_\_\_\_\_

APPROVED FOR OCCUPANCY & METER \_\_\_\_\_

PLEASE NOTE REMARKS ON REVERSE SIDE 4816 Apawana LOG # \_\_\_\_\_ AREA # \_\_\_\_\_

*Thomas K. Quaker 11-12-80*

DEPT. OF BLDG. & SAFETY - CITY OF LAS VEGAS, NEVADA

OWNER: MIRANTT INVEST. CO. ADDRESS: 4816 APAWANA DATE: 1-20-61

GEN. CONT. MIRANTT CONST. CO. TYPE OF STRUCTURE DWELLING

PERMIT NO. 2824 LEGAL DESCRIPTION: Lot 1, Blk. 12, Golfridge #5

LOCATION & FLOOR ELEVATION	PLUMBING CONT. <u>Special</u>	TEMP. HOLE CONT.
FOOTINGS <u>2-2-61</u>	PERMIT NO. <u>1999</u> DATE <u>2-17-61</u>	PERMIT NO. _____ DATE _____
FOUND. & PIERS <u>2-8-61</u>	HEAT & VENT. CONT. <u>187</u>	INSPECTION _____ DATE _____
WALL STEEL	PERMIT NO. <u>1577</u> DATE <u>2-20-61</u>	ELECTRICAL CONT. <u>1889</u>
BOND BEAM STEEL	SEWER CONT. <u>1999</u>	PERMIT NO. <u>1889</u> DATE <u>1-20-61</u>
FRAMING & ROOF SHEATHING	PERMIT NO. <u>1999</u> DATE <u>2-17-61</u>	OUTLETS <u>54</u>
STEEL FABRICATION	ROUGH SOIL <u>2-15-61</u>	MOTORS _____ N.P.
CONNECTIONS & PAINTING	ROUGH WATER <u>2-15-61</u>	SLAB _____
LATHING	SEWER OR SEPTIC TANK <u>2-20-61</u>	ROUGH _____
PLASTER	TOP-OUT <u>3-5-61</u>	FINAL ROUGH _____
SCRATCH	ROUGH GAS <u>3-15-61</u>	FIXTURE CONT. <u>Special</u>
BROWN	ROUGH DUCT <u>3-24-61</u>	PERMIT NO. <u>1387</u> DATE <u>1-20-61</u>
FINAL BLDG. <u>5-24-61</u>	FINAL PLUMBING <u>Call 15-31-61</u>	FIXTURES <u>13</u>
GRADING & DRAINAGE	FINAL HEATING <u>Call 6/14/61</u>	FINAL FIXTURE _____
ON-SITE PARKING SPACES	FINAL GAS <u>Call 7-31-61</u>	APPROVED FOR METER: <u>16-02-61</u>
ENG. APPROVAL OF OFF-SITE IMPROVEMENTS		

APPROVED FOR OCCUPANCY: Carling 5-24-61 INSPECTOR DATE

\* PLEASE NOTE REMARKS ON REVERSE SIDE  
 4816 APAWANA DWELLING - 1-20-61 LOG: # T-4 Area: # 3 23.04

Department of Building & Safety City of Las Vegas, Nevada Special Kardex Elec. only, Plbg. only, A.C. only

Owner James McKamey Address 4816 Apawana Date: 4/18/73  
 Contractor \_\_\_\_\_ Permit No. \_\_\_\_\_  
 Lot \_\_\_\_\_ Block \_\_\_\_\_ Subdivision \_\_\_\_\_

Electric Only	Plumbing Only	Heat & Vent. A. C. Only
Contractor <u>Elec Const</u>	Contractor _____	Contractor <u>Callers</u>
Permit No. <u>6132</u>	Permit No. _____	Permit No. <u>3657</u>
Slab _____	Rough Soil _____	A.C. Rough Duct _____
Rough Elect _____	Rough Water _____	Ref. Ro. Piping _____
Final Rough _____	Top Out _____	Rough Gas _____
Final Fixture _____	Rough Gas _____	Final Refrig _____
Final Elec _____	Final Plbg. _____	Final Air Cond <u>2-14-73</u>
Temp. Service _____	Final Gas _____	Final Gas _____
	Final Sewer _____	
	Final Septic Tank _____	

23.06.D Address 4816 Apawana AC Service Log No. \_\_\_\_\_ Area \_\_\_\_\_