

113 Breeze Court

LOT 39 BLK 5 CHARLESTON RAINBOW #12-B ZONE R-1

H. Gatewood 1-30-79

CITY OF LAS VEGAS, NEVADA

LOG NO. & AREA T22-3 DEPARTMENT OF BUILDING & SAFETY CONST. VAL. \$ 27552
APPLICATION & BUILDING PERMIT — for:
Dwellings, Duplexes, Misc. Residential Const.

ADDRESS OF CONSTRUCTION: 113 Breeze Court OWNER: Sproul Homes of Nevada

LOT(s) 39 BLOCK 5 SUBDIVISION Charleston Rainbow Unit No. 12-B ZONE: R-1

Existing structure on lot: Dwelling Accessory bldg. Vacant lot Other
PROPOSED CONSTRUCTION: Single Family Dwelling USE: Same

MATERIALS OF CONSTRUCTION: Wood Frame Concrete Block Reinforced Concrete Steel Frame

SQ. FEET OF FLOOR AREAS: 1st 482 2nd 480 3rd 0 Other 0 TOTAL SQ. FT. 1962

FIRE ZONE: 1-2 Occupancy Group 1-J-2 CONST. TYPE I II III IV V

ARCHITECT: _____ ENGINEER: _____ NO. of UNITS: _____ NO. of STORIES: 1

Plans Submitted: Yes No Calculations Submitted: Yes No Sewer Fee Req'd. Yes No

CONTRACTOR: Sproul Homes of Nevada STATE LICENSE # 6011B CITY LICENSE # 6427

ADD'L. PERMITS REQ'D: Air Cond. Incinerators Elec. Fire Sprinkling System Plumbing Signs Paving Fence Public Walks Curb-gutters

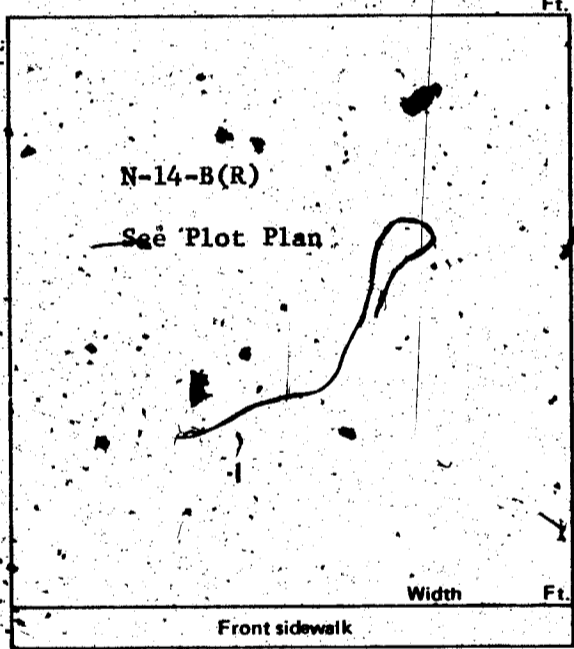

CONDITIONS OF THE PERMIT:

1. I agree to call the City Building Department for inspections before concrete is poured, before rough wiring, electrical, plumbing, framing is covered. Also for air conditioning, sheet-rock and sheathing inspection.
2. I agree that when the job is completed that I will call for final inspection before occupancy.
3. I agree to perform all construction in accordance with City Ordinances and Building Codes.
4. The Contractor's signature below denotes authority from the owner to sign in his behalf and that the owner is aware of all requirements of this application and permit. Separate permits must be taken out for work outlined above this agreement.
5. I have read and understand the contents of this application and permit; I hereby state that the information I have supplied on this application is true and correct.

Approval for the work under this permit will be given only after refuse and debris have been removed from job site and public right of way.

SIGNED: SPROUL HOMES OF NEVADA Contractor

BY: John E. [Signature] Agent or Owner

CLARK COUNTY HEALTH DEPT. _____ Date _____

LAS VEGAS FIRE DEPARTMENT _____ Date _____

PLANNING DEPT.: [Signature] Date: 12/22/75

PUBLIC WORKS DEPT.: [Signature] Date: 12-22

BUILDING DEPT.: [Signature] Date: 12/22/75

12850 PERMIT NO.: 5427 PERMIT FEE \$ 107.00

RECEIPT
4942 \$107.00 - 8

CITY OF LAS VEGAS
DEPT. OF BUILDING & SAFETY

MUST BE MACHINE VALIDATED
- 5-20-78

H. Gatewood 1-30-79

CITY OF LAS VEGAS, NEVADA
DEPARTMENT OF BUILDING & SAFETY

RECEIPT
FOR
SEWER CONNECTION FEE

JOB ADDRESS: 113 Breeze Court OWNER'S NAME: Sproul Homes of Nevada
LOT 39 BLOCK 5 SUBDIVISION Charleston Rainbow Unit No. 12-B

QUANTITY	OCCUPANCY	UNIT FEE	AMOUNT
1	Sewer Connection Fee for SFD		\$150.00

PAID BY: Sproul Homes of Nev

TOTAL	\$150.00
Less Credit	
TOTAL FEE	150.00

*Credit for existing sewer is applied to the new sewer connection fee based on previous type of occupancy and only when the new occupancy requires an additional fee.

This receipt does not authorize the owner or his representative to start any work without obtaining a plumbing permit.

WRZ 1/27/75
 DEPARTMENT OF BUILDING & SAFETY DATE
 RECEIPT NO. 3314 SEWER FEE \$ 150.00

RECEIPT
 1976 \$150.00 - 3
 CITY OF LAS VEGAS
 DEPT. OF BUILDING & SAFETY
 MUST BE MACHINE VALIDATED

73102

H. Gatewood 1-30-79

CITY OF LAS VEGAS, NEVADA

DEPARTMENT OF BUILDING & SAFETY - ELECTRICAL APPLICATION & PERMIT

ADDRESS OF CONSTRUCTION: 113 Breeze Court

OWNER'S NAME: Sprout

CIRCLE: New Bldg.; Add'n.; Remodel; TYPE OF BLDG.: SEC. APT. PUBLIC COMM.

CONTRACTOR'S NAME: Roberts Electric

STATE LICENSE # 4582

CITY LICENSE # 3392

NUMBER	FIXTURE OR INSTALLATION	UNIT PRICE	TOTAL
	Rm addition, carport or garage enclosure	4.00	
	Temporary power	4.00	
59	Light, receptacle or switch outlet	.28	11.80
	Wall or ceiling space heater	.35	
1	Garbage grinder outlet	.35	.35
	Dishwasher outlet	.35	
	Clothes dryer outlet	.35	
	Automatic clothes washer	.35	
1	Electric range outlet	.35	.35
	Electric water heater outlet	.35	
	Special purpose outlet	.35	
	X-ray unit and its appurtenances	5.00	
	Watts of festoon lighting (Watts) First 3,000 watts for each additional thousand watts	4.00 1.50	
	Horsepower each motor first horsepower or less for each additional horsepower	1.75 .35	
1	Electric service (including any single meter socket) for each additional socket	3.00 .35	3.00
1	Air conditioning service	1.50	1.50
	Each KW(KVA) Generator (Transformer, Welder) First 100 KW for each additional KW(KVA)	2.00 .01	
	Speaker, signal or alarm outlet	.15	
	Amplifiers	.50	
	Control panels	.25	
	Main control racks	1.00	
	T.V. and radio antennas-master system only	.75	
	Minimum fee for any permit	4.00	
	TOTAL FEE		17.00

Approval for the work under this permit will be given only after refuse and debris have been removed from job site and public right of way.

I hereby certify that I have carefully examined and read the above application; that the same is true and correct; and that the work herein described is to be done in accordance with all the provisions of the applicable Ordinances of the City of Las Vegas, Nevada and State laws whether herein specified or not.

SIGNED: G. D. Waugh
MASTER (ELECTRICIAN) (TECHNICIAN) (OWNER)

DATE

BUILDING DEPARTMENT LA

DATE 1-12-76

#12860

PERMIT NO. 79

PERMIT FEE: \$ 17.00

RECEIPT

5335 \$017.00 - 6

CITY OF LAS VEGAS
DEPT. OF BUILDING & SAFETY

MUST BE MACHINE VALIDATED

JAN 26 1976

H. Gatewood 1-80-79

CITY OF LAS VEGAS, NEVADA

39-5

DEPARTMENT OF BUILDING & SAFETY - APPLICATION AND PERMIT FOR PLUMBING

ADDRESS OF CONSTRUCTION: 113 BREEZE COURT OWNER'S NAME: SPRAWL HOMES INC.

CIRCLE: New Bldg. Add'n.; Remodel; TYPE OF BLDG. SFD APT. PUBLIC COMM.

CONTRACTOR'S NAME: UNITED PLUMBING STATE LICENSE # 1295 CITY LICENSE # 904

UNITS	DESCRIPTION	FEE	TOTAL
1	Bathtub	1.00	1-
1	Shower	1.00	1-
3	Lavatory	1.00	3-
2	Toilet	1.00	2-
	Urinal	1.00	
	Floor Drain	1.00	
	Floor Sink	1.00	
	Wash Tray	1.00	
1	Sink	1.00	15
	Garbage Disposal	1.00	
	Garbage Disposal (comm.)	3.00	
	Clothes Dryer (gas)	1.00	
1	Clothes Washer	1.00	1-
	Clothes Washer (comm.)	5.00	
	Dishwasher	1.00	
	Dishwasher (commercial)	5.00	
	Dental Unit	10.00	
	Drinking Fountain	1.00	
	Any Water using Equipment	1.00	
1	Water Heater (gas) (elect.)	1.00	1-
1	Sewer System—New, Replacement, or any Drainage System	4.00	4-
	Grease or Sand Trap	2.00	
	Trailer Trap	2.00	
	Septic Disposal System	4.00	
WATER SOFTENERS			
	Nonpermanent Type	4.00	
	Permanent Type (connected to Drainage)	5.00	
SWIMMING POOLS			
	Private or Wading Pool	10.00	
	Public or Semi-public	20.00	

UNITS	DESCRIPTION	FEE	TOTAL
WATER-DISTRIBUTION SYSTEM			
1	Single Family Dwelling	4.00	4-
	Multiple Family Dwelling plus each unit	4.00 2.00	
	Bldg. Group "A" thru "G" per each floor	6.00	
	Hotel or Motel plus each bath	4.00 1.50	
	Trailer Park plus each space	20.00 1.00	
	Irrigation	4.00	
GAS PIPING SYSTEM			
1	Single Family Dwelling	3.00	3-
	Multiple Family Dwelling plus each unit	6.00 1.00	
	Commercial Bldg. per floor plus each unit	3.00 3.00	
	Gas Appliance (any type)	1.00	
AUTOMATIC FIRE EXTINGUISHING SYSTEM			
	Underground Piping	10.00	
	Distribution Piping ea. ft.	.01	
	Sprinkler Head each	.10	
	In Range Hood and Vent	5.00	
DRY STANDPIPE SYSTEM			
	Piping	50.00	
	Each Outlet	1.00	
WET STANDPIPE SYSTEM			
	Piping	5.00	
	Fire Hose Cabinet	1.00	
	MINIMUM PERMIT FEE	4.00	
PIPELINE CONTRACTOR; SECT. 14-B.P.F. \$			
TOTAL PERMIT FEE \$ 21-			

I hereby certify that I have carefully examined and read the above application; that the same is true and correct; and that the work herein described is to be done in accordance with all the provisions of the applicable Ordinances of the City of Las Vegas, Nevada and the State Laws, whether herein specified or not.

Approval for the work under this permit will be given only after refuse and debris have been removed from job site and public right of way.

Signed: *J. J. Davis* Date: 1-5-76
Registered Master Plumber, Spec. Cont'r. of Owner

Building Department: *N. Miller* Date: 1-13-76

Permit No. 123 Permit Fee \$ 21

#12870

RECEIPT
5437 \$021.00 - 7
CITY OF LAS VEGAS
BUILDING & SAFETY
MUST BE MACHINE VALIDATED
13 JAN 76

D. Gatewood 1-30-79

CITY OF LAS VEGAS, NEVADA

DEPARTMENT OF BUILDING & SAFETY - AIR CONDITIONING APPLICATION & PERMIT

ADDRESS OF CONSTRUCTION: 113 Breeze Court OWNER'S NAME: Sprout Homes

CIRCLE: Addition, Remodel, New Bldg. TYPE OF BLDG.: SFD APT. COMM. PUBLIC

CONTRACTOR'S NAME: Gearing Air Conditioning STATE LICENSE # 6058 CITY LICENSE # 7618

UNITS	DESCRIPTION	FEE	TOTAL	UNITS	DESCRIPTION	FEE	TOTAL
	Unit heater - floor, wall or suspended	4.00			EVAPORATIVE COOLERS:		
	FOR EACH FORCED-AIR OR GRAVITY-TYPE FURNACE OR BURNER INCLUDING DUCTS AND VENT ATTACHED TO SUCH APPLIANCES:				5 outlets or under	3.00	
	Up to and including 100,000 B.t.u.'s	4.00			Over 5 and up to and including 10	5.00	
	Over 100,000 B.t.u.'s	6.00			Each additional outlet over 10	.25	
	FOR EACH HEATING APPLICATION, REFRIGERATION UNIT, COMFORT COOLING AND HEATING UNIT, ABSORPTION UNIT, COMPRESSOR OR BOILER:				VENTILATION:		
	Up to and including 3 ton or horsepower, or absorption system up to and including 100,000 B.t.u.'s	4.00		2	For each fan connected to a single duct	1.00	2.00
1	Over 3 ton or 3 horsepower up to and including 10, or absorption system over 100,000 B.t.u.'s up to and including 250,000 B.t.u.'s	7.00	7.00		For each commercial or industrial ventilation system	5.00	
	Over 10 ton or 10 horsepower up to and including 30, or absorption system over 250,000 B.t.u.'s up to and including 1,000,000 B.t.u.'s	12.00			For each commercial kitchen hood	5.00	
	Over 30 ton or 30 horsepower up to and including 50, or absorption system over 1,000,000 B.t.u.'s up to and including 1,700,000 B.t.u.'s	20.00			MISCELLANEOUS:		
	Over 50 ton or 50 horsepower, or absorption system over 1,700,000 B.t.u.'s	30.00			For each water cooling tower	3.00	
	FOR EACH AIR HANDLING UNIT INCLUDING DUCTS ATTACHED THERETO:				Duct work only - each opening	.25	
	Up to and including 10,000 CFM	2.00			For installation or relocation of each commercial or industrial incinerator	15.00	
	Over 10,000 CFM	4.00			Gas piping related to the air cond. work in single family dwelling only	3.00	
					For each appliance, piece of equipment, any mechanical work or alteration or replacement not included in this schedule, the permit fee shall be computed the same as building permit fees by using the cost of installation for the valuation amount.		
					FOR THE ISSUANCE OF EACH PERMIT		3.00
					TOTAL PERMIT FEE \$	12.00	

I hereby certify that I have carefully examined and read the above application; that the same is true and correct; and that the work herein described is to be done in accordance with all the provisions of the applicable Ordinances of the City of Las Vegas, Nevada and the State Laws, whether herein specified or not.

Approval for the work under this permit will be given only after refuse and debris have been removed from job site and public right of way.

SIGNED: [Signature] Date: 1-29-79
Air Conditioning Contractor - Own

BUILDING DEPARTMENT: RH Date: 2-2-79

PERMIT NO. 111 PERMIT FEE \$ 12.00

#12890

RECEIPT

6413 \$042.00 - 4

CITY OF LAS VEGAS
DEPT. OF BUILDING & SAFETY

MUST BE MACHINE VALIDATED

[Stamp]

DEPT. of BLDG. & SAFETY - CITY of LAS VEGAS, NEVADA

OWNER Sproul Homes ADDRESS 113 Breeze Court DATE 12-2-76
 GEN. CONT. Same TYPE OF STRUCTURE SFD
 PERMIT NO. 5427 LEGAL DESCRIPTION L 39 B 5 Charleston Rainbow Unit 12 B

BUILDING	MECHANICAL	ELECTRICAL
Investigation	Plumbing Cont. <u>United</u>	Temp. pole cont.
Location & Footing <u>BW 1-7-76</u>	Permit No. <u>123</u> Date <u>1-13-76</u>	Permit No. _____ Date _____
Stem Wall <u>BW 1-13-76</u>	Heat & Vent. A/C Cont. <u>Flowing</u>	Inspection _____ Date _____
Concrete Slab Floor <u>BW 1-20-76</u>	Permit No. <u>111</u> Date <u>2-2-76</u>	Electrical Cont. <u>Roberts</u>
Floor Framing	Sewer Cont. <u>Sproul Homes</u>	Permit No. <u>79</u> Date <u>1-12-76</u>
Fireplace Footing	Permit No. <u>3314</u> Date _____	Fixtures Cont. _____
Chimney Steel	Rough Soil <u>WEP 1-15-76</u>	Permit No. _____ Date _____
Vert. Steel Reinf.	Rough Water <u>WEP 1-13-76</u>	Slab _____
Horiz. Steel Reinf.	Top-Out <u>WEP 2-12-76</u>	Rough <u>AD 211-75</u>
Roof Sheathing <u>BW 2-11-76</u>	Rough Gas _____	Final Rough _____
Framing <u>BW 2-12-76</u>	A/C Rough Duct <u>WEP 2-13-76</u>	Final Fixtures _____
Backing for siding	Ref. Rough Piping _____	Final Electrical <u>F103-18-76</u>
Ext. Lath	Final Plumbing <u>WEP 3-17-76</u>	Temporary Service _____
Ext. Scratch	Final Gas <u>WEP 3-17-76</u>	MISCELLANEOUS
Ext. Brown	Final Air Cond. <u>WEP 3-18-76</u>	Grading & Drainage _____
Int. Lath	Final Refrig. _____	On-Site Parking Spaces _____ App. _____
Int. Brown	Final Sewer <u>WEP 2-11-76</u>	Eng. Approval of _____
Drywall <u>BW 2-25-76</u>	Final Septic Tank _____	Off-Site Improvements _____
Permit No. _____		
Final Building <u>BW 3-18-76</u>		
Appr. for Occu. _____		

INSPECTOR: _____

DATE _____

APPROVED FOR OCCUPANCY & METER _____

BW 3-18-76

PLEASE NOTE REMARKS ON REVERSE SIDE 113 Breeze Court

LOG # _____

AREA # _____

T 22-3