

210 Adams

Blor ealy 10-20-80

DEPT. of BLDG. & SAFETY - CITY of LAS VEGAS, NEVADA
OWNER: WILL REYNOLDS ADDRESS: 210 Adams St. DATE: 2-28-57-Reactivated
GEN. CONT. TED P. RICHARDS TYPE OF STRUCTURE DUPLEX
PERMIT NO. 28201 LEGAL DESCRIPTION: Lot 3 Bl. 16, Valley View Addn.

LOCATION & FLOOR ELEVATION	PLUMBING CONT. PERMIT NO. _____ DATE _____	TEMP. POLE CONT. PERMIT NO. _____ DATE _____
FOOTINGS	HEAT & VENT. CONT. PERMIT NO. _____ DATE _____	INSPECTION DATE _____
FOUND. & PIERS	SEWER CONT. PERMIT NO. _____ DATE _____	ELECTRICAL CONT. <u>Quinn</u> PERMIT NO. <u>21002</u> DATE <u>7/11/57</u>
WALL STEEL	ROUGH SOIL <u>water - 26849 7-23-57</u>	OUTLETS <u>50-2</u> MOTORS _____ H.P. _____
BOND BEAM STEEL	ROUGH WATER <u>7-9-57</u>	SLAB ROUGH _____
FRAMING & ROOF SHEATHING <u>7-22-57</u>	SEWER OR SEPTIC TANK <u>Sewer OK 7/4/57</u>	FINAL ROUGH <u>Quinn 7/24/57</u> <u>Quinn 7-23-57</u>
STEEL FABRICATION	TOP-OUT <u>Betty 7-22-57</u> <u>8-9-57 7-23-57</u>	FIXTURE CONT. PERMIT NO. _____ DATE _____
CONNECTIONS & PAINTING INTERIOR _____ EXTERIOR _____	ROUGH GAS _____	FIXTURES <u>10</u>
LATHING	ROUGH DUCT _____	FINAL FIXTURE _____
PLASTER SCRATCH _____ BROWN _____	FINAL PLUMBING <u>Betty 10-7-57</u>	APPROVED FOR METER <u>Quinn 9/23/57</u>
FINAL BLDG <u>Walter 10-8-57</u>	FINAL HEATING _____	
GRADING & DRAINAGE	FINAL GAS <u>Betty 10-7-57</u>	
ON-SITE PARKING _____ SPACES _____		
ENG APPROVAL OF OFF-SITE IMPROVEMENTS _____		

APPROVED FOR OCCUPANCY: _____ INSPECTOR _____ DATE _____
PLEASE NOTE REMARKS ON REVERSE SIDE 210 Adams St. - DUPLEX - REACTIVATED 2/28/57 23.04

DEPT. of BLDG & SAFETY - CITY of LAS VEGAS, NEVADA
OWNER: Willie Reynolds ADDRESS: 210 Adams DATE: 2-21-66
GEN CONT. Owner TYPE OF STRUCTURE demolish
PERMIT NO. 32343 LEGAL DESCRIPTION: Lot 3, 4 block 16 & re build

BUILDING	MECHANICAL	ELECTRICAL
LOCATION	PLUMBING CONT. PERMIT NO. _____ DATE _____	TEMP. POLE CONT. PERMIT NO. _____ DATE _____
FIREPLACE FTG.	HEAT & VENT. AC CONT. PERMIT NO. _____ DATE _____	INSPECTION DATE _____
FOOTINGS	SEWER CONT. PERMIT NO. _____ DATE _____	ELECTRICAL CONT. PERMIT NO. _____ DATE _____
FOUNDATION WALL	ROUGH SOIL	FIXTURES CONT. PERMIT NO. _____ DATE _____
FLOOR FRAMING	ROUGH WATER	SLAB _____
SLAB	TOP-OUT	ROUGH _____
CHIMNEY STEEL (FIREPLACE)	ROUGH GAS	FINAL ROUGH _____
WALL STEEL	AC ROUGH DUCT	FINAL FIXTURE _____
COLUMN STEEL	REF ROUGH PIPING	FINAL ELECTRICAL _____
BEAM STEEL	FINAL PLUMBING	TEMPORARY SERVICE _____
FRAMING	FINAL GAS	
ROOF SHEATHING INTERIOR _____ EXTERIOR _____	FINAL AIR COND.	
DRYWALL	FINAL REFRIG.	
LATHING	FINAL SEWER	
BACKING (SIDING)	FINAL SEPTIC TANK	
PLASTER SCRATCH _____ BROWN _____		
URBAN REDEVELOPMENT APPROVAL		
FINAL BLDG <u>3-16-66</u>		

APPROVED FOR OCCUPANCY & METER _____ INSPECTOR _____ DATE _____
PLEASE NOTE REMARKS ON REVERSE SIDE 210 Adams LOG: # _____ AREA: # _____ 23.04

Maria Ealy 10-20-80

7/2/57	Ben Simpson	Elder
7-12-57	Investigator	Batley

Gloria Ealy 10-20-80

DEPT. of BLDG. & SAFETY - CITY of LAS VEGAS, NEVADA

OWNER Willie Reynolds ADDRESS 210 W. Adams DATE 9-22-64
GEN. CONT. Same TYPE OF STRUCTURE remodel
PERMIT NO. 27865 LEGAL DESCRIPTION Lot 3-4 Blk 16 Valley View Add

BUILDING	MECHANICAL	ELECTRICAL
LOCATION	PLUMBING CONT.	TEMP. POLE CONT.
FIREPLACE FTG.	PERMIT NO. DATE	PERMIT NO. DATE
FOOTINGS	HEAT & VENT. AC CONT.	INSPECTION DATE
FOUNDATION WALL	PERMIT NO. DATE	ELECTRICAL CONT.
FLOOR FRAMING	SEWER CONT.	PERMIT NO. DATE
SLAB	PERMIT NO. DATE	FIXTURES CONT.
CHIMNEY STEEL (FIREPLACE)	ROUGH SOIL	PERMIT NO. DATE
WALL STEEL	ROUGH WATER	SLAB
COLUMN STEEL	TOP-OUT	ROUGH
BEAM STEEL	ROUGH GAS	FINAL ROUGH
FRAMING	AC ROUGH DUCT	FINAL FIXTURE
ROOF SHEATHING	REF ROUGH PIPING	FINAL ELECTRICAL
INTERIOR	FINAL PLUMBING	TEMPORARY SERVICE
EXTERIOR	FINAL GAS	MISCELLANEOUS
DRYWALL	FINAL AIR COND.	GRADING & DRAINAGE
LATHING	FINAL REFRIG.	ON-SITE PARKING SPACES
BACKING (SIDING)	FINAL SEWER	ENG. APPROVAL OF
PLASTER SCRATCH	FINAL SEPTIC TANK	OFF-SITE IMPROVEMENTS
BROWN		
URBAN REDEVELOPMENT APPROVAL		
FINAL BLDG. DATE 1-5-65		

INSPECTOR DATE

APPROVED FOR OCCUPANCY & METER

PLEASE NOTE REMARKS ON REVERSE SIDE

210 W. Adams

DEPT. of BLDG. & SAFETY - CITY of LAS VEGAS, NEVADA

OWNER W. Reynolds ADDRESS 210 Adams DATE 5-13-63
GEN. CONT. W. J. Chester TYPE OF STRUCTURE fence
PERMIT NO. 20029 LEGAL DESCRIPTION Lot 5 Block 16 H.E.M. & M.

BUILDING	MECHANICAL	ELECTRICAL
LOCATION	PLUMBING CONT.	TEMP. POLE CONT.
FIREPLACE FTG.	PERMIT NO. DATE	PERMIT NO. DATE
FOOTINGS	HEAT & VENT. AC CONT.	INSPECTION DATE
FOUNDATION WALL	PERMIT NO. DATE	ELECTRICAL CONT.
FLOOR FRAMING	SEWER CONT.	PERMIT NO. DATE
SLAB	PERMIT NO. DATE	FIXTURES CONT.
CHIMNEY STEEL (FIREPLACE)	ROUGH SOIL	PERMIT NO. DATE
WALL STEEL	ROUGH WATER	SLAB
COLUMN STEEL	TOP-OUT	ROUGH
BEAM STEEL	ROUGH GAS	FINAL ROUGH
FRAMING	AC ROUGH DUCT	FINAL FIXTURE
ROOF SHEATHING	REF ROUGH PIPING	FINAL ELECTRICAL
INTERIOR	FINAL PLUMBING	TEMPORARY SERVICE
EXTERIOR	FINAL GAS	MISCELLANEOUS
DRYWALL	FINAL AIR COND.	GRADING & DRAINAGE
LATHING	FINAL REFRIG.	ON-SITE PARKING SPACES
BACKING (SIDING)	FINAL SEWER	ENG. APPROVAL OF
PLASTER SCRATCH	FINAL SEPTIC TANK	OFF-SITE IMPROVEMENTS
BROWN		
URBAN REDEVELOPMENT APPROVAL		
FINAL BLDG. DATE 5-22-64		

INSPECTOR DATE

APPROVED FOR OCCUPANCY & METER

PLEASE NOTE REMARKS ON REVERSE SIDE

210 Adams

Upland, Calif 6-28-72

CITY OF LAS VEGAS, NEVADA
DEPARTMENT OF BUILDING & SAFETY
APPLICATION FOR BUILDING PERMIT
RESIDENTIAL (Single family
dwelling, duplex,
miscellaneous
residential)

LOG NO: _____
CONSTRUCTION VALUATION: 620.00
INSPECTION VALUATION: 504.00
PERMIT FEE: 11.00
TELEPHONE: _____
PERMIT NUMBER: 32643
DATE: 2-21 1966

ADDRESS OF CONSTRUCTION: 210 Adams
LOT (s) 1, 4 BLOCK 16 SUBDIVISION Valley View Addition
OWNER'S NAME: Walter Reynolds
CIRCLE EXISTING STRUCTURE ON LOT: Well ZONE R-3
PROPOSED CONSTRUCTION: Demolish and Rebuild Accessory Building (s) None Vacant Lot Storage Shed

MATERIALS OF CONSTRUCTION: Wood (X) Concrete () Reinforced Steel ()
Frame (X) Block () Concrete () Frame ()
SQUARE FEET OF FLOOR AREAS: 1st 60 2nd 0 TOTAL SQUARE FEET: None
FIRE ZONE: 1 2 OCCUPANCY GROUPS: J / 1 2 BUILDING TYPE I II III IV V
ARCHITECT'S NAME: _____ ENGINEER'S NAME: _____
PLANS SUBMITTED: YES () NO (X) CALCULATIONS SUBMITTED: YES () NO (X)
CONTRACTOR'S NAME: Dwain Adams State License # _____ City License # _____
ADDITIONAL PERMITS REQUIRED: Air Conditioning () Electrical (X) Plumbing ()
Other ()

If Tract House Insert Model Number Here _____

Show House Location on Lot Space Below:

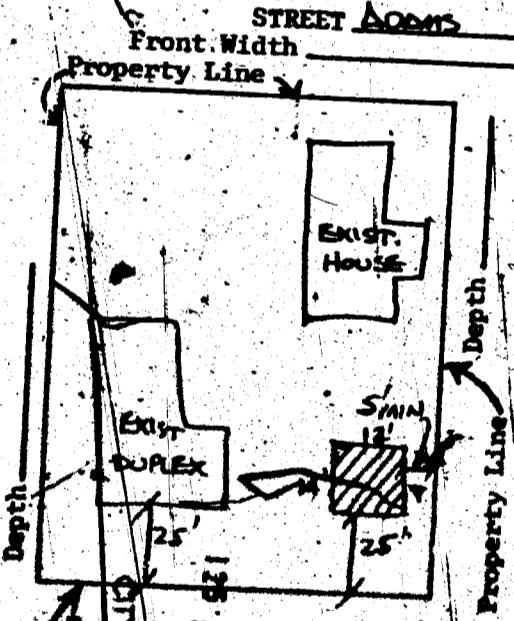

Front Width _____
Depth _____
City Easement _____
Public Sewer _____
Water _____
Well _____
Plan Submitted _____
21 Nov 66
23.08
12/16/64

I state that I am familiar with effective Ordinances of the City of Las Vegas, Nevada and effective Statutes of the State of Nevada covering construction and use of above type. I agree to perform said construction in conformity therewith. I further agree that issuance of a permit on above application will not excuse me from conforming with said Ordinances and Statutes despite any errors on the part of the Building Inspector or Engineer in checking plans and applications herewith submitted.

I have read and understand the contents of above application; I hereby state that same are true and correct.

SIGN HERE: Walter Reynolds
BY: _____ (Contractor)

(Agent of Owner)

The Contractor's signature above denotes authority from the owner to sign in his behalf and that the owner is aware of all requirements of this application.

Separate permits must be obtained for all Electrical, Plumbing, Air Conditioning, Sign, Sidewalk, Paving, Curb and Gutters, Flammable Tank Storage, and Incinerator & Fire Sprinkler Systems.

APPROVED: _____
PLANNING DEPT. _____ Date _____
ENGINEERING DEPT. _____ Date _____
BUILDING & SAFETY _____ Date _____
Subject to Demo of Existing Acry & New Acry Meeting Bldg Code