

1300 S. "A" St.

Gloria, Call 10-20-80

DEPT. of BLDG. & SAFETY - CITY of LAS VEGAS, NEVADA  
OWNER: WESTERN STEEL CO. ADDRESS: 1300 South "A" St. DATE: 5/5/58  
GEN. CONT. J. E. WOOTEN CONSTR. TYPE OF STRUCTURE: FABRICATE STEEL SHADE  
PERMIT NO. 31030 LEGAL DESCRIPTION: Por. SE<sup>1</sup>/<sub>4</sub>, NE<sup>1</sup>/<sub>4</sub>, NE<sup>1</sup>/<sub>4</sub>, Sec. 4, T21S, R61E.

LOCATION & FLOOR ELEVATION	PLUMBING CONT. _____ PERMIT NO. _____ DATE _____	TEMP. POLE CONT. _____ PERMIT NO. _____ DATE _____
FOOTINGS <i>Eller 5-6-58</i>	HEAT & VENT. CONT. _____ PERMIT NO. _____ DATE _____	INSPECTION _____ DATE _____
FOUND. & PIERS	SEWER CONT. _____ PERMIT NO. _____ DATE _____	ELECTRICAL CONT. _____ PERMIT NO. _____ DATE _____
WALL STEEL	ROUGH SOIL _____	OUTLETS _____
BOND BEAM STEEL	ROUGH WATER _____	MOTORS _____ H.P. _____
FRAMING & ROOF SHEATHING	SEWER OR SEPTIC TANK _____	SLAB _____
STEEL FABRICATION	TOP-OUT _____	ROUGH _____
CONNECTIONS & PAINTING	ROUGH GAS _____	FINAL ROUGH _____
INTERIOR _____ EXTERIOR _____	ROUGH DUCT _____	FIXTURE CONT. _____ PERMIT NO. _____ DATE _____
FINISHING _____	FINAL PLUMBING _____	FIXTURES _____
PLASTER _____	FINAL HEATING _____	FINAL FIXTURE _____
SCRATCH _____	FINAL GAS _____	APPROVED FOR METER _____
BROWN _____		
FINAL BLDG. <i>Eller 5-6-58</i>		
GRADING & DRAINAGE		
ON-SITE PARKING _____ SPACES _____		
ENG APPROVAL OF OFF-SITE IMPROVEMENTS		

APPROVED for OCCUPANCY: \_\_\_\_\_ INSPECTOR \_\_\_\_\_ DATE \_\_\_\_\_

\* PLEASE NOTE REMARKS ON REVERSE SIDE  
1300 South "A" St. - FABRICATE STEEL SHADE

5/5/58 23.04

· 1300 N. "A" ST. ·

· PORTION OF WE $\frac{1}{2}$  NW $\frac{1}{4}$  NE $\frac{1}{4}$  SEC 27 T20S R61E ZONED M ·

J. Garcia 11-28-98

CITY OF LAS VEGAS, NEVADA

LOG NO. & AREA \_\_\_\_\_

CONST. VAL. \$ 10,000<sup>00</sup>

DEPARTMENT OF BUILDING & SAFETY

APPLICATION & BUILDING PERMIT — for:  
Commercial or Public Structures.

ADDRESS OF CONSTRUCTION:

1300 NORTH A ST

OWNER: RYDER TRUCK RENTAL INC

PORTION OF SW 1/4, NW 1/4, NE 1/4, SEC 27, T20S, R1E ZONE: 11

Existing structure on lot: Dwelling  Accessory bldgs.  Vacant lot  Commercial Bldg.  Other

PROPOSED CONSTRUCTION: REMODEL USE: \_\_\_\_\_

MATERIALS OF CONSTRUCTION: Wood Frame  Concrete Block  Reinforced Concrete  Steel Frame

SQUARE FEET OF FLOOR AREAS: 1st \_\_\_\_\_ 2nd \_\_\_\_\_ 3rd \_\_\_\_\_ Other \_\_\_\_\_ TOTAL SQ. FT. \_\_\_\_\_

FIRE ZONE: 1 2 3 Occupancy Group A B C D E F G H I J-1-2-3-4-5 CONST. TYPE: I II III IV V

ARCHITECT: \_\_\_\_\_ ENGINEER: \_\_\_\_\_ NO. of UNITS \_\_\_\_\_ NO. of STORIES \_\_\_\_\_

Plans Submitted: Yes  No  Calculations Submitted: Yes  No  Sewer Fee Req'd. Yes  No

CONTRACTOR: UTE INC STATE LICENSE # 6350 C CITY LICENSE # 08202

ADD'L. PERMITS REQ'D: Air Cond.  Elec.  Plumbing  Signs  Paving  Fence  Public Walks  Curb-gutters  Incinerators  Fire Sprinkling System

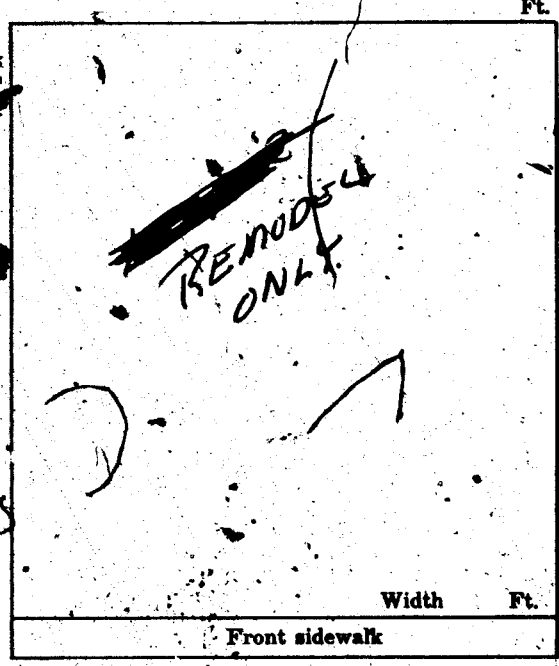

CONDITIONS OF THE PERMIT:

1. I agree to call the City Building Department for inspections before concrete is poured, before rough wiring, electrical, plumbing, framing is covered. Also for Air conditioning, sheet-rock and sheathing inspection.
2. I agree that when the job is completed that I will call for final inspection before occupancy.
3. I agree to perform all construction in accordance with City Ordinances and Building Codes.
4. The Contractor's signature below denotes authority from the owner to sign in his behalf and that the owner is aware of all requirements of this application and permit. Separate permits must be taken out for work outlined above this agreement.
5. I have read and understand the contents of this application and permit; I hereby state that the information I have supplied on this application is true and correct.

SIGNED: UTE INC Contractor

BY: Sharon Shurtle Agent or Owner

CLARK COUNTY HEALTH DEPT. Date \_\_\_\_\_

LAS VEGAS FIRE DEPARTMENT Date \_\_\_\_\_

PLANNING DEPT. [Signature] Date: 4-23-70

ENGINEERING DEPT. [Signature] Date: 4-23-70

BUILDING DEPT. [Signature] Date: 4-23-70

#12850 PERMIT NO: 53004 PERMIT FEE: 63<sup>00</sup>

RECEIPT

2928 5065.00 - 8

CITY OF LAS VEGAS  
DEPT. OF BUILDING & SAFETY

MUST BE MACHINE VALIDATED

7-1-70

DK Jones 11-28-78

CITY OF LAS VEGAS, NEVADA  
DEPARTMENT OF BUILDING & SAFETY

RECEIPT  
FOR  
SEWER CONNECTION FEE

JOB ADDRESS: 1300 N. A OWNER'S NAME: Ryder Truck Rental  
LOT \_\_\_\_\_ BLOCK \_\_\_\_\_ SUBDIVISION \_\_\_\_\_

QUANTITY	OCCUPANCY	UNIT FEE	AMOUNT
1	WASH Rack ON EXISTING BOD.		300.

PAID BY: \_\_\_\_\_

TOTAL \_\_\_\_\_  
 Less Credit \* \_\_\_\_\_  
 TOTAL FEE \$ 300.00

\*Credit for existing sewer is applied to the new sewer connection fee based on previous type of occupancy and only when the new occupancy requires an additional fee.  
This receipt does not authorize the owner or his representative to start any work without obtaining a plumbing permit.

RP  
DEPARTMENT OF BUILDING & SAFETY  
DATE 5-12-70

73102

RECEIPT NO. 30388 SEWER FEE \$ 300.00

RECEIPT  
3977 \$300.00 -3  
CITY OF LAS VEGAS  
DEPT. OF  
BUILDING & SAFETY  
MUST BE MACHINE VALIDATED  
MAY 20 1970

11-28-78

**CITY OF LAS VEGAS, NEVADA**

**DEPARTMENT OF BUILDING & SAFETY - ELECTRICAL APPLICATION & PERMIT**

ADDRESS OF CONSTRUCTION: **1300 "A" STREET**

OWNER'S NAME: **RYDER TRUCK RENTALS**

CIRCLE: New Bldg.; Add'n; Remodel; TYPE OF BLDG.: SFD. APT. PUBLIC COMM.

CONTRACTOR'S NAME: **SIMPSON & BOZARTH ELECTRIC CO.**

STATE LICENSE # **6424A**

CITY LICENSE # **7564**

NUMBER	FIXTURE OR INSTALLATION	UNIT PRICE	
6	Fixture or sockets	.15	.90
10	Light, receptacle or switch outlet	.20	2.00
	Wall or ceiling space heater	.35	
	Blast coil heater per kilowatt	.35	
	Garbage grinder outlet	.35	
	Dishwasher outlet	.35	
	Clothes dryer outlet	.35	
	Automatic clothes washer	.35	
	Electric range outlet	.35	
	Electric water heater outlet	.35	
	Mercury arc lamp and equipment	.35	
2	Special purpose outlet	.35	.70
	X-ray unit and its appurtenances	5.00	
	Watts of festoon lighting (Watts) First 3,000 watts	4.00	
	for each additional thousand watts	1.50	
	Horsepower - all motors first horsepower or less	1.75	
	for each additional horsepower	.35	
	Temporary power and lights (temporary pole)	4.00	
1	Electric service (including any single meter socket)	3.00	3.00
	for each additional socket	.35	
	Air conditioning service	amps 1.50	
	Each KW (KVA) Generator (Transformer) (Welder) KW (KVA)	2.00	
	First 100 KVA - For each additional KW (KVA)	.01	
	Special inspection per hour	4.00	
	Speaker outlets	.15	
	Signal or Alarm outlets	.15	
	Amplifiers	.50	
	Control panels	.25	
	T. V. outlets - master system only	.15	
	Radio outlets	.15	
	Main control racks	1.00	
	T. V. and Radio antennas - master system only	.75	
	Minimum fee for any permit	4.00	
	Total fee		6.60

I hereby certify that I have carefully examined and read the above application; that the same is true and correct, and that the work herein described is to be done in accordance with all the provisions of the applicable Ordinances of the City of Las Vegas, Nevada and State laws whether herein specified or not.

SIGNED William B. Simpson DATE MAY 28, 1970  
MASTER (ELECTRICIAN)  
 BUILDING DEPARTMENT [Signature] DATE 6-2-70  
 PERMIT NO. 30803 PERMIT FEE: 6.60

RECEIPT  
 5094 \$006.60 - 6  
 CITY OF LAS VEGAS  
 DEPARTMENT OF BUILDING & SAFETY

CITY OF LAS VEGAS, NEVADA

DEPARTMENT OF BUILDING & SAFETY - APPLICATION AND PERMIT FOR PLUMBING

ADDRESS OF CONSTRUCTION: 1300 No A St.

OWNER'S NAME: Ryder Truck

CIRCLE: New Bldg.; Remodel; TYPE OF BLDG.: SFD. APT. PUBLIC COMM.

CONTRACTOR'S NAME: Ryally Co.

STATE LICENSE # 6025 CITY LICENSE # 8056

UNITS	DESCRIPTION	FEE	TOTAL
	Bathtub	1.00	
	Shower	1.00	
	Lavatory	1.00	
	Toilet	1.00	
	Urinal	1.00	
	Floor Drain	1.00	
	Floor Sink	1.00	
	Wash Tray	1.00	
	Sink	1.00	
	Garbage Disposal	1.00	
	Garbage Disposal (comm.)	3.00	
	Clothes Dryer (gas)	1.00	
	Clothes Washer	1.00	
	Clothes Washer (comm.)	5.00	
	Dishwasher	1.00	
	Dishwasher (commercial)	5.00	
	Dental Unit	10.00	
	Drinking Fountain	1.00	
	Any Water using Equipment	1.00	
	Water Heater (gas) (elect.)	1.00	
	Sewer System - New, Replacement or any Drainage System	4.00	
	Grease or Sand Trap	2.00	2.00
	Trailer Trap	2.00	
	Septic Disposal System	4.00	
WATER SOFTENERS			
	Nonpermanent Type	4.00	
	Permanent Type (connected to Drainage)	5.00	
SWIMMING POOLS			
	Private or Wading Pool	10.00	
	Public or Semi-public	20.00	

UNITS	DESCRIPTION	FEE	TOTAL
WATER DISTRIBUTION SYSTEM			
	Single Family Dwelling	4.00	
	Multiple Family Dwelling plus each unit	4.00 2.00	
	Bldg. Group "A" thru "G" per each floor	6.00	
	Hotel or Motel plus each bath	4.00 1.50	
	Trailer Park plus each space	20.00 1.00	
	Irrigation	4.00	
GAS PIPING SYSTEM			
	Single Family Dwelling	3.00	
	Multiple Family Dwelling plus each unit	6.00 1.00	
	Commercial Bldg. per floor plus each unit	3.00 3.00	
	Gas Appliance (any type)	1.00	
AUTOMATIC FIRE EXTINGUISHING SYSTEM			
	Underground Piping	10.00	
	Distribution Piping ea. ft.	.01	
	Sprinkler Head each	.10	
	In Range Hood and Vent	5.00	
DRY STANDPIPE SYSTEM			
	Piping	50.00	
	Each Outlet	1.00	
WET STANDPIPE SYSTEM			
	Piping	5.00	
	Fire Hose Cabinet	1.00	
MINIMUM PERMIT FEE 4.00			
TOTAL PERMIT FEE \$ <u>41.00</u>			

I hereby certify that I have carefully examined and read the above application; that the same is true and correct; and that the work herein described is to be done in accordance with all the provisions of the applicable Ordinances of the City of Las Vegas, Nevada and the State Laws, whether herein specified or not.

Signed: Troy Ray Date: 7-13-70  
 REGISTERED MASTER PLUMBER, SPEC. CONTR., OR OWNER  
 Building Department: [Signature] Date: 7-13-70  
 #12870 Permit No. 30974 Permit Fee \$ 4.09

RECEIPT  
 6948 \$500.00 - 7  
 CITY OF LAS VEGAS  
 DEPT. OF BUILDING & SAFETY  
 MUST BE MACHINE RECORDED

D. Price 11-28-78

CITY OF LAS VEGAS, NEVADA

CONST. VAL. \$ 2500<sup>00</sup>

LOG NO. & AREA

DEPARTMENT OF BUILDING & SAFETY

APPLICATION & BUILDING PERMIT - For: Commercial or Public Structures.

ADDRESS OF CONSTRUCTION: 1300 N "A" STREET

OWNER: RYDER TRUCK RENTAL

LOT(s) BLOCK SUBDIVISION ZONE

Existing structure on lot: Dwelling, Accessory Bldgs., Vacant lot, Commercial Bldg., Other

PROPOSED CONSTRUCTION: INSTALL FUEL STORAGE & OIL STORAGE TANKS + CONCRETE SLAB

MATERIALS OF CONSTRUCTION: Wood Frame, Concrete Block, Reinforced Concrete, Steel Frame

SQUARE FEET OF FLOOR AREAS: 1st, 2nd, 3rd, Other, TOTAL SQ. FT.

FIRE ZONE: 1, 2, 3 Occupancy Group A, B, C, D, E, F, G, H, I, J, 1-2, 3-4, 5 CONST. TYPE: I, II, III, IV, V

ARCHITECT: ENGINEER: NO. of UNITS NO. of STORIES

Plans Submitted: Yes, No Calculations Submitted: Yes, No Sewer Fee Req'd: Yes, No

CONTRACTOR: UTE INC. STATE LICENSE # 6350 CITY LICENSE # 8202

ADD'L. PERMITS REQ'D: Air Cond., Elec., Plumbing, Signs, Paving, Fence, Public Works, Curb-gutters, Incinerators, Fire Sprinkling System

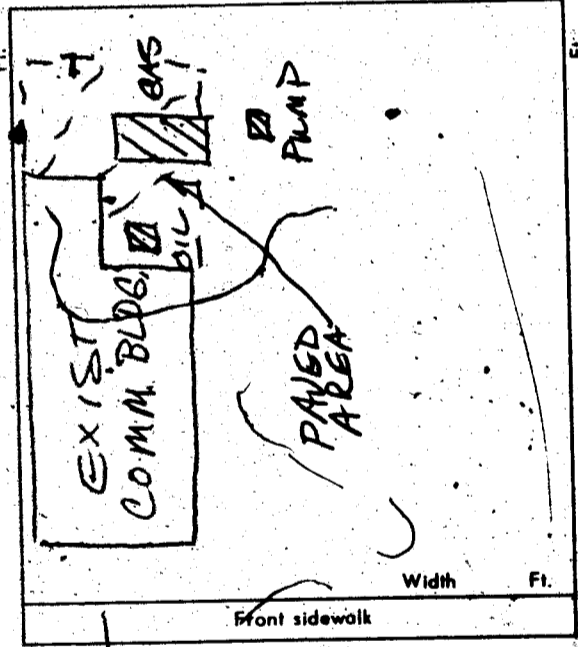

CONDITIONS OF THE PERMIT:

- 1. I agree to call the City Building Department for inspections before concrete is poured...
2. I agree that when the job is completed that I will call for final inspection before occupancy.
3. I agree to perform all construction in accordance with City Ordinances and Building Codes.
4. The Contractor's signature below denotes authority from the owner to sign in his behalf...
5. I have read and understand the contents of this application and permit; I hereby state that the information I have supplied on this application is true and correct.

SIGNED: UTE INC. Contractor

BY: David Hester Agent or Owner

CLARK COUNTY HEALTH DEPT. Date 8/19/70
LAS VEGAS FIRE DEPARTMENT

PLANNING DEPT. Date 8-19-70

PUBLIC WORKS DEPT. Date:

BUILDING DEPT. Date: 8-19-70

#12850 PERMIT NO.: 54602 PERMIT FEE \$ 2400

RECEIPT
8711 \$024.00 - 8
CITY OF LAS VEGAS
DEPT. OF BUILDING & SAFETY
MUST BE MACHINE VALIDATED
19 AUG 70

CITY OF LAS VEGAS, NEVADA

DEPARTMENT OF BUILDING & SAFETY - ELECTRICAL APPLICATION & PERMIT

ADDRESS OF CONSTRUCTION: 3300 WAB Street OWNER'S NAME: Ute Construction  
 Hook up Gas Dispensers  
 CIRCLE: New Bldg.; Add'n; Remodel; TYPE OF BLDG.: SFD. APT. PUBLIC COMM.  
 CONTRACTOR'S NAME: FitzGerald Electric Inc. STATE LICENSE # 3851 CITY LICENSE # 1041

NUMBER	FIXTURE OR INSTALLATION	UNIT PRICE	
	Fixture or sockets	.15	
	Light, receptacle or switch outlet	.20	
	Wall or ceiling space heater	.35	
	Blast coil heater per kilowatt	.35	
	Garbage grinder outlet	.35	
	Dishwasher outlet	.35	
	Clothes dryer outlet	.35	
	Automatic clothes washer	.35	
	Electric range outlet	.35	
	Electric water heater outlet	.35	
	Mercury arc lamp and equipment	.35	
	Special purpose outlet	.35	
	X-ray unit and its appurtenances	5.00	
	Watts of festoon lighting (Watts) First 3,000 watts	4.00	
	for each additional thousand watts	1.50	
	Horsepower - all motors first horsepower or less	1.75	
	for each additional horsepower	.35	
	Temporary power and lights (temporary pole)	4.00	
	Electric service (including any single meter socket)	3.00	
	for each additional socket	.35	
	Air conditioning service amps	1.50	
	Each KW (KVA) Generator (Transformer) (Welder) KW (KVA)	2.00	
	First 100 KVA - For each additional KW (KVA)	.01	
	Special inspection per hour	4.00	
	Speaker outlets	.15	
	Signal or Alarm outlets	.15	
	Amplifiers	.50	
	Control panels	.25	
	T. V. outlets - master system only	.15	
	Radio outlets	.15	
	Main control racks	1.00	
	T. V. and Radio antennas - master system only	.75	
	Minimum fee for any permit	4.00	4.00
	Total fee		4.00

I hereby certify that I have carefully examined and read the above application; that the same is true and correct; and that the work herein described is to be done in accordance with all the provisions of the applicable Ordinances of the City of Las Vegas, Nevada and State laws whether herein specified or not.

SIGNED C. J. Stapleton DATE 9-4-70  
 MASTER ELECTRICIAN (TECHNICIAN) (OWNER)  
 BUILDING DEPARTMENT M. Miller DATE 9-11-70  
 PERMIT NO. 31965 PERMIT FEES 4.00

RECEIPT  
 9601 \$004.00 - 6  
 CITY OF LAS VEGAS  
 DEPT. OF  
 MUST BUILDING & SAFETY  
 11 SEP 70

\*12860

D. Jones 11-28-78

#2058

LOG NO. & AREA \_\_\_\_\_ CITY OF LAS VEGAS, NEVADA CONST. VAL. \$200<sup>00</sup>

DEPARTMENT OF BUILDING & SAFETY

APPLICATION & BUILDING PERMIT - for: Commercial or Public Structures.

ADDRESS OF CONSTRUCTION: 1300 N. 2nd St

OWNER: Ryder Truck Rental

LOT(s) \_\_\_\_\_ BLOCK \_\_\_\_\_ SUBDIVISION \_\_\_\_\_ ZONE: \_\_\_\_\_

Existing structure on lot: Dwelling  Accessory Bldgs.  Vacant Lot  Commercial Bldg.  Other

PROPOSED CONSTRUCTION: Roofing USE: \_\_\_\_\_

MATERIALS OF CONSTRUCTION: Wood Frame  Concrete Block  Reinforced Concrete  Steel Frame

SQUARE FEET OF FLOOR AREAS: 1st \_\_\_\_\_ 2nd \_\_\_\_\_ 3rd \_\_\_\_\_ Other \_\_\_\_\_ TOTAL SQ. FT. \_\_\_\_\_

FIRE ZONE: 1 2 3 Occupancy Group A B C D E F G H I J-1-2-3-4-5 CONST. TYPE: I II III IV V

ARCHITECT: \_\_\_\_\_ ENGINEER: \_\_\_\_\_ NO. of UNITS \_\_\_\_\_ NO. of STORIES \_\_\_\_\_

Plans Submitted: Yes  No  Calculations Submitted: Yes  No  Sewer Fee Req'd. Yes  No

CONTRACTOR: Chief Roof STATE LICENSE # \_\_\_\_\_ CITY LICENSE # \_\_\_\_\_

ADD'L. PERMITS REQ'D: Air Cond.  Elec.  Plumbing  Signs  Paving  Fence  Public Walks  Curb-gutters  Incinerators  Fire Sprinkling System

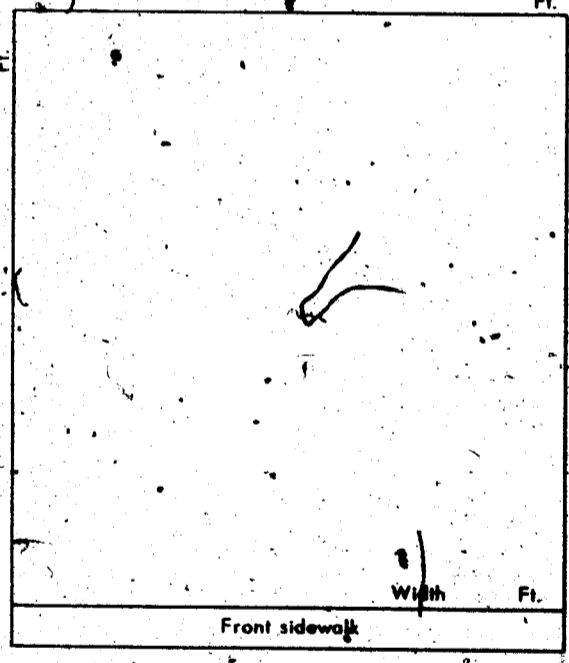

CONDITIONS OF THE PERMIT:

1. I agree to call the City Building Department for inspections before concrete is poured, before rough wiring, electrical, plumbing, framing is covered. Also for Air conditioning, sheet-rock and sheathing inspection.
2. I agree that when the job is completed that I will call for final inspection before occupancy.
3. I agree to perform all construction in accordance with City Ordinances and Building Codes.
4. The Contractor's signature below denotes authority from the owner to sign in his behalf and that the owner is aware of all requirements of this application and permit. Separate permits must be taken out for work outlined above this agreement.
5. I have read and understand the contents of this application and permit; I hereby state that the information I have supplied on this application is true and correct.

SIGNED: Chief Roof Contractor

BY: Miller Bonner Agent or Owner

CLARK COUNTY HEALTH DEPT. Date \_\_\_\_\_

LAS VEGAS FIRE DEPARTMENT Date \_\_\_\_\_

PLANNING DEPT.: \_\_\_\_\_ Date: \_\_\_\_\_

PUBLIC WORKS DEPT.: \_\_\_\_\_ Date: \_\_\_\_\_

BUILDING DEPT.: N. Miller Date: 10-20-78

#12850 PERMIT NO. 55270 PERMIT FEE \$500

RECEIPT  
1068 \$005.00 - 8  
CITY OF LAS VEGAS  
DEPT. OF BUILDING & SAFETY  
MUST BE MACHINE VALIDATED  
20 OCT 78

Glenn Ealy 10-20-80

**DEPT. of BLDG & SAFETY - CITY of LAS VEGAS, NEVADA**

OWNER Ryder Truck Rental ADDRESS 1300 N "A" St. DATE 10-20-70  
 GEN. CONT. Chief Roof TYPE OF STRUCTURE Roofing  
 PERMIT NO. 55270 LEGAL DESCRIPTION

BUILDING	MECHANICAL	ELECTRICAL
LOCATION _____	PLUMBING CONT. _____	TEMP. POLE CONT. _____
FIREPLAC. FTS. _____	PERMIT NO. _____ DATE _____	PERMIT NO. _____ DATE _____
ROOTINGS _____	HEAT & VENT. AC CONT. _____	INSPECTION _____ DATE _____
FOUNDATION WALL _____	PERMIT NO. _____ DATE _____	ELECTRICAL CONT. _____
FLOOR FRAMING _____	SEWER CONT. _____	PERMIT NO. _____ DATE _____
SLAB _____	PERMIT NO. _____ DATE _____	FIXTURES / CONT. _____
CHIMNEY STEEL (FIREPLACE) _____	ROUGH SOIL _____	PERMIT NO. _____ DATE _____
WALL STEEL _____	ROUGH WATER _____	SLAB _____
COLUMN STEEL _____	TOP-OUT _____	ROUGH _____
BEAM STEEL _____	ROUGH GAS _____	FINAL ROUGH _____
FRAMING _____	AC ROUGH DUCT _____	FINAL FIXTURE _____
ROOF SHEATHING _____	REF. ROUGH PIPING _____	FINAL ELECTRICAL _____
DRYWALL _____	FINAL PLUMBING _____	TEMPORARY SERVICE _____
LATHING _____	FINAL GAS _____	
BACKING (SIDING) _____	FINAL AIR COND. _____	MISCELLANEOUS
PLASTER SCRATCH _____	FINAL REFRIG. _____	GRADING & DRAINAGE _____
PLASTER BROWN _____	FINAL SEWER _____	ON-SITE PARKING SPACES _____ APP. _____
URBAN REDEVELOPMENT APPROVAL _____	FINAL SEPTIC TANK _____	ENG. APPROVAL OF _____
FINAL BLDG _____ DATE _____		OFF-SITE IMPROVEMENTS _____

INSPECTOR \_\_\_\_\_ DATE \_\_\_\_\_

APPROVED FOR OCCUPANCY & METER D.B. 11-3-70

PLEASE NOTE REMARKS ON REVERSE SIDE 1300 N. "A" St. LOG # \_\_\_\_\_ AREA # \_\_\_\_\_ 23.04

**Department of Building & Safety**  
**City of Las Vegas, Nevada**

**Special Kardex**  
**Elect. only-Plbg. only-A.C. only**

Owner Silver State Disposal Address 1300 North "A" St. Date 6-7-65  
 Contractor Benton Electrical Co. Permit No. \_\_\_\_\_  
 Lot \_\_\_\_\_ Block \_\_\_\_\_ Subdivision \_\_\_\_\_

Electric Only	Plumbing Only	Heat & Vent. A.C. Only
Contractor <u>Benton Elec</u>	Contractor _____	Contractor _____
Permit No. <u>19648</u>	Permit No. _____	Permit No. _____
Slab _____	Rough Soil _____	A.C. Rough Duct _____
Rough Elect _____	Rough Water _____	Ref. Ro. Piping _____
Final Rough _____	Top Out _____	Rough Gas _____
Final Fixture _____	Rough Gas _____	Final Refrig _____
Final Elect <u>West 112465</u>	Final Plbg. _____	Final Air Cond. _____
Temp: Service _____	Final Gas _____	Final Gas _____
<u>Pole 8-19-65</u>	Final Sewer _____	
	Final Septic Tank _____	

23.06 D Address 1300 No. "A" St. Log No. \_\_\_\_\_ Area temp pole

Aloua Ealy 10-20-80

DEPT. of BLDG & SAFETY—CITY of LAS VEGAS, NEVADA

OWNER Ryder Truck Rental ADDRESS 1300 N. "A" Street DATE 8/19/70  
 GEN. CONT. lfe-tpc TYPE OF STRUCTURE Fuel & Oil Storage Tanks  
 PERMIT NO. 54602 LEGAL DESCRIPTION See Permit

BUILDING		MECHANICAL	ELECTRICAL
LOCATION		PLUMBING CONT.	TEMP. POLE CONT.
FIREPLACE FTS		PERMIT NO. _____ DATE _____	PERMIT NO. _____ DATE _____
FOOTINGS		HEAT & VENT. AC CONT.	INSPECTION _____ DATE _____
FOUNDATION WALL		PERMIT NO. _____ DATE _____	ELECTRICAL CONT.
FLOOR FRAMING		SEWER CONT.	PERMIT NO. _____ DATE _____
SLAB		PERMIT NO. _____ DATE _____	FIXTURES CONT.
CHIMNEY STEEL (FIREPLACE)		ROUGH SOIL	PERMIT NO. _____ DATE _____
WALL STEEL		ROUGH WATER	SLAB
COLUMN STEEL		TOP-OUT	ROUGH
BEAM STEEL		ROUGH GAS	FINAL ROUGH
FRAMING		AC ROUGH DUCT	FINAL FIXTURE
ROOF SHEATHING		REF. ROUGH PIPING	FINAL ELECTRICAL
INTERIOR _____ EXTERIOR _____		FINAL PLUMBING	TEMPORARY SERVICE _____
DRYWALL _____		FINAL GAS	MISCELLANEOUS
LATHING _____		FINAL AIR COND.	
BACKING (SIDING) _____		FINAL REFRIG.	GRADING & DRAINAGE _____
PLASTER SCRATCH _____		FINAL SEWER	ON-SITE PARKING SPACES _____ APP. _____
PLASTER BROWN _____		FINAL SEPTIC TANK	ENG. APPROVAL OF _____
URBAN REDEVELOPMENT APPROVAL _____			OFF-SITE IMPROVEMENTS _____
FINAL BLDG <u>OB</u> DATE <u>10-13-70</u>			

APPROVED FOR OCCUPANCY & METER \_\_\_\_\_ INSPECTOR \_\_\_\_\_ DATE \_\_\_\_\_

PLEASE NOTE REMARKS ON REVERSE SIDE LOG # \_\_\_\_\_ AREA # \_\_\_\_\_ 23.04  
 1300 N "A" Street

DEPT. of BLDG & SAFETY—CITY of LAS VEGAS, NEVADA

OWNER Ryder Truck Rental ADDRESS 1300 N "A" St DATE 4/24/70  
 GEN. CONT. lfe TYPE OF STRUCTURE Remodel  
 PERMIT NO. 53004 LEGAL DESCRIPTION See Permit

BUILDING		MECHANICAL	ELECTRICAL
LOCATION		PLUMBING CONT. <u>Ray Plant</u>	TEMP. POLE CONT.
FIREPLACE FTS		PERMIT NO. <u>30974</u> DATE <u>7-14-70</u>	PERMIT NO. _____ DATE _____
FOOTINGS		HEAT & VENT. AC CONT.	INSPECTION _____ DATE _____
FOUNDATION WALL		PERMIT NO. _____ DATE _____	ELECTRICAL CONT. <u>Dem... result</u>
FLOOR FRAMING		SEWER CONT. <u>Ryder Truck Rental</u>	PERMIT NO. <u>30803</u> DATE <u>4-8-70</u>
SLAB		PERMIT NO. <u>30388</u> DATE <u>5-12-70</u>	FIXTURES CONT. <u>General</u>
CHIMNEY STEEL (FIREPLACE)		ROUGH SOIL	PERMIT NO. <u>31765</u> DATE <u>7-11-70</u>
WALL STEEL		ROUGH WATER	SLAB
COLUMN STEEL		TOP-OUT	ROUGH <u>11-4-70</u>
BEAM STEEL		ROUGH GAS	FINAL ROUGH
FRAMING <u>10-13-70</u>		AC ROUGH DUCT	FINAL FIXTURE
ROOF SHEATHING		REF. ROUGH PIPING	FINAL ELECTRICAL
INTERIOR <u>OB 10-13-70</u> EXTERIOR _____		FINAL PLUMBING	TEMPORARY SERVICE _____
DRYWALL _____		FINAL GAS	MISCELLANEOUS
LATHING _____		FINAL AIR COND.	
BACKING (SIDING) _____		FINAL REFRIG.	GRADING & DRAINAGE _____
PLASTER SCRATCH _____		FINAL SEWER <u>10-29-70</u>	ON-SITE PARKING SPACES _____ APP. _____
PLASTER BROWN _____		FINAL SEPTIC TANK	ENG. APPROVAL OF _____
URBAN REDEVELOPMENT APPROVAL _____			OFF-SITE IMPROVEMENTS _____
FINAL BLDG <u>OB</u> DATE <u>10-12-70</u>			

APPROVED FOR OCCUPANCY & METER \_\_\_\_\_ INSPECTOR \_\_\_\_\_ DATE \_\_\_\_\_

PLEASE NOTE REMARKS ON REVERSE SIDE LOG # \_\_\_\_\_ AREA # \_\_\_\_\_ 23.04  
 1300 "A" St.

Altonia Ealy 10-20-80

Department of Building & Safety  
City of Las Vegas, Nevada

Special Kardex  
Elect. only - Plbg. only - A.C. only

Owner: Silver State Disposal Address: 1300 N. A Date: 3-17-65  
Contractor: Fitzgerald Elec Permit No.  
Bot Block Subdivision

Electric Only	Plumbing Only	Heat & Vent - A.C. Only
Contractor: Fitzgerald	Contractor:	Contractor:
Permit No: 19238	Permit No:	Permit No:
Slab:	Rough Soil:	A.C. Rough Duct:
Rough Elect:	Rough Water:	Ref. No. Piping:
Final Rough:	Top Out:	Rough Gas:
Final Fixture:	Rough Gas:	Final Refrig:
Final Elect: 224565	Final Plbg:	Final Air Cond:
Temp. Service:	Final Gas:	Final Gas:
	Final Sewer:	
	Final Septic Tank:	

23.06 D Address: 1300 N. A. Log. No. Area

Permit Renewal in 1981

3

CITY OF LAS VEGAS, NEVADA  
BUILDING AND SAFETY DEPARTMENT APPLICATION AND PERMIT TO MOVE A BUILDING

TELEPHONE \_\_\_\_\_

LOCATION OF BUILDING TO BE MOVED 1300 "A" Street

BUILDING TO BE MOVED TO: Imperial ZONE: M FIRE ZONE: \_\_\_\_\_

OWNER'S NAME: Apache Land Corp

TYPE OF CONSTRUCTION: move SIZE: \_\_\_\_\_ PROPOSED USE: \_\_\_\_\_

On plot plan below, show existing buildings on lot and show distance to all property lines. Show location of the building to be moved as it will be placed on lot.

Applicant shall furnish FOUR PHOTOS of subject building, one of each elevation or side. Photos shall be shown to all applicable property owners and the attached comments completed. Completed application and photos shall be submitted to the Director of the Building and Safety Dept. for approval.

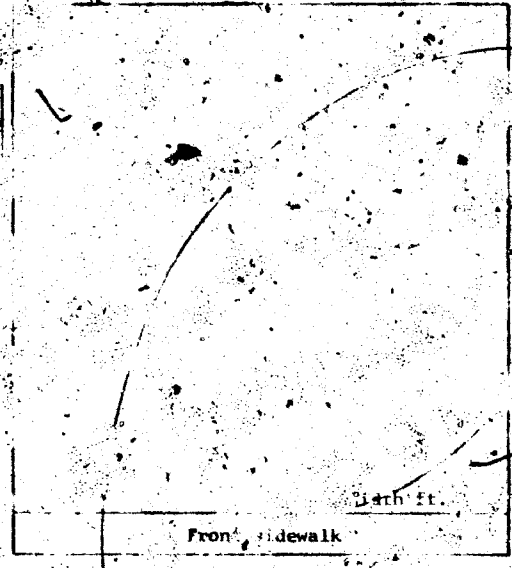

SIGNATURE OF APPLICANT \_\_\_\_\_  
CONSTRUCTION VALUATION \_\_\_\_\_  
MOVING CONTRACTOR: Apache Land Corp

STATE LICENSE: 017930 CITY LICENSE: CH-19846

ADDITIONAL PERMITS REQUIRED: Building  Electrical   
Plumbing  Air cond.  Sign  Other

Contractor's signature denotes authority from the owner to sign in his behalf and the owner is aware of all requirements of this application. Contractor must obtain permit from Traffic division, Police Department before moving on any public right of way.

SIGNED: APACHE LAND CORP Date: 2/17/81  
By \_\_\_\_\_

Comments from Property Owners adjacent to \_\_\_\_\_

We, the undersigned property owners, do declare by our signature that we own property within 300 feet of \_\_\_\_\_ (address) and have been contacted by Mr. and Mrs. \_\_\_\_\_ AND HAVE LOOKED AT THE BUILDING PICTURES and stated our comments below:

ADDRESS	SIGNATURE	AGREEABLE	NOT AGREEABLE	UNABLE TO CONTACT

PLU \$ 09  
SFD \$ 300  
SFP  
TOT \$ 31.00  
HEA \$ 7.00  
FIRST \$ 1.00  
CITY - LAS VEGAS  
BLDG. & SAFETY  
02/17/81

PLANNING DEPT. [Signature] DATE: 2/17/81  
PUBLIC WORKS DEPT. [Signature] DATE: 17/81  
BUILDING DEPT. [Signature] DATE: 2/17/81  
PERMIT NO. 8795 PERMIT FEE \$ 35.00

OWNER Apache Land Corp ADDRESS 1300 "A" Street  
7-17-81. PERM. CONT Apache Land

DAI Moving permit 8795  
TYPE OF STRUCTURE PERMIT NO. FINAL INSPECTION

LEGAL DESCRIPTION LOG # AREA

APPROVED FOR OCCUPANCY & METER

BUILDING	MECHANICAL
Investigation	Plumbing Cont.
Location & Footing	Permit No. Date
Concrete Slab Floor	Wgt. & Vekt. A/C Cont.
Fireplace Footing	Permit No. Date
Chimney Steel	Boiler Cont.
Vert. Pipe Relief	Permit No. Date
Horiz. Steel Ropes	Rough Sp.
Framing	Rough Water
Ext. Lgh	Top-Out
Ext. Down	Rough Gas
Drywall	A/C Rough Duct
Final Building <i>EC 1/12/81</i>	Final Plumbing
Appr. for Occu	Final Gas

ELECTRICAL

Panel Pole Cont.	Final Air Cond.
Permit No. Date	Final Power
Inspection Date	REMARKS
Electrical Cont.	
Permit No. Date	

Rough  
Final Rough  
Final Electrical  
Temporary Service

PLEASE NOTE ADDITIONAL REMARKS  
ON REVERSE SIDE  
DIV. OF BLDG. & SAFETY  
CITY OF LAS VEGAS  
REV. 10-78  
79-3-16