

708 CANOSA AVE.

LOT 5 BLK 3 ALTA VISTA ADDITION #2 ZONE R-1

CITY OF LAS VEGAS, NEVADA

LOG NO. & AREA

CONST. VAL. \$ 550.00

DEPARTMENT OF BUILDING & SAFETY

APPLICATION & BUILDING PERMIT — for:
Fence, Wall, Retaining Wall.

ADDRESS OF CONSTRUCTION: 708 CANOSA AVE

OWNER: ROYES PETERSEN

LOT(S) 5 BLOCK 3 SUBDIVISION ALTA VISTA ADD TR #2 ZONE: R-4

Materials of Construction: Block Concrete Wire Wood Other

Yes No
PLANS:

ARCHITECT:

ENGINEER:

CALCS:

CONTRACTOR: NONE OWNER

STATE LICENSE #

CITY LICENSE #

TOTAL SQUARE FEET:

TOTAL LINEAL FEET: 110

Remarks:

CONDITIONS OF THE PERMIT:

- Any type of retaining wall must be engineered by a Civil or Structural Engineer.
- If a home owner takes out the Building Permit and if the owner sublets the work to a Contractor, then the Contractor must take out the permit and pay for it.
- No fence or wall can be built on City property or rights-of-way, but this is not intended to preclude construction within utility easements if utilities will not be damaged or made inaccessible.
- The fence or wall shall not enclose any water meter, light standard, or fire alarm box and shall not come closer than 24" from the nearest fire hydrant outlet.
- Department Inspectors must approve footings before concrete is poured and block wall reinforcing before grouting is done.
- Maximum height of any wall or fence is 6' side and rear yards; 4' maximum in front yard with the vertical surface above the height of 2' — 50% open and further that fencing within 25' of the intersection of curb faces on corner and through lots is limited to a maximum height of 30".
- I must not obstruct required onsite parking (1 space for each dwelling unit) by the erection of this fence or wall.
- By the signing of this application I herewith agree to the requirements outlined above.

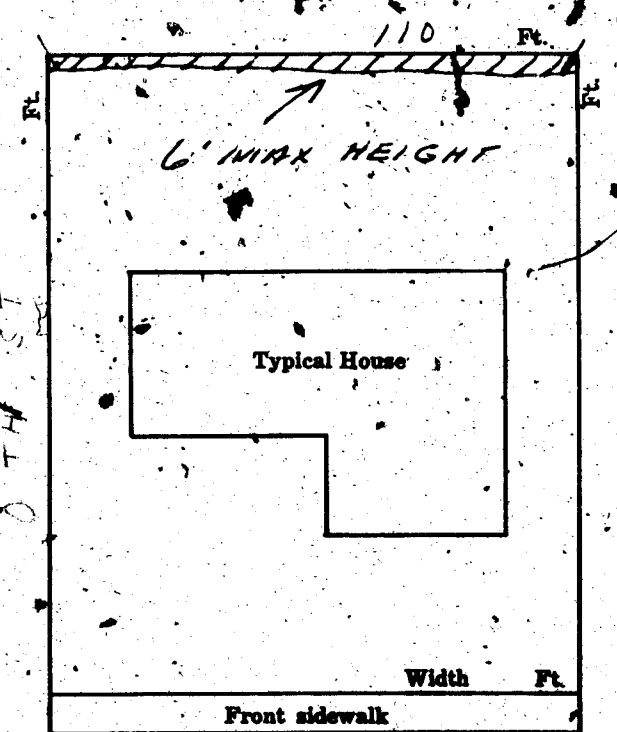

SIGNED: [Signature]

DATE: 3/12/69

CONTRACTOR AGENT OWNER

PLANNING DEPT: [Signature]

Date: 3-12-69

ENGINEERING DEPT: [Signature]

Date:

BUILDING DEPT: [Signature]

Date: 3-13-69

#1285

PERMIT NO: 46311

PERMIT FEE \$ 6.00

RECEIPT

48 \$006.00 - 8

CITY OF LAS VEGAS
DEPT. OF
BUILDING & SAFETY

MUST BE MACHINE VALIDATED

J 3 MAR 69

Handwritten: Nelson Ferguson Feb 8, 1979

CITY OF LAS VEGAS, NEVADA

1969
CONST. VAL. \$ 550.00

LOG NO. & AREA

DEPARTMENT OF BUILDING & SAFETY

APPLICATION & BUILDING PERMIT — for:
Fence, Wall, Retaining Wall.

ADDRESS OF CONSTRUCTION:

708 CANOSA AVE

OWNER: ROYES PETERSEN

LOT(S)

5

BLOCK 3

SUBDIVISION

ALTA VISTA ADD TR #2 ZONE: R-4

Materials of Construction:

Block

Concrete

Wire

Wood

Other

Yes No

PLANS:

ARCHITECT:

ENGINEER:

CALCS:

CONTRACTOR:

NONE OWNER

STATE LICENSE #

CITY LICENSE #

TOTAL SQUARE FEET:

TOTAL LINEAL FEET: 110

Remarks:

CONDITIONS OF THE PERMIT:

1. Any type of retaining wall must be engineered by a Civil or Structural Engineer.
2. If a home owner takes out the Building Permit and if the owner sublets the work to a Contractor, then the Contractor must take out the permit and pay for it.
3. No fence or wall can be built on City property or rights-of-way, but this is not intended to preclude construction within utility easements if utilities will not be damaged or made inaccessible.
4. The fence or wall shall not enclose any water meter, light standard, or fire alarm box and shall not come closer than 24" from the nearest fire hydrant outlet.
5. Department Inspectors must approve footings before concrete is poured and block wall reinforcing before grouting is done.
6. Maximum height of any wall or fence is 6', side and rear yards; 4' maximum in front yard with the vertical surface above the height of 2' — 50% open and further that fencing within 25' of the intersection of curb faces on corner and through lots is limited to a maximum height of 30".
7. I must not obstruct required onsite parking (1 space for each dwelling unit) by the erection of this fence or wall.
8. By the signing of this application I herewith agree to the requirements outlined above.

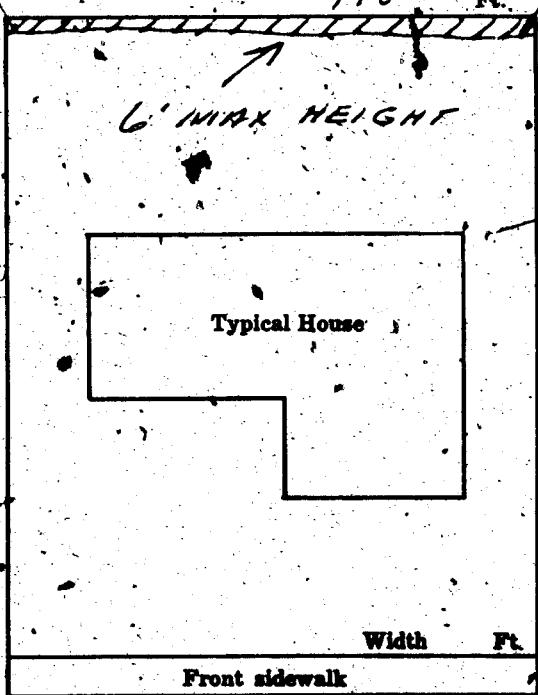

SIGNED: [Signature] DATE: 3/12/69
CONTRACTOR AGENT OWNER

PLANNING DEPT:

[Signature]

Date: 3-12-69

ENGINEERING DEPT:

Date:

BUILDING DEPT:

[Signature]

Date: 3-13-69

#1285

PERMIT NO: 46311

PERMIT FEE \$ 6.00

RECEIPT

48 \$006.00 - 8

CITY OF LAS VEGAS
DEPT. OF BUILDING & SAFETY

MUST BE MACHINE VALIDATED

13 MAR 69

Sharon Aguilar 3/3/81

DEPARTMENT OF BUILDING & SAFETY
CITY OF LAS VEGAS, NEVADA

INDEX CARD
& RETAINING
WALLS

OWNER Royes Petersen

DATE 3/13/69

CONTRACTOR Owner

PERMIT NO. 46311

LOT 5 BLOCK _____ SUBDIVISION Alta Vista #2
Block

Fence (wire, wood, etc.)

Walls (masonry, rock, etc.)

Location _____
Final Inspection _____

Location H B 3-13-65
Footing H B 3-12-69
Wall Steel 1st H B 3-12-69 2d _____ 3d _____
Final Inspection Boyle 3-12-69

Retaining Wall (masonry)

Retaining Wall (concrete)

Location _____
Footing _____
Wall Steel 1st _____ 2d _____ 3d _____
Bond Beam 1st _____ 2d _____ 3d _____
Final Inspection _____

Location _____
Footing _____
Wall Steel 1st _____ 2d _____ 3d _____
Final Inspection _____

23.14 B

ADDRESS 708 Canosa

LOG NO. _____

AREA _____

DEPT. of BLDG & SAFETY—CITY of LAS VEGAS, NEVADA
OWNER Mr. Peterson ADDRESS 708 Canosa DATE 5-28-65
GEN CONT. Owner TYPE OF STRUCTURE Storage RM
PERMIT NO. 30493 LEGAL DESCRIPTION Lot 5 block 3 Alta Vista

BUILDING		MECHANICAL		ELECTRICAL	
LOCATION		PLUMBING CONT.		TEMP POLE CONT.	
FIREPLACE FTS		PERMIT NO. _____ DATE _____		PERMIT NO. _____ DATE _____	
FOOTINGS		HEAT & VENT. AC CONT.		INSPECTION	DATE _____
FOUNDATION WALL		PERMIT NO. _____ DATE _____		ELECTRICAL CONT.	
FLOOR FRAMING		SEWER CONT.		PERMIT NO. _____ DATE _____	
SLAB		PERMIT NO. _____ DATE _____		FIXTURES CONT.	
CHIMNEY STEEL (FIREPLACE)		ROUGH SOL.		PERMIT NO. _____ DATE _____	
WALL STEEL		ROUGH WATER		SLAB	
COLUMN STEEL		TOP-OUT		ROUGH	
BEAM STEEL		ROUGH GAS		FINAL ROUGH	
FRAMING		AC ROUGH DUCT		FINAL FIXTURE	
ROOF SHEATHING	INTERIOR _____ EXTERIOR _____	REF. ROUGH PIPING		FINAL ELECTRICAL	
DRYWALL		FINAL PLUMBING		TEMPORARY SERVICE	
LATHING		FINAL GAS			
BACKING (SIDING)		FINAL AIR COND.			
PLASTER	SCRATCH _____ BROWN _____	FINAL REFRIG.			
URBAN REDEVELOPMENT APPROVAL		FINAL SEWER			
FINAL BLDG. <u>H W</u>	DATE <u>5-1-65</u>	FINAL SEPTIC TANK			

MISCELLANEOUS

GRADING & DRAINAGE _____
ON-SITE PARKING SPACES _____
ENG APPROVAL OF _____
OFF-SITE IMPROVEMENTS _____

APPROVED FOR OCCUPANCY (METER) _____

INSPECTOR _____

DATE _____

PLEASE NOTE REMARKS ON REVERSE SIDE

LOG # _____

AREA # _____

23.04

708 Canosa

Theresa Aquilino 3/3/81

DEPT. of BLDG. & SAFETY - CITY of LAS VEGAS, NEVADA

OWNER: ROYES J. PETERSON ADDRESS: 708 Canosa Ave. DATE: 9/30/59
 GEN. CONT. OWNER BUILDER TYPE OF STRUCTURE S. F. DWELLING
 PERMIT NO. 34582 LEGAL DESCRIPTION: Lot 5, Bl. 3, AltaVista Add. #2.

LOCATION & FLOOR ELEVATION	PLUMBING CONT. <u>Ritter</u>	TEMP. POLE CONT. <u>Fulzgrubel</u>
FOUNDINGS <u>Mullins 10-1-59</u>	PERMIT NO. <u>31614</u> DATE <u>10-2-59</u>	PERMIT NO. <u>25609</u> DATE <u>10-1-59</u>
FOUND & PIERS	HEAT & VENT. CONT.	INSPECTION <u>Smith</u> DATE <u>10-7-59</u>
WALL STEEL	PERMIT NO. _____ DATE _____	ELECTRICAL CONT. <u>Fulzgrubel</u>
BOND BEAM STEEL	SEWER CONT. <u>Ritter</u>	PERMIT NO. <u>25179</u> DATE <u>11-10-59</u>
FRAMING & ROOF SHEATHING	PERMIT NO. <u>31614</u> DATE <u>10-2-59</u>	OUTLETS <u>22</u>
STEEL FABRICATION	ROUGH SOIL <u>Bullseye 10-2-59</u>	MOTORS _____ H.P. _____
CONNECTIONS & PAINTING	ROUGH WATER	SLAB <u>Markel 11-9-59</u>
LATHING	SEWER OR SEPTIC TANK <u>Bullseye 11-5-59</u>	ROUGH ROUGH
PLASTER	TOP-OUT <u>Bullseye 12-29-59</u>	FINAL ROUGH
SCRATCH	ROUGH GAS	FIXTURE CONT. <u>Fulzgrubel</u>
BROWN	ROUGH DUCT	PERMIT NO. <u>25199</u> DATE <u>11-10-59</u>
FINAL BLDG <u>Best 5/3/60</u>	FINAL PLUMBING <u>Bullseye 12-5-59</u>	FIXTURES <u>23</u>
GRADING & DRAINAGE	FINAL HEATING	FINAL FIXTURE
ON-SITE PARKING _____ SPACES _____	FINAL GAS	APPROVED FOR METER <u>Markel 12-31-59</u>
ENG. APPROVAL OF _____		
OFF-SITE IMPROVEMENTS _____		

APPROVED for OCCUPANCY: _____ INSPECTOR _____ DATE _____

* PLEASE NOTE REMARKS ON REVERSE SIDE
708 Canosa Ave. DWELLING 9/30/59