

4131 BRADLEY

PORTION SE $\frac{1}{2}$ SW $\frac{1}{4}$ SEC 1 T20S R60E ZONE RE

D. Gatewood 1-29-79

CITY OF LAS VEGAS, NEVADA

7-10

LOG NO. & AREA _____ CONST. VAL. \$ N.V.

DEPARTMENT OF PUBLIC SERVICES
DIVISION OF BUILDING AND SAFETY

APPLICATION & BUILDING PERMIT - for:
Dwellings, Duplexes, Misc. Residential Const.

ADDRESS OF CONSTRUCTION: 4131 BRADLEY

OWNER: NANCY AUTEN

LOT: Partition 98145 Subdiv. Sec 17205 Block

ZONE: RE

Existing structure on lot: Dwelling Accessory Bldgs. Vacant Lot Other

PROPOSED CONSTRUCTION: TEMP. MOBILE HOME USE: TEMP. HOME

MATERIALS OF CONSTRUCTION: Wood Frame Concrete Block Reinforced Concrete Steel Frame

SQUARE FEET OF FLOOR AREAS: 1st _____ 2nd _____ 3rd _____ Other _____ TOTAL SQ. FT. _____

FIRE ZONE: _____ Occupancy Group _____ CONST. TYPE: _____

ARCHITECT: _____ ENGINEER: _____ NO. of UNITS _____ NO. of STORIES _____

Plans Submitted: Yes No Calculations Submitted: Yes No Sewer Fee Req'd.: Yes No

CONTRACTOR: _____ STATE LICENSE # _____ CITY LICENSE # _____

ADD'L. PERMITS REQ'D.: Air Cond. Elec. Plumbing Signs Paving Fence Public Walks Curb-gutters
Incinerators Fire Sprinkling System

Subject to removal
within one year
or upon completion
of house which ever
occurs first

CONDITIONS OF THE PERMIT:

1. I agree to call the City Building Department for inspections before concrete is poured, before rough wiring, electrical, plumbing, framing is covered. Also for Air conditioning, drywall and sheathing inspection.
2. I agree that when the job is completed that I will call for final inspection before occupancy.
3. I agree to perform all construction in accordance with City Ordinances and Building Codes.
4. The Contractor's signature below denotes authority from the owner to sign in his behalf and that the owner is aware of all requirements of this application and permit. Separate permits must be taken out for work outlined above this agreement.
5. I have read and understand the contents of this application and permit; I hereby state that the information I have supplied on this application is true and correct.

Approval for the work under this permit will be given only after refuse and debris have been removed from job site and public right of way.

SIGNED: _____ Contractor
BY: Nancy Auten Agent or Owner

PLANNING DEPT.: [Signature] Date: 6-7-77

PUBLIC WORKS DEPT.: [Signature] Date: 6-10-77

BUILDING DIVISION: [Signature] Date: 6-7-77

PERMIT NO.: 3225 PERMIT FEE \$ 5.00

154-01-220

RECEIPT

2423 \$005.00 -

CITY OF LAS VEGAS
DEPT. OF
MUST BE BUILDING SAFETY

10 JUN 77

M. Gatewood 1-29-79.

CITY OF LAS VEGAS, NEVADA

DEPARTMENT OF BUILDING & SAFETY - AIR CONDITIONING APPLICATION & PERMIT

ADDRESS OF CONSTRUCTION: 4131 BRADLEY OWNER'S NAME: NANCY AUTEN

CIRCLE: Addition; Remodel; New Bldg. TYPE OF BLDG.: SFD APT. COMM. PUBLIC

CONTRACTOR'S NAME: OWNER STATE LICENSE # _____ CITY LICENSE # _____

UNITS	DESCRIPTION	FEE	TOTAL	UNITS	DESCRIPTION	FEE	TOTAL
	Unit heater - floor, wall or suspended	4.00			EVAPORATIVE COOLERS:		
	FOR EACH FORCED-AIR OR GRAVITY-TYPE FURNACE OR BURNER INCLUDING DUCTS AND VENT ATTACHED TO SUCH APPLIANCES:				5 outlets or under	3.00	
	Up to and including 100,000 B.t.u.'s	4.00			Over 5 and up to and including 10	5.00	
	Over 100,000 B.t.u.'s	6.00			Each additional outlet over 10	.25	
	FOR EACH HEATING APPLICATION, REFRIGERATION UNIT, COMFORT COOLING AND HEATING UNIT, ABSORPTION UNIT, COMPRESSOR OR BOILER:				VENTILATION:		
	Up to and including 3 ton or horsepower, or absorption system up to and including 100,000 B.t.u.'s	4.00		<u>2</u>	For each fan connected to a single duct	1.00	<u>2.00</u>
<u>1</u>	Over 3 ton or 3 horsepower up to and including 10, or absorption system over 100,000 B.t.u.'s up to and including 250,000 B.t.u.'s	7.00	<u>7.00</u>		For each commercial or industrial ventilation system	5.00	
	Over 10 ton or 10 horsepower up to and including 30, or absorption system over 250,000 B.t.u.'s up to and including 1,000,000 B.t.u.'s	12.00			For each commercial kitchen hood	5.00	
	Over 30 ton or 30 horsepower up to and including 50, or absorption system over 1,000,000 B.t.u.'s up to and including 1,700,000 B.t.u.'s	20.00			MISCELLANEOUS:		
	Over 50 ton or 50 horsepower, or absorption system over 1,700,000 B.t.u.'s	30.00			For each water cooling tower	8.00	
	FOR EACH AIR HANDLING UNIT INCLUDING DUCTS ATTACHED THERETO:				Duct work only - each opening	.25	
	Up to and including 10,000 CFM	2.00			For installation or relocation of each commercial or industrial incinerator	15.00	
	Over 10,000 CFM	4.00			Gas piping related to the air cond. work in single family dwelling only	3.00	
					For each appliance, piece of equipment, any mechanical work or alteration or replacement not included in this schedule, the permit fee shall be computed the same as building permit fees by using the cost of installation for the valuation amount.		
					FOR THE ISSUANCE OF EACH PERMIT		<u>3.00</u>
					TOTAL PERMIT FEE \$		<u>112.00</u>

I hereby certify that I have carefully examined and read the above application; that the same is true and correct; and that the work herein described is to be done in accordance with all the provisions of the applicable Ordinances of the City of Las Vegas, Nevada and the State Laws, whether herein specified or not.

Approval for the work under this permit will be given only after refuse and debris have been removed from job site and public right of way.

SIGNED Nancy Auten Date 6-10-77
Air Conditioning Contractor - Owner

BUILDING DEPARTMENT R. Bailey Date 6-7-77

PERMIT NO. 777 PERMIT FEE \$ 112.00

RECEIPT
2426 \$012.00 -

CITY OF LAS VEGAS
DEPT. OF
BUILDING & SAFETY

MUST BE MACHINE VALIDATED
10 JUN 77

#12890

D. Gatewood 1-29-79

CITY OF LAS VEGAS, NEVADA

DEPARTMENT OF PUBLIC SERVICES—ELECTRICAL APPLICATION & PERMIT DIVISION OF BUILDING AND SAFETY

ADDRESS OF CONSTRUCTION: 4131 BRADLEY

OWNER'S NAME: NANCY AUTEN

CIRCLE: New Bldg Add'n.; Remodel; TYPE OF BLDG.: SFD. APT. PUBLIC COMM.

CONTRACTOR'S NAME: OWNER

STATE LICENSE #

CITY LICENSE #

NUMBER	FIXTURE OR INSTALLATION	UNIT PRICE	TOTAL
	Rm addition, carport or garage enclosure	4.00	
	Temporary power	4.00	4.00
<u>60</u>	Light, receptacle or switch outlet	.20	12.00
	Wall or ceiling space heater	.35	
<u>1</u>	Garbage grinder outlet	.35	.35
<u>1</u>	Dishwasher outlet	.35	.35
<u>1</u>	Clothes dryer outlet	.35	.35
<u>1</u>	Automatic clothes washer	.35	.35
<u>1</u>	Electric range outlet	.35	.35
<u>1</u>	Electric water heater outlet	.35	.35
	Special purpose outlet	.35	
	X-ray unit and its appurtenances	5.00	
	Watts of festoon lighting (Watts) First 3,000 watts for each additional thousand watts	4.00 1.50	
	Horsepower each motor first horsepower or less for each additional horsepower	1.75 .35	
	Electric service (including any single meter socket) for each additional socket	3.00 .35	1.300
	Air conditioning service	1.50	1.50
	Each KW(KVA) Generator (Transformer, Welder) First 100 KVA for each additional KW(KVA)	2.00 .01	
	Speaker, signal or alarm outlet	.15	
	Amplifiers	.50	
	Control panels	.25	
	Main control racks	1.00	
	T.V. and radio antennas-master system only	.75	
	Minimum fee for any permit	4.00	
	TOTAL FEE		22.60

Approval for the work under this permit will be given only after refuse and debris have been removed from job site and public right of way.

I hereby certify that I have carefully examined and read the above application; that the same is true and correct; and that the work herein described is to be done in accordance with all the provisions of the applicable Ordinances of the City of Las Vegas, Nevada and State laws whether herein specified or not.

SIGNED Nancy Auten
MASTER (ELECTRICIAN) (TECHNICIAN) (OWNER)

DATE 6-10-77

BUILDING DIVISION: Al Bailey

DATE 6-7-77

PERMIT NO. 2792

PERMIT FEE \$ 22.60

RECEIPT

2425 \$022.60

CITY OF LAS VEGAS

DEPT. OF BUILDING & SAFETY
MUST BE MACHINE VALIDATED

10.10.77

D. Gatewood 1-29-79

CITY OF LAS VEGAS, NEVADA

DEPARTMENT OF PUBLIC SERVICES - APPLICATION AND PERMIT FOR PLUMBING
 DIVISION OF BUILDING AND SAFETY

ADDRESS OF CONSTRUCTION: 4131 BRADLEY OWNER'S NAME: NANCY AUTEN

CIRCLE: New Bldg. Add'n.; Remodel; TYPE OF BLDG.: SFD. APT. PUBLIC COMM.

CONTRACTOR'S NAME: OWNER STATE LICENSE # _____ CITY LICENSE # _____

UNITS	DESCRIPTION	FEE	TOTAL
1	Bathtub	1.00	100
1	Shower	1.00	100
2	Lavatory	1.00	200
2	Toilet	1.00	200
	Urinal	1.00	
	Floor Drain	1.00	
	Floor Sink	1.00	
	Wash Tray	1.00	
1	Sink	1.00	100
1	Garbage Disposal	1.00	100
	Garbage Disposal (comm.)	3.00	
	Clothes Dryer (gas)	1.00	
1	Clothes Washer	1.00	100
	Clothes Washer (comm.)	5.00	
1	Dishwasher	1.00	100
	Dishwasher (commercial)	5.00	
	Dental Unit	10.00	
	Drinking Fountain	1.00	
	Any Water using Equipment	1.00	
	Water Heater (gas) (elect.)	1.00	
1	Sewer System - New, Replacement, or any Drainage System	4.00	400
	Grease or Sand Trap	2.00	
1	Trailer Trap	2.00	200
1	Septic Disposal System	4.00	400
WATER SOFTENERS			
1	Nonpermanent Type	4.00	400
	Permanent Type (connected to Drainage)	5.00	
SWIMMING POOLS			
	Private or Wading Pool	10.00	
	Public or Semi-public	20.00	

UNITS	DESCRIPTION	FEE	TOTAL
WATER DISTRIBUTION SYSTEM			
1	Single Family Dwelling	4.00	400
	Multiple Family Dwelling plus each unit	4.00 2.00	
	Commercial Bldg. per floor	6.00	
	Hotel or Motel plus each bath	4.00 1.50	
	Trailer Park plus each space	20.00 1.00	
	Irrigation	4.00	
GAS PIPING SYSTEM			
	Single Family Dwelling	3.00	
	Multiple Family Dwelling plus each unit	6.00 1.00	
	Commercial Bldg. per floor plus each unit	3.00 3.00	
	Gas Appliance (any type)	1.00	
AUTOMATIC FIRE EXTINGUISHING SYSTEM			
	Underground Piping	10.00	
	Distribution Piping ea. ft.	.01	
	Sprinkler Head each	10	
	In Range Hood and Vent	5.00	
DRY STANDPIPE SYSTEM			
	Piping	50.00	
	Each Outlet	1.00	
WET STANDPIPE SYSTEM			
	Piping	5.00	
	Fire Hose Cabinet	1.00	
	MINIMUM PERMIT FEE	4.00	
PIPELINE CONTRACTOR; SECT. 14-B.P.F. \$			
TOTAL PERMIT FEE \$			<u>2800</u>

I hereby certify that I have carefully examined and read the above application; that the same is true and correct; and that the work herein described is to be done in accordance with all the provisions of the applicable Ordinances of the City of Las Vegas, Nevada and the State Laws, whether herein specified or not.

Approval for the work under this permit will be given only after refuse and debris have been removed from job site and public right of way.

Signed Nancy Auten Date: 6-10-77
 Registered Master Plumber, Spec. Contr. or Owner

Building Division: H. Bailey Date: 6-7-77

Permit No. 2079 Permit Fee \$ 2800

154-01-222

RECEIPT
 2424 \$028.00 -
 CITY OF LAS VEGAS
 DEPT. OF BUILDING SAFETY
 MUST BE MACHINE VALIDATED
 10 JUN 77

D. Gatewood 1-29-79

CITY OF LAS VEGAS, NEVADA

1-18

LOG NO. & AREA R62-3

CONST. VAL. \$ 34990.00

DEPARTMENT OF PUBLIC SERVICES
DIVISION OF BUILDING AND SAFETY

APPLICATION & BUILDING PERMIT - for:
Dwelling, Duplexes, Misc. Residential Const.

ADDRESS OF CONSTRUCTION: 4131 Bradley

OWNER: Nancy Auten

LOT(S) SEE ATTACHED BLOCK _____ SUBDIVISION _____

ZONE: RE

Existing structure on lot: Dwelling Accessory Bldgs. Vacant Lot Other

PROPOSED CONSTRUCTION: SINGLE FAMILY DWELLING W FP RES

MATERIALS OF CONSTRUCTION: Wood Frame Concrete Block Reinforced Concrete Steel Frame

SQUARE FEET OF FLOOR AREAS: 1st 1443 2nd CAR 530 3rd _____ Other _____ TOTAL SQ. FT. _____

FIRE ZONE: _____ Occupancy Group _____ CONST. TYPE: _____

ARCHITECT: _____ ENGINEER: _____ NO. of UNITS _____ NO. of STORIES _____

Plans Submitted: Yes No Calculations Submitted: Yes No Sewer Fee Req'd. Yes No Septic # 57449

CONTRACTOR: OWNER STATE LICENSE # _____ CITY LICENSE # _____

ADD'L. PERMITS REQ'D.: Air Cond. Elec. Plumbing Signs Paving Fence Public Walks Curb-gutter
Incinerators Fire Sprinkling System

Pollution Contract 2640

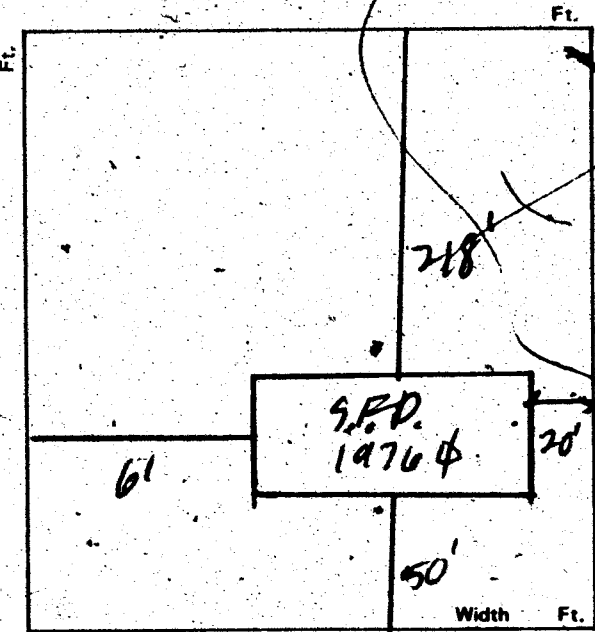

CONDITIONS OF THE PERMIT:

1. I agree to call the City Building Department for inspections before concrete is poured, before rough wiring, electrical, plumbing, framing is covered. Also for Air conditioning, drywall and sheathing inspection.
2. I agree that when the job is completed that I will call for final inspection before occupancy.
3. I agree to perform all construction in accordance with City Ordinances and Building Codes.
4. The Contractor's signature below denotes authority from the owner to sign in his behalf and that the owner is aware of all requirements of this application and permit. Separate permits must be taken out for work outlined above this agreement.
5. I have read and understand the contents of this application and permit; I hereby state that the information I have supplied on this application is true and correct.

Approval for the work under this permit will be given only after refuse and debris have been removed from job site and public right of way.

SIGNED: _____ Contractor

BY: Nancy Auten Agent or Owner

BRADLEY

PLANNING DEPT.: [Signature] Date: 6-1-77

PUBLIC WORKS DEPT.: [Signature] Date: 6-10-77

BUILDING DIVISION: [Signature] Date: 6-7-77

PERMIT NO.: 3226 PERMIT FEE \$ 196.50

154-01-220

RECEIPT

2422 \$196.50 -

CITY OF LAS VEGAS
DEPT. OF
BUILDING & SAFETY
MUST BE MACHINE VALIDATED

1-0 JUN 77

D. Gatewood 1-29-79

**BUILDING DEPARTMENT
CITY OF LAS VEGAS**

CORRECTION NOTICE

Job Located at 4131 BRADLEY

I have this day inspected this structure and these premises and have found the following violations of City and/or State laws governing same:

CORRECTED 2-8-78 J.V. Gandy

- 1. WIRING FROM JUNCTION BOX TO PRESSURE SW. ON WELL PUMP SHALL BE IN SEAL TIGHT FLEX. WITH WEATHER PROOF CONNECTORS
- 2. WIRE FROM HOUSE TO WELL SHALL BE IN CONDUIT AND 18" IN GROUND ALSO RUN GROUND WIRE TO WELL CASING TO GROUND BACK TO SERVICE
- 3. HANDY BOX AT WELL NEEDS W.P.

You are hereby notified to correct above violation and call for re-inspection.

Date 1-20-78 J.V. Gandy
Inspector

10-DAYS TO CORRECT

23.03 Do not remove this tag!

Staten 7-30-77
1-17-81

CITY OF LAS VEGAS, NEVADA

LOG NO. & AREA: **M-8-5** APPLICATION & BUILDING PERMIT for: **44967**
 DEPARTMENT OF PUBLIC SERVICES: **CITY OF LAS VEGAS, NEVADA**
 DIVISION OF BUILDING AND SAFETY: **DEPARTMENT OF BUILDING & SAFETY - AIR CONDITIONING APPLICATION & PERMIT**
 ADDRESS OF CONSTRUCTION: **413 BRADLEY BLVD. NEW YORK, N.Y. 10017** OWNER: **NANCY DIMICK**
 ADDRESS OF CONSTRUCTION: **413 BRADLEY BLVD. NEW YORK, N.Y. 10017** OWNER: **NANCY DIMICK**
 PROPOSED CONSTRUCTION: **MOTOR HOME GARAGE W/ WOODWORK AND AIR CONDITIONING**
 MATERIALS: **WASH STATE AIR CONDITIONING** LICENSE # **10196**

SQUARE FEET	UNITS	DOOR AREAS	DESCRIPTION	2nd	FEE	3rd	TOTAL	UNITS	DESCRIPTION	FEE	TOTAL
			Unit water - floor, wall or ceiling		4.00				EVAPORATIVE COOLERS: CONST. TYPE:		
			FOR EACH FORCED AIR OR GRAVITY TYPE FURNACE OR BURNER INCLUDING DUCTS AND VENT ATTACHED TO SUCH APPLIANCES: ENGINEER						5 outlets or under	3.00	
			Up to and including 100,000 B.t.u.'s		4.00			Over 5' high up to and including 10'	NO. OF STOREYS	5.00	
			Over 100,000 B.t.u.'s		6.00			Each equipped outlet over 10'	Yes <input type="checkbox"/> No <input checked="" type="checkbox"/>	25	
			FOR EACH HEATING APPLICATION, REFRIGERATION UNIT, ABSORPTION UNIT, COMPRESSOR OR BOILER:						VENTILATION		
			Up to and including 3 ton of horsepower or absorption system up to and including 100,000 B.t.u.'s		4.00				For each commercial or industrial walk-in refrigeration system	1.00	
			Over 3 ton or 30 horsepower up to and including 10' or absorption system, over 100,000 B.t.u.'s up to and including 250,000 B.t.u.'s		7.00				For each commercial kitchen hood	5.00	
			Over 10 ton or 10 horsepower up to and including 20' or absorption system over 250,000 B.t.u.'s up to and including 1,000,000 B.t.u.'s		12.00				MISCELLANEOUS CONDITIONS OF THE PERMIT		
			Over 30 ton or 30 horsepower up to and including 50' or absorption system over 1,000,000 B.t.u.'s up to and including 1,700,000 B.t.u.'s		20.00				For each water cooling tower	8.00	concrete
			Over 50 ton or 50 horsepower up to and including 1,000,000 B.t.u.'s up to and including 1,700,000 B.t.u.'s		30.00				Duct work only in each opening plumbing, framing is covered.	2.50	
			FOR EACH AIR HANDLING UNIT IN BUILDING DUCTS ATTACHED THERETO:						For installation or relocation of each commercial or industrial refrigerator I will call for inspection	15.00	
			Up to and including 10,000 CFM		1.00				Gas piping related to the air cond. work in single family dwellings only accordance with ordinances	3.00	
			Over 10,000 CFM		1.00				For each appliance, piece of equipment, any mechanical work or alteration or replacement not included in this schedule. The permit fee equipment of this shall be completed the same as building permit but work out will rest by being the cost of installation for the valuation amount.	3.00	
									FOR THE ISSUANCE OF EACH PERMIT	3.00	
									TOTAL PERMIT FEE		

EXISTING: I certify that I have carefully examined and read the above application, that the same is true and correct, and that the work herein described is to be done in accordance with all the provisions of the applicable Ordinance of the City of Las Vegas, Nevada and the State of Nevada, and that I am a duly licensed contractor.

SIGNED: *[Signature]* BY: *[Signature]* DATE: **Sept. 14, 1977**

BUILDING DEPARTMENT: **9-14-77**
 PLANNING DEPT.: **14-30-81**
 PUBLIC WORKS DEPT.: **12**
 BUILDING DEPT. PERMIT NO. **12**
 BUILDING DEPT. PERMIT NO. **12**

RECEIVED: **01/15/81**
 CITY OF LAS VEGAS
 DEPT. OF BUILDING & SAFETY
 MACHINE VALIDATED

Theresa Kyriakos 2-19-81

DIVISION of BUILDING & SAFETY - CITY of LAS VEGAS, NEVADA

OWNER Nancy Auten ADDRESS 4131 Bradley DATE 6-7-77
GEN. CONT. Owner TYPE OF STRUCTURE Temp mobile home
PERMIT NO. 3225 LEGAL DESCRIPTION

BUILDING	MECHANICAL	ELECTRICAL
Investigation	Plumbing Cont.	Temp. pole cont.
Location & Footing	Permit No. _____ Date _____	Permit No. _____ Date _____
Stem Wall	Heat & Vent. A/C Cont.	Inspection _____ Date _____
Concrete Slab Floor	Permit No. _____ Date _____	Electrical Cont.
Floor Framing	Sewer Cont.	Permit No. _____ Date _____
Fireplace Footing	Permit No. _____ Date _____	Fixtures Cont.
Chimney Steel	Rough Soil	Permit No. _____ Date _____
Vert. Steel Reinf.	Rough Water	Slab
Horiz. Steel Reinf.	Top-Out	Rough
Roof Sheathing	Rough Gas	Final Rough
Framing	A/C Rough Duct	Final Fixture
Backing for siding	Ref. Rough Piping	Final Electrical
Ext. Lath	Final Plumbing <i>HW 1-20-78</i>	Temporary Service
Ext. Scratch	Final Gas	MISCELLANEOUS
Ext. Brown	Final Air Cond. <i>HW 1-20-78</i>	Grading & Drainage
Int. Lath	Final Refrig.	On-Site Parking Spaces _____ App. _____
Int. Brown	Final Sewer	Eng. Approval of _____
Drywall	Final Septic Tank	Off-Site Improvements
Insulation		
Final Building		
Appr. for Occu.		

INSPECTOR: _____ DATE _____

APPROVED FOR OCCUPANCY & METER _____

PLEASE NOTE REMARKS ON REVERSE SIDE 4131 Bradley LOG # _____ AREA # _____ 76-11-4

DIVISION of BUILDING & SAFETY - CITY of LAS VEGAS, NEVADA

OWNER Nancy Auten ADDRESS 4131 Bradley DATE 6-10-77
GEN. CONT. Owner TYPE OF STRUCTURE SFD w-tp
PERMIT NO. 3226 LEGAL DESCRIPTION see application

BUILDING	MECHANICAL	ELECTRICAL
Investigation	Plumbing Cont. Owner	Temp. pole cont. Owner
Location & Footing <i>AG 7-27-77</i>	Permit No. 2089 Date _____	Permit No. 2742 Date _____
Stem Wall	Heat & Vent. A/C Cont. Owner <i>HW 1-20-78</i>	Inspection _____ Date _____
Concrete Slab Floor <i>AG 7-27-77</i>	Permit No. 111-1315 Date 9-13-77	Electrical Cont. Owner
Floor Framing	Sewer Cont.	Permit No. 2742 Date _____
Fireplace Footing	Permit No. _____ Date _____	Fixtures Cont.
Chimney Steel	Rough Soil <i>KW 7-26-77</i>	Permit No. _____ Date _____
Vert. Steel Reinf.	Rough Water <i>KW 7-26-77</i>	Slab
Horiz. Steel Reinf.	Top-Out <i>KW 10-7-77</i>	Rough <i>AG 10-13-77</i>
Roof Sheathing <i>RP 9-21-77</i>	Rough Gas	Final Rough
Framing <i>SE 10-17-77</i>	A/C Rough Duct <i>KW 9-14-77</i>	Final Fixture
Backing for siding	Ref. Rough Piping	Final Electrical <i>AG 1-31-78</i>
Ext. Lath	Final Plumbing <i>KW 1-20-78</i>	Temporary Service <i>AG</i>
Ext. Scratch	Final Gas	MISCELLANEOUS
Ext. Brown	Final Air Cond. <i>KW 1-20-78</i>	Grading & Drainage
Int. Lath	Final Refrig.	On-Site Parking Spaces _____ App. _____
Int. Brown	Final Sewer	Eng. Approval of _____
Drywall <i>SE 11-4-77</i>	Final Septic Tank	Off-Site Improvements
Insulation		
Final Building		
Appr. for Occu.		

INSPECTOR: _____ DATE _____

APPROVED FOR OCCUPANCY & METER *SE 1-26-78*

PLEASE NOTE REMARKS ON REVERSE SIDE 4131 Bradley LOG # _____ AREA # _____ R 62-3 76-11-4

Donna Huesly

3-8-83

OWNER <u>Vernon Dimick</u> ADDRESS <u>4131 Bradley Road</u>	
DATE <u>1-15-81</u>	GEN. CONT. <u>Kal Construction</u>
MOTOR HOME Garage w/woodwork 7965	
TYPE OF STRUCTURE	PERMIT NO. <u>7965</u>
LEGAL DESCRIPTION <u>N¹/4, NE¹/4, NW¹/4, SE¹/4, S1, T20S, R6E, N-18-3</u>	
APPROVED FOR OCCUPANCY & METER	
BUILDING	MECHANICAL
Investigation	Plumbing Cont.
Location & Footing	Permit No. Date
Concrete Slab Floor	Heat & Vent. A/C Cont.
Fireplace Footing	Permit No. Date
Chimney Stack	Sewer Cont.
Vert. Steel Rainf.	Permit No. Date
Horiz. Steel Rainf.	Rough Soil
Framing	Rough Water
Ext. Lath	Top-Out
Ext. Brown	Rough Gas
Drywall	A/C Rough Duct
Final Building	Final Plumbing
Appr. for Occu.	Final Gas
ELECTRICAL	
Temp. Pole Cont.	Final Air Cond.
Permit No. Date	Final Sewer
Inspection Date	REMARKS
Electrical Cont.	
Permit No. Date	
Rough _s	PLEASE NOTE ADDITIONAL REMARKS ON REVERSE SIDE.
Final Rough	DIV. OF BLDG. & SAFETY
Final Electrical	CITY OF LAS VEGAS
Temporary Service	REV 10-78
	79-3-16