

809 ANTIGUA ST.

LOT 6 BLK 4 CHRLESTON RAINBOW 9-EZONE R-1

Sproul Homes, 1979

CITY OF LAS VEGAS, NEVADA

LOG NO. & AREA T-24-4 1969 CONST. VAL. \$ 19,228.00

DEPARTMENT OF BUILDING & SAFETY

APPLICATION & BUILDING PERMIT - for:
Dwellings, Duplexes, Misc. Residential Const.

ADDRESS OF CONSTRUCTION 809 Antigua Street

OWNER: Sproul Homes of Nevada

LOT(s) 6 BLOCK 4 SUBDIVISION Charleston Rainbow 9-E ZONE R-7

Existing structure on lot: Dwelling Accessory bldgs. Vacant lot Other

PROPOSED CONSTRUCTION: Single Family Dwelling USE: Same

MATERIALS OF CONSTRUCTION: Wood Frame Concrete Block Reinforced Concrete Steel Frame

SQUARE FEET OF FLOOR AREAS: 1st / 2nd / 3rd / Other / TOTAL SQ. FT.

FIRE ZONE: 1 2 3 Occupancy Group A B C D E F G H I J, 2-3-4-5 CONST. TYPE: I II III IV V

ARCHITECT: ENGINEER: NO. of UNITS NO. of STORES

Plans Submitted: Yes No Calculations Submitted: Yes No Sewer Fee Req'd. Yes No

CONTRACTOR: Sproul Homes of Nevada STATE LICENSE # 6001B CITY LICENSE # 6427

ADD'L. PERMITS REQ'D.: Air Cond. Elec. Plumbing Signs Paving Fence Public Walks Curb-gutters
Incinerators Fire Sprinkling System

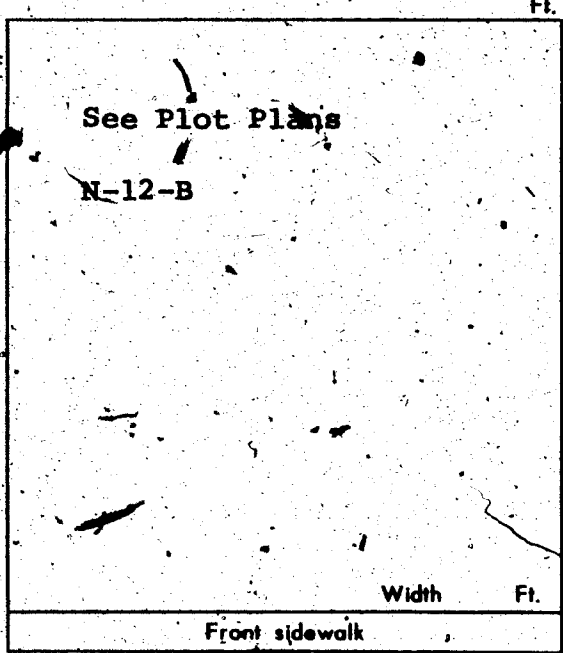

CONDITIONS OF THE PERMIT:

- I agree to call the City Building Department for inspections before concrete is poured, before rough wiring, electrical, plumbing, framing is covered. Also for Air conditioning, sheet-rock and sheathing inspection.
- I agree that when the job is completed that I will call for final inspection before occupancy.
- I agree to perform all construction in accordance with City Ordinances and Building Codes.
- The Contractor's signature below denotes authority from the owner to sign in his behalf and that the owner is aware of all requirements of this application and permit. Separate permits must be taken out for work outlined above this agreement.
- I have read and understand the contents of this application and permit; I hereby state that the information I have supplied on this application is true and correct.

SIGNED: SPROUL HOMES OF NEVADA Contractor

BY: Fredrick C. Roach Agent or Owner

Date 11-25-69

CLARK COUNTY HEALTH DEPT.

LAS VEGAS FIRE DEPARTMENT

PLANNING DEPT: [Signature] Date: 12/16/69

PUBLIC WORKS DEPT: [Signature] Date: 12-16-69

BUILDING DEPT: [Signature] Date: 12-16-69

*12850 PERMIT NO. 50405 PERMIT FEE \$ 66.00

RECEIPT
6285 \$066.00 - 8

CITY OF LAS VEGAS
DEPT. OF BUILDING & SAFETY

MUST BE MACHINE VALIDATED
8 DEC 69

W. Jones Jan 2, 1979

CITY OF LAS VEGAS; NEVADA
DEPARTMENT OF BUILDING & SAFETY

SEWER CONNECTION FEE: \$150.00

RECEIPT
for
SEWER CONNECTION FEE

JOB ADDRESS: 809 Antigua Street OWNER'S NAME: Sproul Homes of Nevada

LOT 6 BLOCK 4 SUBDIVISION Charleston Rainbow 9-E

QUANTITY	OCCUPANCY	UNIT FEE	AMOUNT
1	Sewer Connection fee for SFD		150.00

TOTAL _____
 Less Credit* _____
 TOTAL FEE \$ 150.00

*Credit for existing sewer is applied to the new sewer connection fee based on previous type of occupancy and only when the new occupancy requires an additional fee.
 This receipt does not authorize the owner or his representative to start any work without obtaining a plumbing permit.

[Signature]
 DEPARTMENT OF BUILDING & SAFETY DATE 12-17-78

Receipt
 6286 \$150.00 - 3
 CITY OF LAS VEGAS
 DEPT. OF BUILDING & SAFETY

73102 RECEIPT NO. 29941

W. J. Jones 1979

CITY OF LAS VEGAS, NEVADA

DEPARTMENT OF BUILDING & SAFETY - AIR CONDITIONING APPLICATION & PERMIT

ADDRESS OF CONSTRUCTION: 809 Antigua Street OWNER'S NAME: SPROUT HOMES OF NEVADA

CIRCLE: Addition; Remodel; (New Bldg.) TYPE OF BLDG.: (R) APT. COMM. PUBLIC

CONTRACTOR'S NAME: E. E. SHERRING AIR COND. CO., INC. STATE LICENSE 6058 CITY LICENSE 2

UNITS	DESCRIPTION	FEE	TOTAL	UNITS	DESCRIPTION	FEE	TOTAL
	Unit heater-floor, wall or suspended	4.00					
	FOR EACH FORCED-AIR OR GRAVITY-TYPE FURNACE OR BURNER INCLUDING DUCTS AND VENT ATTACHED TO SUCH APPLIANCES:				EVAPORATIVE COOLERS:		
	Up to and including 100,000 B.t.u.'s	4.00			5 outlets or under	2.00	
	Over 100,000 B.t.u.'s	6.00			Over 5 and up to and including 10	5.00	
	FOR EACH HEATING APPLICATION, REFRIGERATION UNIT, COMFORT COOLING AND HEATING UNIT, ABSORPTION UNIT, COMPRESSOR OR BOILER:				Each additional outlet over 10	.25	
	Up to and including 3 ton of horsepower, or absorption system up to and including 100,000 B.t.u.'s	4.00	4.00		VENTILATION:		
	Over 3 ton or 3 horsepower up to and including 10, or absorption system over 100,000 B.t.u.'s up to and including 250,000 B.t.u.'s	7.00			For each fan connected to a single duct	1.00	2.00
	Over 10 ton or 10 horsepower up to and including 30, or absorption system over 250,000 B.t.u.'s up to and including 1,000,000 B.t.u.'s	12.00			For each commercial or industrial ventilation system	5.00	
	Over 30 ton or 30 horsepower up to and including 50, or absorption system over 1,000,000 B.t.u.'s up to and including 1,700,000 B.t.u.'s	20.00			For each commercial kitchen hood	5.00	
	Over 50 ton or 50 horsepower, or absorption system over 1,700,000 Btu's	30.00			MISCELLANEOUS:		
	FOR EACH AIR HANDLING UNIT INCLUDING DUCTS ATTACHED THERETO:				For each water cooling tower	8.00	
	Up to and including 10,000 CFM	2.00			Duct work only - each opening	.25	
	Over 10,000 CFM	4.00			For installation or relocation of each commercial or industrial incinerator	15.00	
					Gas piping related to the air cond. work in single family dwelling only	3.00	
					For each appliance, piece of equipment, any mechanical work or alteration or replacement not included in this schedule, the permit fee shall be computed the same as building permit fees by using the cost of installation for the valuation amount.		
					FOR THE ISSUANCE OF EACH PERMIT		3.00
					TOTAL PERMIT FEE \$		2.00

I hereby certify that I have carefully examined and read the above application; that the same is true and correct; and that the work herein described is to be done in accordance with all the provisions of the applicable Ordinances of the City of Las Vegas, Nevada and the State Laws, whether herein specified or not.

SIGNED *[Signature]* Date 12-29-69
Air Conditioning Contractor - Owner

BUILDING DEPARTMENT *[Signature]* Date 12-29-69
PERMIT NO. 28332 PERMIT FEE \$ 9.00

RECEIPT

6685: \$009.00 - 4

CITY OF LAS VEGAS
DEPT. OF BUILDING & SAFETY

MUST BE MACHINE VALIDATED

3 0 0 0 0 0

812890

2/10/70 1970

CITY OF LAS VEGAS, NEVADA

DEPARTMENT OF BUILDING & SAFETY - APPLICATION AND PERMIT FOR PLUMBING

ADDRESS OF CONSTRUCTION: 809 ANTIQUA ST.

OWNER'S NAME: SPRING HATTIES, INC.

CIRCLE: (New Bldg) Add'n; Remodel; TYPE OF BLDG.: (SFD) APT. PUBLIC COMM.

CONTRACTOR'S NAME: UNITED PLUMBING

STATE LICENSE # 1295

CITY LICENSE # 907

UNITS	DESCRIPTION	FEE	TOTAL
1	Bathtub	1.00	1-
1	Shower	1.00	1-
3	Lavatory	1.00	3-
2	Toilet	1.00	2-
	Urinal	1.00	
	Floor Drain	1.00	
	Floor Sink	1.00	
	Wash Tray	1.00	
1	Sink	1.00	1-
	Garbage Disposal	1.00	
	Garbage Disposal (comm.)	3.00	
	Clothes Dryer (gas)	1.00	
1	Clothes Washer	1.00	1-
	Clothes Washer (comm.)	5.00	
	Dishwasher	1.00	
	Dishwasher (commercial)	5.00	
	Dental Unit	10.00	
	Drinking Fountain	1.00	
	Any Water using Equipment	1.00	
	Water Heater (gas) (elect.)	1.00	1-
1	Sewer System - New, Replacement, or any Drainage System	4.00	4-
	Grease or Sand Trap	2.00	
	Trailer Trap	2.00	
	Septic Disposal System	4.00	
WATER SOFTENERS			
	Nonpermanent Type	4.00	
	Permanent Type (connected to Drainage)	5.00	
SWIMMING POOLS			
	Private or Wading Pool	10.00	
	Public or Semi-public	20.00	

UNITS	DESCRIPTION	FEE	TOTAL
WATER DISTRIBUTION SYSTEM			
1	Single Family Dwelling	4.00	4-
	Multiple Family Dwelling plus each unit	4.00	
		2.00	
	Bldg. Group "A" thru "G" per each floor	6.00	
	Hotel or Motel plus each bath	4.00	
		1.50	
	Trailer Park plus each space	20.00	
		1.00	
	Irrigation	4.00	
GAS PIPING SYSTEM			
1	Single Family Dwelling	3.00	3-
	Multiple Family Dwelling plus each unit	6.00	
		1.00	
	Commercial Bldg. per floor plus each unit	3.00	
		2.00	
	Gas Appliance (any type)	1.00	
AUTOMATIC FIRE EXTINGUISHING SYSTEM			
	Underground Piping	10.00	
	Distribution Piping ea. ft.	.01	
	Sprinkler Head each	.10	
	In Range Hood and Vent	5.00	
DRY STANDPIPE SYSTEM			
	Piping	50.00	
	Each Outlet	1.00	
WET STANDPIPE SYSTEM			
	Piping	5.00	
	Fire Hose Cabinet	1.00	
	MINIMUM PERMIT FEE	4.00	
TOTAL PERMIT FEE \$ 21-			

I hereby certify that I have carefully examined and read the above application; that the same is true and correct; and that the work herein described is to be done in accordance with all the provisions of the applicable Ordinances of the City of Las Vegas, Nevada and the State Laws, whether herein specified or not.

Signed: [Signature] REGISTERED MASTER PLUMBER, SPEC. CONT'R., OR OWNER

Date: 12-12-69

Building Department: [Signature]

Date: 1-8-70

#12870

Permit No. 28944

Permit Fee \$ 21.00

RECEIPT
7196 \$021.00 - 7
CITY OF LAS VEGAS
DEPT. OF BUILDING & SAFETY
MUST BE MACHINE VALIDATED
- 9 JAN 70

W. Jones Jan 1929

CITY OF LAS VEGAS, NEVADA

DEPARTMENT OF BUILDING & SAFETY - ELECTRICAL APPLICATION & PERMIT

ADDRESS OF CONSTRUCTION: 809 Antigua St. OWNER'S NAME: Special Home

CIRCLE: New Bldg. Add'n; Remodel; TYPE OF BLDG: SFD. APT. PUBLIC COMM.

CONTRACTOR'S NAME: Robert E. Linton STATE LICENSE # 1528 CITY LICENSE # 3392

NUMBER	FIXTURE OR INSTALLATION	UNIT PRICE	
15	Fixture or sockets	.15	225
47	Light, receptacle or switch outlet	.20	940
	Wall or ceiling space heater	.35	
	Blast coil heater per kilowatt	.35	
1	Garbage grinder outlet	.35	35
	Dishwasher outlet	.35	
	Clothes dryer outlet	.35	
	Automatic clothes washer	.35	
1	Electric range outlet	.35	35
	Electric water heater outlet	.35	
	Mercury arc lamp and equipment	.35	
	Special purpose outlet	.35	
	X-ray unit and its appurtenances	5.00	
	Watts of festoon lighting (Watts) First 3,000 watts	4.00	
	for each additional thousand watts	1.50	
	Horsepower - all motors first horsepower or less	1.75	
	for each additional horsepower	.35	
	Temporary power and lights (temporary pole)	4.00	
1	Electric service (including any single meter socket)	3.00	300
	for each additional socket	.35	
1	Air conditioning service	1.50	150
	amps		
	Each KW (KVA) Generator (Transformer) (Welder) KW (KVA)	2.00	
	First 100 KVA - For each additional KW (KVA)	.01	
	Special inspection per hour	4.00	
	Speaker outlets	.15	
	Signal or Alarm outlets	.15	
	Amplifiers	.50	
	Control panels	.25	
	T. V. outlets - master system only	.15	
7	Radio outlets	.15	
	Main control racks	1.00	
	T. V. and Radio antennas - master system only	.75	
	Minimum fee for any permit	4.00	
	Total fee		1685

I hereby certify that I have carefully examined and read the above application; that the same is true and correct; and that the work herein described is to be done in accordance with all the provisions of the applicable Ordinances of the City of Las Vegas, Nevada and State laws whether herein specified or not.

SIGNED: [Signature] DATE: 1/28/70

BUILDING DEPARTMENT: [Signature] DATE:

PERMIT NO. 29657 PERMIT FEE: \$1685

RECEIPT

1325 \$01685 - 6

CITY OF LAS VEGAS
DEPT. OF BUILDING & SAFETY

7-9-70

W. Jones, 1979

CITY OF LAS VEGAS, NEVADA

LOG NO. & AREA

DEPARTMENT OF BUILDING & SAFETY

CONST. VAL \$ 25.00

APPLICATION & BUILDING PERMIT - for: Fence, Wall, Retaining Wall.

ADDRESS OF CONSTRUCTION: 809 HORTIGUA ST.

OWNER: Frank J. Willers

LOT(s) G BLOCK 4 SUBDIVISION CHAR. RAINBOW RE ZONE R1

Materials of Construction: Block [] Concrete [] Wire [] Wood [x] Other []

ARCHITECT: ENGINEER: PLANS: [] [] CALC: [] []

CONTRACTOR: OWNER STATE LICENSE # CITY LICENSE #

TOTAL SQUARE FEET: TOTAL LINEAL FEET: 125

Remarks: [] [] [] []

CONDITIONS OF THE PERMIT:

- 1. Any type of retaining wall must be engineered by a Civil or Structural Engineer.
2. If a home owner takes out the Building Permit and if the owner sublets the work to a Contractor, then the Contractor must take out the permit and pay for it.
3. No fence or wall can be built on City property or rights-of-way, but this is not intended to preclude construction within utility easements if utilities will not be damaged or made inaccessible.
4. The fence or wall shall not enclose any water meter, light standard, or fire alarm box and shall not come closer than 24" from the nearest fire hydrant outlet.
5. Department Inspectors must approve footings before concrete is poured and block wall reinforcing before grouting is done.
6. Maximum height of any wall or fence is 6' side and rear yards; 4' maximum in front yard with the vertical surface above the height of 2' - 50% open.
7. I must not obstruct required onsite parking space (1 space for each dwelling unit) by the erection of this fence or wall.
8. By the signing of this application I herewith agree to the requirements outlined above.

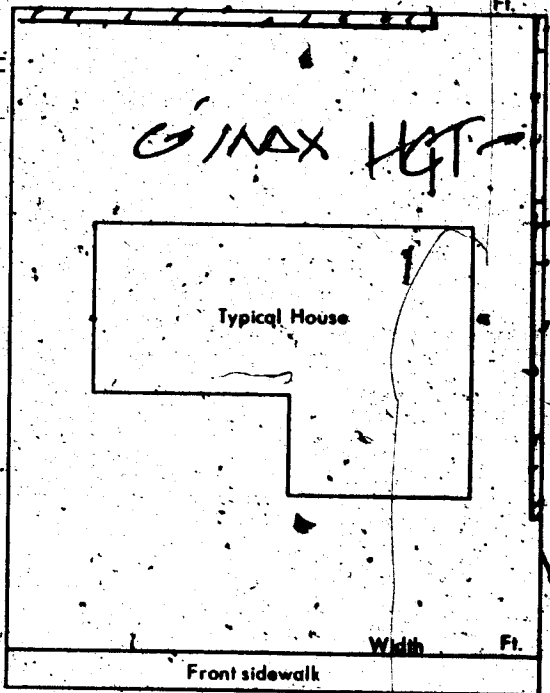

SIGNED: Frank J. Willers DATE: 4/14/72

CONTRACTOR [] AGENT [] OWNER [x]

PLANNING DEPT. Date: 4-14-72

PUBLIC WORKS DEPT. Date:

BUILDING DEPT.: F. J. Willers Date: 4-14-72

#12850 PERMIT NO.: 4/221 PERMIT FEE \$ 5.00

RECEIPT

5630 \$005.00 - 8

CITY OF LAS VEGAS DEPT. OF BUILDING & SAFETY MUST BE PAID IN ADVANCE

Moria Ealy 11-6-80

DEPARTMENT OF BUILDING & SAFETY
CITY OF LAS VEGAS, NEVADA

KARDEX CARD
FENCE & RETAINING
WALLS

OWNER Frank J. Willers ADDRESS 809 Antiqua DATE 4-14-72
CONTRACTOR Owner PERMIT NO. 4221
LOT 6 BLOCK 4 SUBDIVISION Charleston Rainbow 9E wood fenced

Fence (wire, wood, etc.)	Walls (masonry, rock, etc.)
Location _____	Location _____
Final Inspection <u>2-9-13-72</u>	Footings _____
	Wall Steel 1st _____ 2d _____ 3d _____
	Final Inspection _____
Retaining Wall (masonry)	Retaining Wall (concrete)
Location _____	Location _____
Footings _____	Footings _____
Wall Steel 1st _____ 2d _____ 3d _____	Wall Steel 1st _____ 2d _____ 3d _____
Bond Beam 1st _____ 2d _____ 3d _____	Final Inspection _____
Final Inspection _____	

23.14 B ADDRESS 809 Antiqua LOG NO. _____ AREA _____

DEPT. of BLDG. & SAFETY - CITY of LAS VEGAS, NEVADA

OWNER Sproul Homes ADDRESS 809 Antiqua DATE 12/17/69
GEN. CONT. Same TYPE OF STRUCTURE SFD
PERMIT NO. 50405 LEGAL DESCRIPTION L. 6, B. 4 Charleston Rainbow 9-E

BUILDING	MECHANICAL	ELECTRICAL
LOCATION <u>809 Antiqua</u>	PLUMBING CONT. <u>7-11-70</u>	TEMP. POLE CONT. _____
FIREPLACE (FTS) _____	PERMIT NO. <u>28944</u> DATE <u>1-6-70</u>	PERMIT NO. _____ DATE _____
FOOTINGS <u>1-16-70</u>	HEAT & VENT. AC CONT. <u>E.E. Sproul</u>	INSPECTION _____ DATE _____
FOUNDATION WALL <u>1-21-70</u>	PERMIT NO. <u>28332</u> DATE <u>12-30-69</u>	ELECTRICAL CONT. <u>Intelli</u>
WOOD FRAMING _____	SEWER CONT. <u>Sproul</u>	PERMIT NO. <u>27612</u> DATE <u>1-28-70</u>
SLAB <u>1-3-70</u>	PERMIT NO. <u>29745</u> DATE <u>12/17/69</u>	FIXTURES CONT. _____
CHIMNEY STEEL (FIREPLACE) _____	ROUGH SOIL <u>10-1-70</u>	PERMIT NO. _____ DATE _____
WALL STEEL _____	ROUGH WATER <u>1-31-70</u>	SLAB <u>5-23-70</u>
COLUMN STEEL _____	TOP-OUT <u>5-23-70</u>	ROUGH <u>5-23-70</u>
BEAM STEEL _____	ROUGH GAS _____	FINAL ROUGH _____
FRAMING _____	AC ROUGH DUCT <u>10-23-70</u>	FINAL FIXTURE _____
ROOF SHEATHING _____	REF. ROUGH PIPING _____	FINAL ELECTRICAL <u>5-23-70</u>
DRYWALL _____	FINAL PLUMBING <u>10-14-70</u>	TEMPORARY SERVICE _____
LATHING _____	FINAL GAS <u>1-16-70</u>	
DARKING (SIDING) _____	FINAL AIR COND. <u>7-4-70</u>	
PLASTER SCRATCH _____	FINAL REFRIG <u>10-22-70</u>	
PLASTER BROWN _____	FINAL SEWER _____	
URBAN REDEVELOPMENT APPROVAL _____	FINAL SEPTIC TANK _____	
FINAL BLDG. <u>1-14-70</u> DATE <u>1-14-70</u>		

APPROVED FOR OCCUPANCY & METER 1-5-14-70 INSPECTOR _____ DATE _____

PLEASE NOTE REMARKS ON REVERSE SIDE 809 Antiqua LOG # T-24 AREA # 4 23.04