

810 ADAMS

PORTION $S\frac{1}{2}$ $NE\frac{1}{4}$ SEC 28, 20 61 ZONE R-1

CITY OF LAS VEGAS, NEVADA

LOG NO. & AREA

CONST. VAL \$ 220⁰⁰

DEPARTMENT OF BUILDING & SAFETY

APPLICATION & BUILDING PERMIT for:

ADDRESS OF CONSTRUCTION

810 Adams
Joseph Clary

Dwellings, Duplexes, Misc. Residential Const.

OWNER:

H O ADAMS Joseph Clary

LOT(s)

BLOCK

SUBDIVISION

PTG. 3/2 NE 1/4 SEC 28, 20-61 ZONE: R-1

Existing structure on lot: Dwelling Accessory bldg. Vacant lot Other

PROPOSED CONSTRUCTION:

Patio slab

USE: S.F.R.

MATERIALS OF CONSTRUCTION: Wood Frame Concrete Block Reinforced Concrete Steel Frame

SQUARE FEET OF FLOOR AREAS: 1st _____ 2nd _____ 3rd _____ Other _____ TOTAL SQ. FT. 480

FIRE ZONE: 1 2 3 Occupancy Group A B C D E F G H I J-1-2-3-4-5 CONST. TYPE: I II III IV V

ARCHITECT: _____ ENGINEER: _____ NO. of UNITS _____ NO. of STORIES _____

Plans Submitted: Yes No Calculations Submitted Yes No Sewer Fee Req'd. Yes No

CONTRACTOR: owner STATE LICENSE # _____ CITY LICENSE # _____

ADD'L. PERMITS REQ'D: Air Cond. Elec. Plumbing Signs Paving Fence Public Walks Curb-gutters Incinerators Fire Sprinkling System

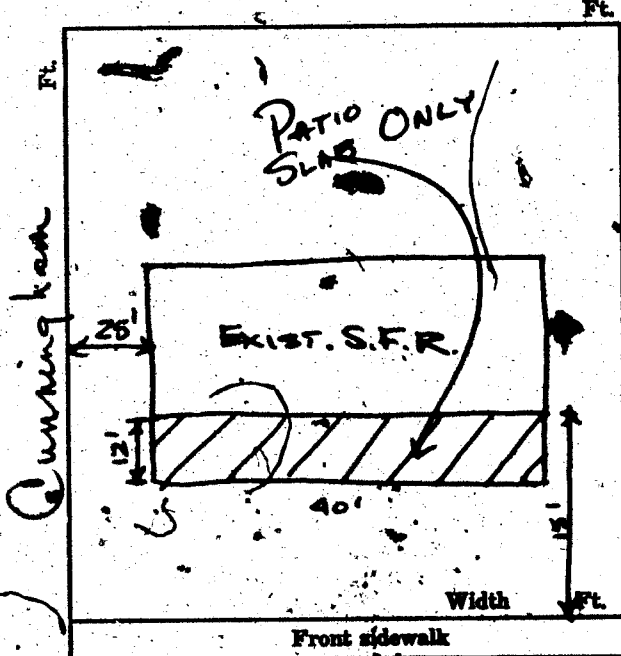

CONDITIONS OF THE PERMIT:

1. I agree to call the City Building Department for inspections before concrete is poured, before rough wiring, electrical, plumbing, framing is covered. Also for Air conditioning, sheet-rock and sheathing inspection.
2. I agree that when the job is completed that I will call for final inspection before occupancy.
3. I agree to perform all construction in accordance with City Ordinances and Building Codes.
4. The Contractor's signature below denotes authority from the owner to sign in his behalf and that the owner is aware of all requirements of this application and permit. Separate permits must be taken out for work outlined above this agreement.
5. I have read and understand the contents of this application and permit; I hereby state that the information I have supplied on this application is true and correct.

SIGNED: _____ Contractor

BY: Joseph Clary Agent or Owner

CLARK COUNTY HEALTH DEPT. Date _____

LAS VEGAS FIRE DEPARTMENT Date _____

Adams

PLANNING DEPT: _____ Date: 7-1-68

ENGINEERING DEPT: _____ Date: _____

BUILDING DEPT: _____ Date: 7-1-68

#1285 PERMIT NO: 43417 PERMIT FEE \$ 4⁰⁰

RECEIPT

1693 \$004.00 - 8

CITY OF LAS VEGAS
DEPT. OF BUILDING & SAFETY

MUST BE MACHINE VALIDATED
- 1 JUL 68

1 Jones 11-30-71

CITY OF LAS VEGAS, NEVADA

Job #3094

DEPARTMENT OF BUILDING & SAFETY - ELECTRICAL APPLICATION & PERMIT

ADDRESS OF CONSTRUCTION: 810 W. Adams Ave. OWNER'S NAME: Emma Clary

CIRCLE: New Bldg. Add'n.; Remodel; TYPE OF BLDG.: SFD APT. PUBLIC COMM.

CONTRACTOR'S NAME: ELECTRIC CONSTRUCTION COMPANY STATE LICENSE # 9383 CITY LICENSE # 2193

NUMBER	FIXTURE OR INSTALLATION	UNIT PRICE	TOTAL
	Rm addition, carport or garage enclosure	4.00	
	Temporary power	4.00	
	Light, receptacle or switch outlet	.20	
	Wall or ceiling space heater	.35	
	Garbage grinder outlet	.35	
	Dishwasher outlet	.35	
	Clothes dryer outlet	.35	
	Automatic clothes washer	.35	
	Electric range outlet	.35	
	Electric water heater outlet	.35	
	Special purpose outlet	.35	
	X-ray unit and its appurtenances	5.00	
	Watts of festoon lighting (Watts) First 3,000 watts for each additional thousand watts	4.00 1.50	
	Horsepower each motor first horsepower or less for each additional horsepower	1.75 .35	
1	Electric service (including any single meter socket) for each additional socket	3.00 .35	3.00
1	Air conditioning service	1.50	1.50
	Each KW(KVA) Generator (Transformer, Welder) First 100 KVA for each additional KW(KVA)	2.00 .01	
	Speaker, signal or alarm outlet	.15	
	Amplifiers	.50	
	Control panels	.25	
	Main control racks	1.00	
	T.V. and radio antennas-master system only	.75	
	Minimum fee for any permit	4.00	
	TOTAL FEE		4.50

Approval for the work under this permit will be given only after refuse and debris have been removed from job site and public right of way.

Attention: Nancy
for Credit of \$4.50

I hereby certify that I have carefully examined and read the above application; that the same is true and correct; and that the work herein described is to be done in accordance with all the provisions of the applicable Ordinances of the City of Las Vegas, Nevada and State laws whether herein specified or not.

SIGNED [Signature] DATE 3-26-73
MASTER (ELECTRICIAN) [Signature]

BUILDING DEPARTMENT [Signature] DATE 3-28-73

#12860 PERMIT NO. 5884 PERMIT FEE: \$ 4.50

RECEIPT

5155 \$004.50 - 6

CITY OF LAS VEGAS
DEPT. OF BUILDING & SAFETY

MUST BE MACHINE VALIDATED

28 MAR 73

1 Jones 11-30-78

CITY OF LAS VEGAS, NEVADA

DEPARTMENT OF BUILDING & SAFETY - ELECTRICAL APPLICATION & PERMIT

ADDRESS OF CONSTRUCTION: 510 Adams St OWNER'S NAME: Mr. Cherry

CIRCLE: New Bldg.; Add'n.; Remodel; TYPE OF BLDG.: SFD. APT. PUBLIC COMM.

CONTRACTOR'S NAME: Palmer Electric STATE LICENSE # CITY LICENSE #

NUMBER	FIXTURE OR INSTALLATION	UNIT PRICE	TOTAL
	Rm addition, carport or garage enclosure	4.00	
	Temporary power	4.00	
	Light, receptacle or switch outlet	.20	
	Wall or ceiling space heater	.35	
	Garbage grinder outlet	.35	
	Dishwasher outlet	.35	
	Clothes dryer outlet	.35	
	Automatic clothes washer	.35	
	Electric range outlet	.35	
	Electric water heater outlet	.35	
	Special purpose outlet	.35	
	X-ray unit and its appurtenances	5.00	
	Watts of festoon lighting (Watts) First 3,000 watts for each additional thousand watts	4.00 1.50	
	Horsepower each motor, first horsepower or less for each additional horsepower	1.75 .35	
	Electric service (including any single meter socket) for each additional socket	3.00 .38	
<u>1-2 Ton Air</u>	Air conditioning service	1.50	
	Each KW(KVA) Generator (Transformer, Welder) First 100 KVA for each additional KW(KVA)	2.00 .01	
	Speaker, signal or alarm outlet	.15	
	Amplifiers	.50	
	Control panels	.25	
	Main control racks	1.00	
	T.V. and radio antennas-master system only	.75	
	Minimum fee for any permit	4.00	
	TOTAL FEE		

Approval for the work under this permit will be given only after refuse and debris have been removed from job site and public right of way.

I hereby certify that I have carefully examined and read the above application; that the same is true and correct; and that the work herein described is to be done in accordance with all the provisions of the applicable Ordinances of the City of Las Vegas, Nevada and State laws whether herein specified or not.

SIGNED: Julian Garcia DATE: _____
MASTER (ELECTRICIAN) (TECHNICIAN) (OWNER)

BUILDING DEPARTMENT: M. J. Jelle DATE: 6-4-76

#12860 PERMIT NO. 1426 PERMIT FEE: \$ 4.00

RECEIPT

2895 \$004.00 - 6

CITY OF LAS VEGAS

MUST BE MACHINE VALIDATED

Jones 11-30-78

CITY OF LAS VEGAS, NEVADA

8253

DEPARTMENT OF PUBLIC SERVICES - ELECTRICAL APPLICATION & PERMIT DIVISION OF BUILDING AND SAFETY

ADDRESS OF CONSTRUCTION: 810 W. Adams OWNER'S NAME: Clary

CIRCLE: New Bldg. Add'n. Remodel; TYPE OF BLDG.: SFD. APT. PUBLIC COMM.

CONTRACTOR'S NAME: Electric Construction Co. STATE LICENSE # 9383 CITY LICENSE # 2193

NUMBER	FIXTURE OR INSTALLATION	UNIT PRICE	TOTAL
	Rm addition, carport or garage enclosure	4.00	
	Temporary power	4.00	
	Light, receptacle or switch outlet	.20	
	Wall or ceiling space heater	.35	
	Garbage grinder outlet	.35	
	Dishwasher outlet	.35	
	Clothes dryer outlet	.35	
	Automatic clothes washer	.35	
	Electric range outlet	.35	
	Electric water heater outlet	.35	
	Special purpose outlet	.35	
	X-ray unit and its appurtenances	5.00	
	Watts of festoon lighting (Watts) First 3,000 watts for each additional thousand watts	4.00 1.50	
	Horsepower each motor first horsepower or less for each additional horsepower	.75 .35	
1	Electric service (including any single meter socket) for each additional socket	3.00 1.00	3.00 0.00
1	Air conditioning service	ELEC \$ 11.50 \$ 4.50	
	Each KW(KVA) Generator (Transformer, Welder) First 100 KVA for each additional KW(KVA)	2000L \$ 4.50 CRK \$ 4.50	
	Speaker, signal or alarm outlet	RS9577	SR001/01
	Amplifiers	.50	
	Control panels	CITY 25	LAS VEGAS
	Main control racks	BLDG & SAFETY	
	T.V. and radio antennas-master system only	.75	
	Minimum fee for any permit	4.00	
	TOTAL FEE		4.50

Approval for the work under this permit will be given only after refuse and debris have been removed from job site and public right of way.

I hereby certify that I have carefully examined and read the above application; that the same is true and correct; and that the work herein described is to be done in accordance with all the provisions of the applicable Ordinances of the City of Las Vegas, Nevada and State laws whether herein specified or not.

SIGNED: [Signature] #69 DATE 9-21-78
MASTER (ELECTRICIAN) (TECHNICIAN) (OWNER)

BUILDING DIVISION: B.D. DATE 9-22-78

PERMIT NO.: 9677 PERMIT FEE: \$ 4.50

RECEIPT

MUST BE MACHINE VALIDATED

Gloria Caly 10-21-80

Department of Building & Safety
City of Las Vegas, Nevada

Special Kardex
Elec. only, Plbg. only, A.C. only

Owner Mr. Cliery Address 810 Adams Street Date: 1426
Contractor Galatz Permit No. 1426
Lot _____ Block _____ Subdivision _____

Electric Only	Plumbing Only	Heat & Vent. A. C. Only
Contractor _____	Contractor _____	Contractor <u>Galatz</u>
Permit No. _____	Permit No. _____	Permit No. <u>1426</u>
Slab _____	Rough Soil _____	A.C. Rough Duct _____
Rough Elect _____	Rough Water _____	Ref. Ro. Piping _____
Final Rough _____	Top Out _____	Rough Gas _____
Final Fixture _____	Rough Gas _____	Final Refrig _____
Final Elec _____	Final Plbg. _____	Final Air Cond _____
Temp. Service _____	Final Gas _____	Final Gas _____
	Final Sewer _____	
	Final Septic Tank _____	

23.06 D Address 810 Adams Street Log No. Air Cond. Area _____

Department of Building & Safety
City of Las Vegas, Nevada

Special Kardex
Elec. only, Plbg. only, A.C. only

Owner Erma Clary Address 810 W. Adams Date: 3/28/73
Contractor _____ Permit No. _____
Lot _____ Block _____ Subdivision _____

Electric Only	Plumbing Only	Heat & Vent. A. C. Only
Contractor <u>Elect Cons</u>	Contractor _____	Contractor _____
Permit No. <u>5884</u>	Permit No. _____	Permit No. _____
Slab _____	Rough Soil _____	A.C. Rough Duct _____
Rough Elect _____	Rough Water _____	Ref. Ro. Piping _____
Final Rough _____	Top Out _____	Rough Gas _____
Final Fixture _____	Rough Gas _____	Final Refrig _____
Final Elec <u>198-23-13</u>	Final Plbg. _____	Final Air Cond _____
Temp. Service _____	Final Gas _____	Final Gas _____
	Final Sewer _____	
	Final Septic Tank _____	

23.06 D Address 810 W. Adams Log No. AC Service Area _____

Gloria Caly 10-21-80

Department of Building & Safety
City of Las Vegas, Nevada

Special Kardex
Elect. only - Plbg. only - A.C. only

Owner Clarey Address 810 W. Adams Date 9-20-65
Contractor Big Town Plmg Permit No. _____
Lot _____ Block _____ Subdivision _____

Electric Only	Plumbing Only	Heat & Vent - A.C. Only
Contractor _____	Contractor <u>Big Town Plmg</u>	Contractor _____
Permit No. _____	Permit No. <u>18479</u>	Permit No. _____
Slab _____	Rough Soil _____	A.C. Rough Duct _____
Rough Elect. _____	Rough Water _____	Ref. Ro. Piping _____
Final Rough _____	Top Out _____	Rough Gas _____
Final Fixture _____	Rough Gas _____	Final Refrig. _____
Final Elect. _____	Final Plbg. _____	Final Air Cond. _____
Temp. Service _____	Final Gas <u>4/22/9-31-65</u>	Final Gas _____
	Final Sewer _____	
	Final Septic Tank _____	

2306 D Address 810 W. Adams Log. No. _____ Area _____

DEPT. of BLDG. & SAFETY—CITY of LAS VEGAS, NEVADA

OWNER Joseph Clary ADDRESS 810 Adams DATE 7/1/68
GEN CONT. Owner TYPE OF STRUCTURE Patio Slab
PERMIT NO. 43417 LEGAL DESCRIPTION S. NE 1/4 Sec 28 20 61

BUILDING	MECHANICAL	ELECTRICAL
LOCATION _____	PLUMBING CONT. _____	TEMP. POLE CONT. _____
FIREPLACE FTS. _____	PERMIT NO. _____ DATE _____	PERMIT NO. _____ DATE _____
FOOTINGS _____	HEAT & VENT. AC CONT. _____	INSPECTION _____ DATE _____
FOUNDATION WALL _____	PERMIT NO. _____ DATE _____	ELECTRICAL CONT. _____
FLOOR FRAMING _____	SEWER CONT. _____	PERMIT NO. _____ DATE _____
SLAB _____	PERMIT NO. _____ DATE _____	FIXTURES CONT. _____
CHIMNEY STEEL (FIREPLACE) _____	ROUGH SOIL _____	PERMIT NO. _____ DATE _____
WALL STEEL _____	ROUGH WATER _____	SLAB _____
COLUMN STEEL _____	TOP-OUT _____	ROUGH _____
BEAM STEEL _____	ROUGH GAS _____	FINAL ROUGH _____
FRAMING _____	AC. ROUGH DUCT _____	FINAL FIXTURE _____
ROOF SHEATHING _____	REF. ROUGH PIPING _____	FINAL ELECTRICAL _____
INTERIOR _____ EXTERIOR _____	FINAL PLUMBING _____	TEMPORARY SERVICE _____
DRYWALL _____	FINAL GAS _____	
LATHING _____	FINAL AIR COND. _____	
BACKING (SIDING) _____	FINAL REFRIG. _____	
PLASTER SCRATCH _____	FINAL SEWER _____	
BROWN _____	FINAL SEPTIC TANK _____	
URBAN REDEVELOPMENT APPROVAL _____		
FINAL BLDG. _____ DATE _____		

MISCELLANEOUS
GRADING & DRAINAGE _____
ON-SITE PARKING SPACES _____ APP. _____
ENG. APPROVAL OF _____
OFF-SITE IMPROVEMENTS _____

APPROVED FOR OCCUPANCY & METER IN 2.1.4-30-68 INSPECTOR _____ DATE _____

PLEASE NOTE REMARKS ON REVERSE SIDE 810 Adams LOG # _____ AREA # _____ 2304

Bloria Caly 10-21-80

OWNER, EMILY CLARY DEPT. of BLDG. & SAFETY - CITY of LAS VEGAS, NEVADA
GEN. CONT. OWNER BUILDER ADDRESS 810 W. Adams St. DATE 3/16/61
PERMIT NO. 3718 LEGAL DESCRIPTION Portion NE 1/4, SE 1/4, SE 1/4, NE 1/4, Sec. 20-20-61. TYPE OF STRUCTURE S.F. DWELLING (OLD S.F. D.W.G. TO BE REMOVED)

LOCATION _____	FIREPLACE FTG. _____	PLUMBING CONT. _____	TEMP POLE CONT. _____
FOOTINGS <u>3 24 61</u>	PILES _____	PERMIT NO. <u>1 9 61</u>	PERMIT NO. _____
FOUND <u>1 26 24 61</u>	PIERS _____	DATE <u>11 22 61</u>	DATE _____
FLOOR _____	SLAB <u>0 13 11 24 61</u>	HEAT & VENT. CONT. _____	INSPECTION _____
ANCHOR BOLTS <u>1 24 61</u>	BASE PLATES _____	PERMIT NO. <u>1 1 61</u>	DATE <u>11 20 61</u>
WALL STEEL _____	SEWER CONT. _____	SEWER CONT. _____	ELECTRICAL CONT. _____
COLUMN STEEL _____	PERMIT NO. _____	PERMIT NO. _____	PERMIT NO. <u>1 9 61</u>
BEAM STEEL _____	DATE _____	ROUGH SOIL _____	DATE <u>11 21 61</u>
FRAMING <u>6 17 10 21 61</u>	ROUGH WATER _____	OUTLETS <u>20</u>	MOTORS _____
ROOF SHEATHING <u>0 16 21 61</u>	TOP-OUT <u>Butley</u>	SLAB _____	ROUGH <u>11 22 61</u>
STEEL FABRICATION _____	ROUGH GAS _____	ROUGH _____	FINAL ROUGH _____
STEEL CONNECTION _____	AC ROUGH DUCT _____	FIXTURES CONT. _____	PERMIT NO. <u>1 9 61</u>
LATHING _____	REF. ROUGH PIPING _____	PERMIT NO. _____	DATE _____
BACKING _____	SEWER <u>Butley</u>	FIXTURES _____	FINAL FIXTURE <u>11 22 61</u>
PLASTER SCRATCH _____	SEPIC TANK _____	FINAL PLUMBING <u>Butley 12 61</u>	URBAN REDEVELOPMENT APPROVAL _____
PLASTER BROWN _____	FINAL GAS _____	FINAL HEATING _____	DATE _____
FINAL BLDG. _____	FINAL AIR COND _____	FINAL REFRIG _____	
GRADING & DRAINAGE _____	ON-SITE PARKING _____		
ON-SITE PARKING _____	SPACES _____		
ENG. APPROVAL OF _____	INSPECTOR _____		
OFF-SITE IMPROVEMENTS _____			

APPROVED FOR OCCUPANCY _____ DATE _____
APPROVED FOR METER _____ DATE 11 22 61

PLEASE NOTE REMARKS ON REVERSE SIDE 810 W. Adams St. (over) LOG# 95 AREA# 3 2304

Gloria Coley 10-21-80

3/16/61 - Cash Bond of \$100.00 posted with City Treasurer to remove old S.F. Dwelling within one year from date, or March 16, 1962, after completion of new dwelling. Also check with Urban Renewal.

3/16/61 - Permit & Application #3051, dated 2/6/61 are cancelled in lieu of new permit & application dated 3/16/61.

Thomas K. R. W. 2-2-81

OWNER	DALTON PROP. ONLY, A.D. ONLY 917 ADAMS	
DATE	9-6-78	GEN. CONT. DALTON PROP.
ADDRESS	810 W. ADAMS	
TYPE OF STRUCTURE	SFD	PERMIT NO. 9233 FINAL INSPECTION
DESCRIPTION	SEE APPLI'N LOG # R11 AREA # 3	
CONTRACTOR	APPROVED FOR OCCUPANCY & METER	
BUILDING BLOCK	SUBDIVISION	
Investigation	ELECT. SERV. AD PROPERTIES	
LOG NO.	Location & Roofing EC 9-22-78	Permit No. 9234 Date 9-6-78
	Concrete Slab Floor EC 9-22-78	Heat & Vent. A/C Cont. Sun City
	Stainless Footing	Permit No. Data
	ELECTRIC ONLY Chimney Seal	PLUMBING ONLY Sewer Cont. DALTON PROPERTIES
Contractor	Vert. Steel Reinf. ELECTRICAL CONST.	Contractor
Permit No.	EC 9-22-78	Permit No. 9233-1 Date 10-10-78
Rough Elec.	Ext. Lath EC 10-23-78	Rough Soil MM 9-21-78
Final	Light. Brown	Rough Water 10-30-78
Final	Drywall EC 11-3-78	Top Out 10-10-78
Final	Floor Building EC 1-22-80	Rough Gas 10-18-78
Temp. Service	Apr. for Occu.	Top Out A/C Rough Duct 10-24-78
	L & VENT. ELECTRICAL	Final Plumbing Jul 1-22-80
Contractor	Temp. Pole Spnt.	Rough Gas
Permit No.	Permit No.	Final Gas Jul 1-22-80
Inspection	Date	Final Air Cond Jul 1-22-80
A/C Rough Duct	Electrical Cont. SERVICE ALL	Final Sewer Jul 1-22-80
Rough Gas	Permit No. 10158 Date 10-12-78	Sewer Final
Final	Rough CW 10-16-78	REMARKS
Final	Final Rough	EXT. SCRAP - EC 11-22-78
Final	Final Electrical CW 10-17-78	
2-1-30	DIV. OF BLDG. & SAFETY	
	TEMPORARY PERMIT	

PLEASE NOTE ADDITIONAL REMARKS ON REVERSE SIDE.
 DIV. OF BLDG. & SAFETY
 CITY OF LAS VEGAS
 REV. 10-78
 E-Z-WAY SYSTEMS
 NEWARK, OH 44055
 LITHO IN U.S.A.