

5601 Bromley

Sharon Perina 1/30/79

CITY OF LAS VEGAS, NEVADA

LOG NO. & AREA R-43 DEPARTMENT OF BUILDING & SAFETY CONST. VAL. \$ 43,680⁰⁰

ADDRESS OF CONSTRUCTION: 5001 Bromley APPLICATION & BUILDING PERMIT — for: Dwellings, Duplexes, Misc. Residential Const.

OWNER: JAMES + LUTIAN MAXWELL

LOT: See attached BLOCK: _____ SUBDIVISION: _____ ZONE: R-1

Existing structure on lot: Dwelling Accessory bldgs. Vacant lot Other

PROPOSED CONSTRUCTION: SINGLE FAMILY DWELLING USE: RES.

MATERIALS OF CONSTRUCTION: Wood Frame Concrete Block Reinforced Concrete Steel Frame

SQ. FEET OF FLOOR AREAS: 1st 2480 2nd 228(30) 3rd _____ Other _____ TOTAL SQ. FT. 2680

FIRE ZONE: 1 2 3 _____ Occupancy Group 1 J 1-2 _____ CONST. TYPE I II III IV V

ARCHITECT: _____ ENGINEER: _____ NO. of UNITS _____ NO. of STORIES _____

Plans Submitted: Yes No Calculations Submitted: Yes No Sewer Fee Req'd. Yes No

CONTRACTOR: OWNER/Builder STATE LICENSE # _____ CITY LICENSE # _____

ADD'L. PERMITS REQ'D: Air Cond Elec. Plumbing Signs Paving Fence Public Walks Curb-gutters
Incinerators Fire Sprinkling System

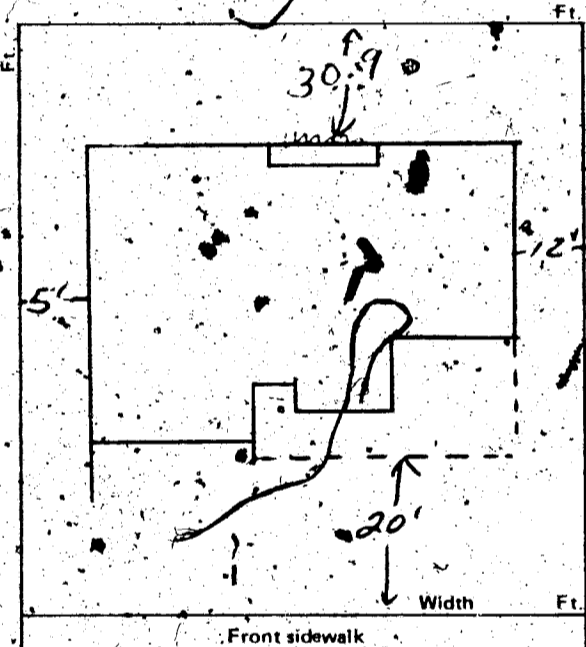

CONDITIONS OF THE PERMIT:

- 1. I agree to call the City Building Department for inspections before concrete is poured; before rough wiring, electrical, plumbing, framing is covered. Also for air conditioning, sheet-rock and sheathing inspection.
- 2. I agree that when the job is completed that I will call for final inspection before occupancy.
- 3. I agree to perform all construction in accordance with City Ordinances and Building Codes.
- 4. The Contractor's signature below denotes authority from the owner to sign in his behalf and that the owner is aware of all requirements of this application and permit. Separate permits must be taken out for work outlined above this agreement.
- 5. I have read and understand the contents of this application and permit; I hereby state that the information I have supplied on this application is true and correct.

Approval for the work under this permit will be given only after refuse and debris have been removed from job site and public right of way.

SIGNED: _____ Contractor
BY: James Maxwell Agent or Owner
Date: _____

CLARK COUNTY HEALTH DEPT. Date: _____
LAS VEGAS FIRE DEPARTMENT Date: _____

PLANNING DEPT.: MA Date: 7-23-75
PUBLIC WORKS DEPT.: DR Date: 7-24-75
BUILDING DEPT.: Robert [unclear] Date: 7-24-75
12850 PERMIT NO.: 3250 PERMIT FEE: 225⁰⁰

RECEIPT
MUST BE MACHINE VALIDATED
9:00 10

Sharon Parvia 1130779

CITY OF LAS VEGAS, NEVADA
DEPARTMENT OF BUILDING & SAFETY

RECEIPT
FOR
SEWER CONNECTION FEE

JOB ADDRESS: 5600 BROMLEY OWNER'S NAME: JAMES + L JESU MAXWELL

LOT - BLOCK SUBDIVISION

QUANTITY	OCCUPANCY	UNIT FEE	AMOUNT
1	S.F.D.	150 ⁰⁰	150 ⁰⁰

PAID BY: _____	TOTAL _____	150 ⁰⁰
	Less Credit* _____	- 0 -
	TOTAL FEE \$ _____	150 ⁰⁰

*Credit for existing sewer is applied to the new sewer connection fee based on previous type of occupancy and only when the new occupancy requires an additional fee.

This receipt does not authorize the owner or his representative to start any work without obtaining a plumbing permit.

H. T. Keller
DEPARTMENT OF BUILDING & SAFETY
DATE 7-24-78

RECEIPT NO. 1957 SEWER FEE \$ 150⁰⁰

73.102

RECEIPT
MUST BE MACHINE VALIDATED
JUL 25 1978

Sharon P... 1/30/79

CITY OF LAS VEGAS, NEVADA

DEPARTMENT OF BUILDING & SAFETY - APPLICATION AND PERMIT FOR PLUMBING

ADDRESS OF CONSTRUCTION: 30001 5521 Bromley OWNER'S NAME: Jim Maxwell
 CIRCLE: New Bldg. Add'n.; Remodel; TYPE OF BLDG: SEF APT. PUBLIC COMM.
 CONTRACTOR'S NAME: Delta Plumbing Co. STATE LICENSE # 12063 CITY LICENSE # 11723

UNITS	DESCRIPTION	FEE	TOTAL
2	Bathtub	1.00	2.00
	Shower	1.00	
4	Lavatory	1.00	4.00
4	Toilet	1.00	4.00
	Urinal	1.00	
1	Floor Drain	1.00	1.00
	Floor Sink	1.00	
1	Wash Tray	1.00	1.00
1	Sink	1.00	1.00
1	Garbage Disposal	1.00	1.00
	Garbage Disposal (comm.)	3.00	
	Clothes Dryer (gas)	1.00	
1	Clothes Washer	1.00	1.00
	Clothes Washer (comm.)	5.00	
1	Dishwasher	1.00	1.00
	Dishwasher (commercial)	5.00	
	Dental Unit	10.00	
	Drinking Fountain	1.00	
	Any Water using Equipment	1.00	
1	Water Heater (gas) <u>elect</u>	1.00	1.00
1	Sewer System - New, Replacement, or any Drainage System	4.00	4.00
	Grease or Sand Trap	2.00	
	Trailer Trap	2.00	
	Septic Disposal System	4.00	
WATER SOFTENERS			
	Nonpermanent Type	4.00	
1	Permanent Type (connected to Drainage)	5.00	5.00
SWIMMING POOLS			
	Private or Wading Pool	10.00	
1	Public or Semi-public	20.00	

UNITS	DESCRIPTION	FEE	TOTAL
WATER DISTRIBUTION SYSTEM			
1	Single Family Dwelling	4.00	4.00
	Multiple Family Dwelling plus each unit	4.00 2.00	
	Bldg. Group "A" thru "G" per each floor	6.00	
	Hotel or Motel plus each bath	4.00 1.00	
	Trailer Park plus each space	20.00 4.00	
	Irrigation	4.00	
GAS PIPING SYSTEM			
	Single Family Dwelling	3.00	
	Multiple Family Dwelling plus each unit	6.00 1.00	
	Commercial Bldg. per floor plus each unit	3.00 3.00	
	Gas Appliance (any type)	1.00	
AUTOMATIC FIRE EXTINGUISHING SYSTEM			
	Underground Piping	10.00	
	Distribution Piping ea. ft.	.01	
	Sprinkler Head each	.10	
	In Range Hood and Vent	5.00	
DRY STANDPIPE SYSTEM			
	Piping	50.00	
	Each Outlet	1.00	
WET STANDPIPE SYSTEM			
	Piping	5.00	
	Fire Hose Cabinet	1.00	
MINIMUM PERMIT FEE 4.00			
PIPELINE CONTRACTOR, SECT. 14-B.P.F. \$			
TOTAL PERMIT FEE \$ 30.00			

I hereby certify that I have carefully examined and read the above application, that the same is true and correct; and that the work herein described is to be done in accordance with all the provisions of the applicable Ordinances of the City of Las Vegas, Nevada and the State Laws, whether herein specified or not.

Approval for the work under this permit will be given only after refuse and debris have been removed from job site and public right of way.

Signed: Archie Schallenberg # 64 Date: 7/30/75
 Registered Master Plumber, Spec. Contr. or Owner
 Building Department: WRJ Date: 7/30/75
 Permit No. 2029 Permit Fee \$ 30.00

#12870

RECEIPT
 30 JUL 75
 MUST BE MACHINE VALIDATED

Sharon Penney - 1/30/79

CITY OF LAS VEGAS, NEVADA

DEPARTMENT OF BUILDING & SAFETY - ELECTRICAL APPLICATION & PERMIT

ADDRESS OF CONSTRUCTION: 5601 Bromley OWNER'S NAME: Maxwell

CIRCLE: New Bldg. Add'n.; Remodel; TYPE OF BLDG.: SFD. APT. PUBLIC COMM.

CONTRACTOR'S NAME: OWNER/Bld STATE LICENSE # _____ CITY LICENSE # _____

NUMBER	FIXTURE OR INSTALLATION	UNIT PRICE	TOTAL
0	Rm addition, carport or garage enclosure	4.00	
0	Temporary power	4.00	
<u>78</u>	Light, receptacle or switch outlet	.20	<u>15.60</u>
0	Wall or ceiling space heater	1.35	
<u>1</u>	Garbage grinder outlet	.35	<u>35</u>
<u>1</u>	Dishwasher outlet	.35	<u>35</u>
<u>1</u>	Clothes dryer outlet	.35	<u>35</u>
<u>1</u>	Automatic clothes washer	.35	<u>35</u>
<u>1</u>	Electric range outlet	.35	<u>35</u>
<u>1</u>	Electric water heater outlet	.35	<u>35</u>
0	Special purpose outlet	.35	
0	X-ray unit and its appurtenances	5.00	
0	Watts of festoon lighting (Watts) First 3,000 watts for each additional thousand watts	4.00 1.50	
0	Horsepower each motor first horsepower or less for each additional horsepower	1.75 .35	
<u>1</u>	Electric service (including any single meter socket) for each additional socket	3.00 .35	<u>3.00</u>
<u>1</u>	Air conditioning service	1.50	<u>1.50</u>
0	Each KW(KVA) Generator (Transformer, Welder) First 100 KVA for each additional KW(KVA)	2.00 .01	
0	Speaker, signal or alarm outlet	.15	
0	Amplifiers	.50	
0	Control panels	.25	
0	Main control racks	1.00	
0	TV and radio antennas-master system only	.75	
0	Minimum fee for any permit	4.00	
TOTAL FEE			

Approval for the work under this permit will be given only after refuse and debris have been removed from job site and public right of way.

I hereby certify that I have carefully examined and read the above application; that the same is true and correct; and that the work herein described is to be done in accordance with all the provisions of the applicable Ordinances of the City of Las Vegas, Nevada and State laws whether herein specified or not.

SIGNED: [Signature] DATE 11-3-75
MASTER (ELECTRICIAN) (TECHNICIAN) (OWNER)

BUILDING DEPARTMENT: [Signature] DATE 11-3-75

PERMIT NO. 2281 PERMIT FEE: \$ 22.20

RECEIPT
 2707 \$022.20 - 6
 CITY OF LAS VEGAS
 DEPT. OF BUILDING & SAFETY
 MUST BE MACHINE VALIDATED
 - 3 NOV 75

Angela L. Jackson, 2/24/80

DEPT. of BLDG. & SAFETY - CITY of LAS VEGAS, NEVADA

OWNER James & Lujean Maxwell ADDRESS 5600 Bromley DATE 7-24-75
 GEN. CONT. Owner TYPE OF STRUCTURE SPD
 PERMIT NO. 3250 LEGAL DESCRIPTION _____

BUILDING	MECHANICAL	ELECTRICAL
Investigation	Plumbing Cont. <u>Delta Plum</u>	Temp. pole cont.
Location & Footing <u>098-4-75</u>	Permit No. <u>3029</u> Date <u>7-31-75</u>	Permit No. _____ Date _____
Stem Wall	Heat & Vent. A/C Cont.	Inspection _____ Date _____
Concrete Slab Floor <u>098-4-75</u>	Permit No. _____ Date _____	Electrical Cont. <u>Quincy</u> <u>11-3-75</u>
Floor Framing	Sewer Cont. <u>Bromley</u>	Permit No. <u>2261</u> Date _____
Fireplace Footing	Permit No. <u>1951</u> Date _____	Fixtures Cont.
Chimney Steel	Rough Soil <u>KW 8-1-75</u>	Permit No. _____ Date _____
Vert. Steel Reinf.	Rough Water <u>KW 8-1-75</u>	Slab
Horiz. Steel Reinf.	Top-Out <u>KW 11-4-75</u>	Rough <u>HD 12-2-75</u>
Roof Sheathing	Rough Gas _____	Final Rough
Framing	A/C Rough Duct <u>KW 10-2-75</u>	Final Fixture
Backing for siding	Ref. Rough Piping _____	Final Electrical <u>HD 3-11-75</u>
Ext. Lath <u>0912-22-75</u>	Final Plumbing <u>KW 3-2-75</u>	Temporary Service _____
Ext. Scratch <u>091-9-76</u> <u>092-11-76</u>	Final Gas _____	MISCELLANEOUS
Ext. Brown <u>092-11-76</u>	Final Air Cond. <u>KW 3-2-76</u>	Grading & Drainage _____
Int. Lath	Final Refrig. _____	On Site Parking Spaces _____ App. _____
Int. Brown	Final Sewer <u>KW 1-5-76</u>	Eng. Approval of _____
Drywall <u>0912-12-75</u> <u>092-11-76</u>	Final Septic Tank _____	Off Site Improvements _____
Permit No. _____		
Final Building		
Appr. for Occu.		

Called 6-15-77

INSPECTOR: _____

DATE _____

APPROVED FOR OCCUPANCY & METER _____

PLEASE NOTE REMARKS ON REVERSE SIDE 5600 Bromley

LOG # _____

AREA # _____

R 43