

4529 ALAMEDA AVE.

LOT 53 BLK 5 METROPOLITAN PARK # 18 ZONED R-1 SFD

CITY OF LAS VEGAS, NEVADA

33-06

LOG NO. & AREA: T-3-2 CONST. VAL. \$ 21,870

DEPARTMENT OF PUBLIC SERVICES
DIVISION OF BUILDING AND SAFETY

APPLICATION & BUILDING PERMIT - for:
Dwellings, Duplexes, Misc. Residential Const.

ADDRESS OF CONSTRUCTION: 4529 Alameda Ave. OWNER: METROPOLITAN-NEVADA CORPORATION

LOT(s) 53 BLOCK 5 SUBDIVISION METROPOLITAN PARK Unit #18 ZONE: R-1

Existing structure on lot: Dwelling Accessory Bldgs. Vacant Lot Other

PROPOSED CONSTRUCTION: Single Family Dwelling USE: Residence

MATERIALS OF CONSTRUCTION: Wood Frame Concrete Block Reinforced Concrete Steel Frame

SQUARE FEET OF FLOOR AREAS: 1st 949 2nd 3rd Other 289 TOTAL SQ. FT.: 1238

FIRE ZONE: 3 Occupancy Group R-3 & R-1 CONST. TYPE: 5N

ARCHITECT: ENGINEER: David Weiss NO. of UNITS 1 NO. of STORIES 1

Plans Submitted: Yes No Calculations Submitted: Yes No Sewer Fee Req'd.: Yes No

CONTRACTOR: METROPOLITAN-NEVADA STATE LICENSE # 11199 CITY LICENSE # 16382

ADD'L. PERMITS REQ'D.: Air Cond. Elec. Plumbing Signs Paving Fence Public Works Curb-gutters
Incinerators Fire Sprinkling System

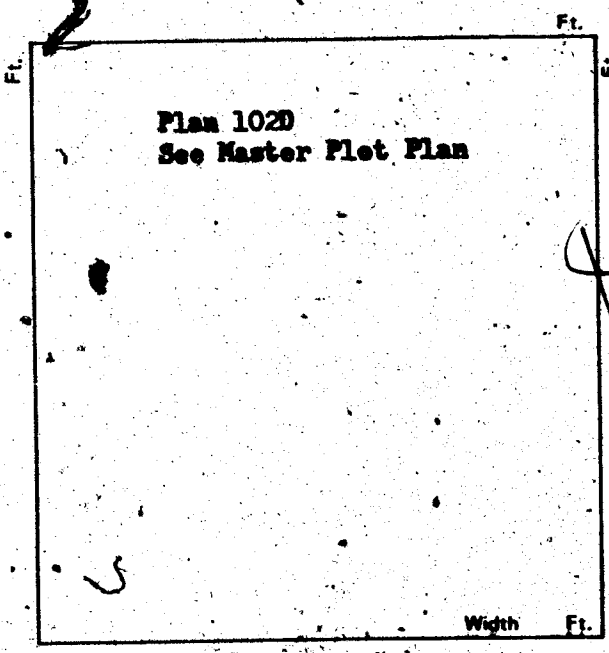

CONDITIONS OF THE PERMIT:

1. I agree to call the City Building Department for inspections before concrete is poured, before rough wiring, electrical, plumbing, framing is covered. Also for Air conditioning, drywall and sheathing inspection.
2. I agree that when the job is completed that I will call for final inspection before occupancy.
3. I agree to perform all construction in accordance with City Ordinances and Building Codes.
4. The Contractor's signature below denotes authority from the owner to sign in his behalf and that the owner is aware of all requirements of this application and permit. Separate permits must be taken out for work outlined above this agreement.
5. I have read and understand the contents of this application and permit; I hereby state that the information I have supplied on this application is true and correct.

Approval for the work under this permit will be given only after refuse and debris have been removed from job site and public right of way.

SIGNED: METROPOLITAN-NEVADA CORPORATION Contractor

BY: Wesley Lester, Vice President Agent or Owner

PLANNING DEPT.: [Signature] Date: 5/25/78

PUBLIC WORKS DEPT.: Charles J. [Signature] Date: 5/26/78

BUILDING DIVISION: [Signature] Date: 5/26/78

PERMIT NO.: 66679-1 PERMIT FEE \$ 100.00

154-01-220

RECEIPT

MUST BE MACHINE VALIDATED

U. J. ... 12-4-78

CITY OF LAS VEGAS, NEVADA

DEPARTMENT OF PUBLIC SERVICES—APPLICATION AND PERMIT FOR PLUMBING DIVISION OF BUILDING AND SAFETY

ADDRESS OF CONSTRUCTION: 4529 Alameda Ave. OWNER'S NAME: METRO-NEW CORP

CIRCLE: New Bldg. Add'n.; Remodel; TYPE OF BLDG.: SFD APT. PUBLIC COMM.

CONTRACTOR'S NAME: STERLING PLMB STATE LICENSE # 7119 CITY LICENSE # 910

UNITS	DESCRIPTION	FEE	TOTAL
1	Bathtub	1.00	1.00
	Shower	1.00	
2	Lavatory	1.00	2.00
2	Toilet	1.00	2.00
	Urinal	1.00	
	Floor Drain	1.00	
	Floor Sink	1.00	
	Wash Tray	1.00	
1	Sink	1.00	1.00
	Garbage Disposal	1.00	
	Garbage Disposal (comm.)	3.00	
	Clothes Dryer (gas)	1.00	
1	Clothes Washer	1.00	1.00
	Clothes Washer (comm.)	5.00	
	Dishwasher	1.00	
	Dishwasher (commercial)	5.00	
	Dental Unit	10.00	
	Drinking Fountain	1.00	
	Any Water using Equipment	1.00	
1	Water Heater (gas) (elect.)	1.00	1.00
1	Sewer System—New, Replacement, or any Drainage System	4.00	4.00
	Grease or Sand Trap	2.00	
	Trailer Trap	2.00	
	Septic Disposal System	4.00	
WATER SOFTENERS			
	Nonpermanent Type	4.00	
	Permanent Type (connected to Drainage)	5.00	
SWIMMING POOLS			
	Private or Wading Pool	10.00	
	Public or Semi-public	20.00	

UNITS	DESCRIPTION	FEE	TOTAL
WATER DISTRIBUTION SYSTEM			
1	Single Family Dwelling	4.00	4.00
	Multiple Family Dwelling plus each unit	4.00 2.00	
	Commercial Bldg. per floor	6.00	
	Hotel or Motel plus each bath	4.00 1.50	
	Trailer Park plus each space	20.00 1.00	
	Irrigation	4.00	
GAS PIPING SYSTEM			
1	Single Family Dwelling	3.00	3.00
	Multiple Family Dwelling plus each unit	6.00 1.00	
	Commercial Bldg. per floor plus each unit	3.00 3.00	
	Gas Appliance (any type)	1.00	
AUTOMATIC FIRE EXTINGUISHING SYSTEM			
	Underground Piping	10.00	
	Distribution Piping ea. ft.	.01	
	Sprinkler Head each	.10	
	In Range Hood and Vent	5.00	
DRY STANDPIPE SYSTEM			
	Piping	50.00	
	Each Outlet	1.00	
WET STANDPIPE SYSTEM			
	Piping	5.00	
	Fire Hose Cabinet	1.00	
MINIMUM PERMIT FEE 4.00			
PIPELINE CONTRACTOR; SECT. 14-B.P.F. \$			
TOTAL PERMIT FEE \$ <u>19.00</u>			

I hereby certify that I have carefully examined and read the above application; that the same is true and correct; and that the work herein described is to be done in accordance with all the provisions of the applicable Ordinances of the City of Las Vegas, Nevada and the State Laws, whether herein specified or not.

Approval for the work under this permit will be given only after refuse and debris have been removed from job site and public right of way.

Signed: [Signature] Date: 6/6/78
Registered Master Plumber, Spec. Cont'r. or Owner

Building Division: MD Date: 6-6-78
Permit No. 6900-1 Permit Fee \$ 19.00

154-01-222

RECEIPT

MUST BE MACHINE VALIDATED

CITY OF LAS VEGAS, NEVADA

DEPARTMENT OF PUBLIC SERVICES - AIR CONDITIONING APPLICATION & PERMIT
 DIVISION OF BUILDING AND SAFETY

ADDRESS OF CONSTRUCTION: 4529 Alameda Avenue OWNER'S NAME: METROPOLITAN PARK CONSTRUCTION

CIRCLE: Addition; Remodel; New Bldg. TYPE OF BLDG: SFD APT. COMM. PUBLIC

CONTRACTOR'S NAME: CENTRAL AIR-CONDITIONING INC. STATE LICENSE #: 11997 CITY LICENSE #: 00057

UNITS	DESCRIPTION	FEE	TOTAL	UNITS	DESCRIPTION	FEE	TOTAL
	Unit heater - floor, wall or suspended	4.00			EVAPORATIVE COOLERS:		
	FOR EACH FORCED-AIR OR GRAVITY-TYPE FURNACE OR BURNER INCLUDING DUCTS AND VENT ATTACHED TO SUCH APPLIANCES:				5 outlets or under	3.00	
	Up to and including 100,000 B.t.u.'s	4.00			Over 5 and up to and including 10	5.00	
	Over 100,000 B.t.u.'s	6.00			Each additional outlet over 10	.25	
	FOR EACH HEATING APPLICATION, REFRIGERATION UNIT, COMFORT COOLING AND HEATING UNIT, ABSORPTION UNIT, COMPRESSOR OR BOILER:				VENTILATION:		
	Up to and including 3 ton or horsepower or absorption system up to and including 100,000 B.t.u.'s	4.00			For each fan connected to a single duct	1.00	
<u>1-3 1/2</u>	Over 3 ton or 3 horsepower up to and including 10, or absorption system over 100,000 B.t.u.'s up to and including 250,000 B.t.u.'s	7.00	<u>\$7.00</u>		For each commercial or industrial ventilation system	5.00	
	Over 10 ton or 10 horsepower up to and including 30, or absorption system over 250,000 B.t.u.'s up to and including 1,000,000 B.t.u.'s	12.00			For each commercial kitchen hood	5.00	
	Over 30 ton or 30 horsepower up to and including 50, or absorption system over 1,000,000 B.t.u.'s up to and including 1,700,000 B.t.u.'s	20.00			MISCELLANEOUS:		
	Over 50 ton or 50 horsepower, or absorption system over 1,700,000 B.t.u.'s	30.00			For each water cooling tower	8.00	
	FOR EACH AIR HANDLING UNIT INCLUDING DUCTS ATTACHED THERETO:				Duct work only - each opening	.25	
	Up to and including 10,000 CFM	2.00			For installation or relocation of each commercial or industrial incinerator	15.00	
	Over 10,000 CFM	4.00			Gas piping related to the air cond. work in single family dwelling only	3.00	
					For each appliance, piece of equipment, any mechanical work or alteration or replacement not included in this schedule, the permit fee shall be computed the same as building permit fees by using the cost of installation for the valuation amount.		
					FOR THE ISSUANCE OF EACH PERMIT	3.00	
					TOTAL PERMIT FEE \$		\$10.00

I hereby certify that I have carefully examined and read the above application; that the same is true and correct; and that the work herein described is to be done in accordance with all the provisions of the applicable Ordinances of the City of Las Vegas, Nevada and the State Laws, whether herein specified or not.

Approval for the work under this permit will be given only after refuse and debris have been removed from job site and public right of way.

SIGNED [Signature] Date 07/13/78
 Air Conditioning Contractor - Owner

BUILDING DIVISION MIS- Date 7-31-78

PERMIT NO. 8385-30 PERMIT FEE \$ 10.00

RECEIPT

MUST BE MACHINE VALIDATED

D. [unclear] 7-4-78

CITY OF LAS VEGAS, NEVADA

DEPARTMENT OF PUBLIC SERVICES - AIR CONDITIONING APPLICATION & PERMIT DIVISION OF BUILDING AND SAFETY

ADDRESS OF CONSTRUCTION: 4529 Alameda Avenue OWNER'S NAME: METROPOLITAN PARK CONSTRUCTION

CIRCLE: Addition; Remodel; New Bldg; TYPE OF BLDG: SFD APT. COMM. PUBLIC

CONTRACTOR'S NAME: CENTRAL AIR CONDITIONING INC. STATE LICENSE #: 11997 CITY LICENSE #: 00057

UNITS	DESCRIPTION	FEE	TOTAL	UNITS	DESCRIPTION	FEE	TOTAL
	Unit heater - floor, wall or suspended	4.00			EVAPORATIVE COOLERS:		
	FOR EACH FORCED-AIR OR GRAVITY-TYPE FURNACE OR BURNER INCLUDING DUCTS AND VENT ATTACHED TO SUCH APPLIANCES:				5 outlets or under	3.00	
	Up to and including 100,000 B.t.u.'s	4.00			Over 5 and up to and including 10	5.00	
	Over 100,000 B.t.u.'s	6.00			Each additional outlet over 10	.25	
	FOR EACH HEATING APPLICATION, REFRIGERATION UNIT, COMFORT COOLING AND HEATING UNIT, ABSORPTION UNIT, COMPRESSOR OR BOILER:				VENTILATION:		
	Up to and including 3 ton or horsepower or absorption system up to and including 100,000 B.t.u.'s	4.00			For each fan connected to a single duct	1.00	
	Over 3 ton or 3 horsepower up to and including 10, or absorption system over 100,000 B.t.u.'s up to and including 250,000 B.t.u.'s	7.00	7.00		For each commercial or industrial ventilation system	5.00	
-3 1/2	Over 10 ton or 10 horsepower up to and including 30, or absorption system over 250,000 B.t.u.'s up to and including 1,000,000 B.t.u.'s	12.00			For each commercial kitchen hood	5.00	
	Over 30 ton or 30 horsepower up to and including 50, or absorption system over 1,000,000 B.t.u.'s up to and including 1,700,000 B.t.u.'s	20.00			MISCELLANEOUS:		
	Over 50 ton or 50 horsepower, or absorption system over 1,700,000 B.t.u.'s	30.00			For each water cooling tower	8.00	
	FOR EACH AIR HANDLING UNIT INCLUDING DUCTS ATTACHED THERETO:				Duct work only - each opening	.25	
	Up to and including 10,000 CFM	2.00			For installation or relocation of each commercial or industrial incinerator	15.00	
	Over 10,000 CFM	4.00			Gas piping related to the air cond. work in single family dwelling only	3.00	
					For each appliance, piece of equipment, any mechanical work or alteration or replacement not included in this schedule, the permit fee shall be computed the same as building permit fees by using the cost of installation for the valuation amount.		
					FOR THE ISSUANCE OF EACH PERMIT	3.00	
					TOTAL PERMIT FEE \$		\$10.00

I hereby certify that I have carefully examined and read the above application; that the same is true and correct; and that the work herein described is to be done in accordance with all the provisions of the applicable Ordinances of the City of Las Vegas, Nevada and the State Laws, whether herein specified or not.

Approval for the work under this permit will be given only after refuse and debris have been removed from job site and public right of way.

SIGNED: [Signature] Date: 07/13/78
Air Conditioning Contractor - Owner

BUILDING DIVISION: MIS- Date: 7-31-78

PERMIT NO. 8385-30 PERMIT FEE \$ 10.00

RECEIPT

MUST BE MACHINE VALIDATED

CITY OF LAS VEGAS, NEVADA

DEPARTMENT OF PUBLIC SERVICES - ELECTRICAL APPLICATION & PERMIT
 DIVISION OF BUILDING AND SAFETY

ADDRESS OF CONSTRUCTION: 4529 Alameda Ave. OWNER'S NAME: Metropolitan-Nevada Corp.

CIRCLE: New Bldg; Add'n.; Remodel; TYPE OF BLDG.: SFD. ART. PUBLIC COMM.

CONTRACTOR'S NAME: Urban Electric Corp. STATE LICENSE # 8016A CITY LICENSE # 9012

NUMBER	FIXTURE OR INSTALLATION	UNIT PRICE	TOTAL
	Rm addition, carport or garage enclosure	4.00	
	Temporary power	4.00	
48	Light, receptacle or switch outlet	.20	9.60
	Wall or ceiling space heater	.35	
1	Garbage grinder outlet	.35	.35
1	Dishwasher outlet	.35	.35
1	Clothes dryer outlet	.35	.35
1	Automatic clothes washer	.35	.35
	Electric range outlet	.35	
	Electric water heater outlet	.35	
1	Special purpose outlet	.35	.35
	X-ray unit and its appurtenances	5.00	
	Watts of festoon lighting (Watts) First 3,000 watts for each additional thousand watts	4.00 1.50	
	Horsepower each motor first horsepower or less for each additional horsepower	1.75 .35	
1	Electric service (including any single meter socket) for each additional socket	3.00 .35	3.00
	Air conditioning service	4.50	
	Each KW(KVA) Generator (Transformer, Welder) First 100 KVA for each additional KW(KVA)	2.00 .01	
	Speaker, signal or alarm outlet	.15	
	Amplifiers	.50	
	Control panels	.25	
	Main control racks	1.00	
	T.V. and radio antennas-master system only	.75	
	Minimum fee for any permit	4.00	
TOTAL FEE			14.35

Approval for the work under this permit will be given only after refuse and debris have been removed from job site and public right of way.

I hereby certify that I have carefully examined and read the above application; that the same is true and correct; and that the work herein described is to be done in accordance with all the provisions of the applicable Ordinances of the City of Las Vegas, Nevada and State laws whether herein specified or not.

SIGNED [Signature] DATE 8/25/78
 MASTER (ELECTRICIAN) (TECHNICIAN) (OWNER)
 BUILDING DIVISION: [Signature] DATE 8/25/78
 PERMIT NO.: 902672 PERMIT FEE: \$ 14.35

RECEIPT
 MUST BE MACHINE VALIDATED

L. Oaly July 28, 1980

BUILDING DEPARTMENT
CITY OF LAS VEGAS

CORRECTION NOTICE

Complied 7-24-80 24/80

Job Located at 4529 ALEMEDA

I have this day inspected this structure and these premises and have found the following violations of City and/or State laws governing same:

TIME LIMIT

OWNER HAS AGREED TO
REMOVING CAR-PORT IN
FRONT FROM THE 20'
SET BACK AREA.

THIS WORK TO BE COMPLETE
WITHIN 30 DAYS FROM
THIS DAY OR CITATION TO APPEAR
IN COURT WILL BE GIVEN

You are hereby notified to correct above violation and call for re-inspection.

3rd NOTICE

Date 6/23/80

[Signature]
Inspector

23.03

Do not remove this tag!

Gloria Caly 10-22-80

B

DIVISION of BUILDING & SAFETY - CITY of LAS VEGAS, NEVADA

OWNER Metropolitan Nev. ADDRESS 4529 Alameda Av.e DATE 5/26/78
 GEN. CONT. Same TYPE OF STRUCTURE SFD
 PERMIT NO. 6679-1 LEGAL DESCRIPTION Metropolitan Park # 18

BUILDING	MECHANICAL	ELECTRICAL
Investigation	Plumbing Cont. <i>Starling</i>	Temp. pole cont.
Location & Footing <i>M 26-12-78</i>	Permit No. <i>6700-1</i> Date <i>6-6-78</i>	Permit No. _____ Date _____
Stem Wall	Heat & Vent. A/C Cont. <i>Central A.C.</i>	Inspection _____ Date _____
Concrete Slab Floor <i>M 26-13-78</i>	Permit No. <i>8385-30</i> Date <i>2-3-78</i>	Electrical Cont. <i>Urban</i>
Floor Framing	Sewer Cont. Metropolitan Nev.	Permit No. <i>9026-12</i> Date <i>5-25-78</i>
Fireplace Footing	Permit No. <i>6678</i> Date _____	Fixtures Cont. _____ Date _____
Chimney Steel	Rough Soil <i>KW 6-9-78</i>	Permit No. _____ Date _____
Vert. Steel Reinf.	Rough Water <i>KW 6-9-78</i>	Slab _____
Horiz. Steel Reinf.	Top Out <i>KW 8-7-78</i>	Rough <i>KW 8-12-78</i>
Roof Sheathing <i>VH 4-78</i>	Rough Gas <i>KW 8-7-78</i>	Final Rough _____
Framing <i>VH 8-12-78</i>	A/C Rough Duct <i>KW 8-7-78</i>	Final Fixture _____
Backing for siding	Ref. Rough Piping _____	Final Electrical <i>Rp 11-15-78</i>
Ext. Lath <i>VH 8-24-78</i>	Final Plumbing <i>JC 11-4-78</i>	Temporary Service _____
Ext. Scratch <i>VH 9-12-78</i>	Final Gas <i>JC 11-4-78</i>	MISCELLANEOUS
Ext. Brown <i>VH 9-10-78</i>	Final Air Cond. <i>JC 10-23-78</i>	Grading & Drainage _____
Int. Lath	Final Refrig. _____	On Site Parking Spaces _____ App. _____
Int. Brown	Final Sewer <i>KW 8-12-78</i>	Eng. Approval of _____
Drywall <i>VH 8-30-78</i>	Final Septic Tank _____	Off Site Improvements _____
Insulation <i>VH 8-28-78</i>		
Finish Building <i>VH 11-27-78</i>		
for Occu.		

INSPECTOR: _____ DATE _____

APPROVED FOR OCCUPANCY & METER _____

PLEASE NOTE REMARKS ON REVERSE SIDE

4529 Alameda Ave.

LOG # _____ AREA # _____ 76-11-4

T-3-2

Torrison, Kiyooka / 11-12-80

DIVISION OF BUILDING & SAFETY
CITY OF LAS VEGAS

Telephone
386-6251

Compl. (Removed)

PERMIT REQUIRED

Permits Required: No person, firm, or corporation shall erect, construct, enlarge, alter, repair, move, improve, remove, convert, or demolish any building or structure in the City, or cause same to be done, without first obtaining a separate permit.

Where work for which a permit is required by this Code is started or proceeded with prior to obtaining said permit, the fees shall be DOUBLED.

Date 5-15-80

Type of work PATIO COVER

Address of work 4529 ALEMEDA

Remarks:

THIS STRUCTURE ILLEGAL
A - 30 FT SET BACK FROM
PROPERTY LINE MUST BE
MAINTAINED - 3rd Floor

Signed CITY HALL
Inspector #62

2 days to
COMPLY

76-12-2