

. 6301 CAMBRIA AVE. .

LOT 7 BLK 9 CHARLESNT HGTS 51-C ZONE R-1

G. Gatewood 2/7/79

CITY OF LAS VEGAS, NEVADA

DEPARTMENT OF PUBLIC SERVICES - APPLICATION AND PERMIT FOR PLUMBING
 • DIVISION OF BUILDING AND SAFETY

ADDRESS OF CONSTRUCTION: 6301 Cambria OWNER'S NAME: BECKER ENTERPRISES

CIRCLE: New Bldg. Add'n: Remodel: TYPE OF BLDG.: SFD. APT. PUBLIC COMM.

CONTRACTOR'S NAME: BIG TOWN PLUMBING STATE LICENSE # 3241A CITY LICENSE # 01201

UNITS	DESCRIPTION	FEE	TOTAL
1	Bathtub	1.00	1.00
1	Shower	1.00	1.00
2	Lavatory	1.00	2.00
2	Toilet	1.00	2.00
	Urinal	1.00	
	Floor Drain	1.00	
	Floor Sink	1.00	
	Wash Tray	1.00	
1	Sink	1.00	1.00
1	Garbage Disposal	1.00	1.00
	Garbage Disposal (comm.)	3.00	
	Clothes Dryer (gas)	1.00	
1	Clothes Washer	1.00	1.00
	Clothes Washer (comm.)	5.00	
1	Dishwasher	1.00	1.00
	Dishwasher (commercial)	5.00	
	Dental Unit	10.00	
	Drinking Fountain	1.00	
	Any Water using Equipment	1.00	
1	Water Heater (gas) (elect.)	1.00	1.00
1	Sew. System - New, Replacement		
	any Drainage System		
	Grease and Trap	2.00	
	Trap	2.00	
	Septic Disposal System	4.00	
WATER SOFTENERS			
	Nonpermanent Type	4.00	
	Permanent Type (connected to Drainage)	5.00	
SWIMMING POOLS			
	Private or Wading Pool	10.00	
	Public or Semi-public	20.00	

UNITS	DESCRIPTION	FEE	TOTAL
WATER DISTRIBUTION SYSTEM			
1	Single Family Dwelling	4.00	4.00
	Multiple Family Dwelling plus each unit	4.00 2.00	
	Commercial Bldg. per floor	6.00	
	Hotel or Motel plus each bath	4.00 1.50	
	Trailer Park plus each space	20.00 1.00	
	Irrigation	4.00	
GAS PIPING SYSTEM			
	Single Family Dwelling	3.00	
	Multiple Family Dwelling plus each unit	6.00 1.00	
	Commercial Bldg. per floor plus each unit	3.00 1.00	
	Gas Appliances (all type)		
AUTOMATIC FIRE EXTINGUISHING SYSTEM			
	Underground Piping	16.00	
	Distribution Piping ea. ft.	.01	
	Sprinkler Head each	10	
	In Range Hood and Vent	5.00	
DRY STANDPIPE SYSTEM			
	Piping	50.00	
	Each Outlet	1.00	
WET STANDPIPE SYSTEM			
	Piping	5.00	
	Fire Hose Cabinet	1.00	
	MINIMUM PERMIT FEE	4.00	
PIPELINE CONTRACTOR, SECT. 14-B.P.F. \$			
TOTAL PERMIT FEE \$			19.00

I hereby certify that I have carefully examined and read the above application, that the same is true and correct, and that the work herein described is to be done in accordance with all the provisions of the applicable Ordinances of the City of Las Vegas, Nevada and the State Laws, whether herein specified or not.

Approval for the work under this permit will be given only after refuse and debris have been removed from job site and public right of way.

Signed: [Signature] Date: _____
 Registered Master Plumber, Spec. Cont'r. or Owner
 Building Division: NM Date: 12-30-77
 Permit No: 2556-6 Permit Fee \$ 19.00

154-01-222

RECEIPT

MUST BE MACHINE VALIDATED

G. Gatewood 2/7/79

14-15

CITY OF LAS VEGAS, NEVADA
DEPT. OF PUBLIC SERVICES

LOG NO. & AREA 4-273
DIVISION OF BUILDING & SAFETY
PHONE: 386-6251

CONST. VAL. 27,056

APPLICATION & BUILDING PERMIT - for:
Dwellings, Duplexes, Misc. Residential Const.

ADDRESS OF CONSTRUCTION: 6301 Cambria Avenue

OWNER: Becker & Sons

LOT(s) 7 BLOCK 9 SUBDIVISION Charleston Heights 51-C ZONE: _____

Existing structure on lot: Dwelling Accessory bldgs. Vacant lot Other

PROPOSED CONSTRUCTION: Single Family Residence USE: R-1

MATERIALS OF CONSTRUCTION: Wood Frame Concrete Block Reinforced Concrete Steel Frame

SQ. FEET OF FLOOR AREAS: 1st 1319 2nd _____ 3rd _____ Other _____ TOTAL SQ. FT. 1319

FIRE ZONE: _____ Occupancy Group _____

CONST. TYPE: _____

ARCHITECT: Becker & Sons ENGINEER: Becker & Sons NO. of UNITS 1 NO. of STORIES 1

Plans Submitted: Yes No Calculations Submitted: Yes No Sewer Fee Req'd. Yes No

CONTRACTOR: Becker Built STATE LICENSE # 11092 CITY LICENSE # C11520

ADD'L. PERMITS REQ'D: Air Cond. Elec. Plumbing Signs Paving Fence Public Walks Curb-gutters
Incinerators Fire Sprinkling System

M-1319A

SEE ATTACHED
PLOT PLAN

Width _____ Ft.

Front sidewalk

CONDITIONS OF THE PERMIT:

1. I agree to call the City Building Department for inspections before concrete is poured, before rough wiring, electrical, plumbing, framing is covered. Also for air conditioning, sheet-rock and sheathing inspection.
2. I agree that when the job is completed that I will call for final inspection before occupancy.
3. I agree to perform all construction in accordance with City Ordinances and Building Codes.
4. The Contractor's signature below denotes authority from the owner to sign in his behalf and that the owner is aware of all requirements of this application and permit. Separate permits must be taken out for work outlined above this agreement.
5. I have read and understand the contents of this application and permit; I hereby state that the information I have supplied on this application is true and correct.

SIGNED: _____ BECKER BUILT Contractor

BY: _____ Ernest A. Becker, Jr. Agent or Owner

Project Manager
CLARK COUNTY HEALTH DEPT. Date _____

LAS VEGAS FIRE DEPARTMENT Date _____

PLANNING DEPT.: _____ Date: 12-21-77

PUBLIC WORKS DEPT.: _____ Date: 12-23-77

BUILDING DEPT.: _____ Date: 12-30-77

PERMIT NO.: 2605-11 PERMIT FEE: 197.-

154-01-220
76-17-14

RECEIPT

MUST BE MACHINE VALIDATED

D. Gatewood 2/7/79

CITY OF LAS VEGAS, NEVADA

DEPARTMENT OF PUBLIC SERVICES—ELECTRICAL APPLICATION & PERMIT DIVISION OF BUILDING AND SAFETY

ADDRESS OF CONSTRUCTION: 6301 Cambria Ave.

OWNER'S NAME: H.A. Becker Ent.

CIRCLE: (New Bldg) Add'n.; Remodel; TYPE OF BLDG.: (SFD) APT. PUBLIC COMM.

CONTRACTOR'S NAME: Danton Electric Co., Inc. STATE LICENSE # 9750 CITY LICENSE # 011-249

NUMBER	FIXTURE OR INSTALLATION	UNIT PRICE	TOTAL
	Rm addition, carport or garage enclosure	4.00	
	Temporary power	4.00	
55	Light, receptacle or switch outlet	.20	11.00
	Wall or ceiling space heater	.35	
1	Garbage grinder outlet	.35	.35
1	Dishwasher outlet	.35	.35
1	Clothes dryer outlet	.35	.35
1	Automatic clothes washer	.35	.35
1	Electric range outlet	.35	.35
1	Electric water heater outlet	.35	.35
	Special purpose outlet	.35	
	X-ray unit and its appurtenances	5.00	
	Watts of festoon lighting (Watts) First 3,000 watts for each additional thousand watts	4.00 1.50	
	Horsepower—each motor first horsepower or less for each additional horsepower	1.75 .35	
1	Electric service (including any single meter socket) for each additional socket	3.00 .35	3.00
1	Air conditioning service	1.50	1.50
	Each KW(KVA) Generator (Transformer, Welder) First 100 KVA for each additional KW(KVA)	2.00 .01	
	Speaker, signal or alarm outlet	.15	
	Amplifiers	.50	
	Control panels	.25	
	Main control racks	1.00	
	T.V. and radio antennas—master system only	.75	
	Minimum fee for any permit	4.00	
	TOTAL FEE		19.60

Approval for the work under this permit will be given only after refuse and debris have been removed from job site and public right of way.

I hereby certify that I have carefully examined and read the above application; that the same is true and correct; and that the work herein described is to be done in accordance with all the provisions of the applicable Ordinances of the City of Las Vegas, Nevada and State laws whether herein specified or not.

SIGNED: [Signature] DATE: 1-5-78
MASTER (ELECTRICIAN) (TECHNICIAN) (OWNER)

BUILDING DIVISION: [Signature] DATE: 2-10-78

PERMIT NO.: 35986 PERMIT FEE: 17.60

RECEIPT

MUST BE MACHINE VALIDATED

D. Gatewood 2/7/79

CITY OF LAS VEGAS, NEVADA

DEPARTMENT OF PUBLIC SERVICES—ELECTRICAL APPLICATION & PERMIT DIVISION OF BUILDING AND SAFETY

ADDRESS OF CONSTRUCTION: 6301 Cambria Ave.

OWNER'S NAME: E.A. Becker Entrp.

CIRCLE: New Bldg; Add'n.; Remodel; TYPE OF BLDG.: SFD. APT. PUBLIC COMM.

CONTRACTOR'S NAME: Denton Electric Co., Inc. STATE LICENSE # 9750 CITY LICENSE # 611-249

NUMBER	FIXTURE OR INSTALLATION	UNIT PRICE	TOTAL
	Rm addition, carport or garage enclosure	4.00	
1	Temporary power	4.00	4.00
	Light, receptacle or switch outlet	.20	
	Wall or ceiling space heater	.35	
	Garbage grinder outlet	.35	
	Dishwasher outlet	.35	
	Clothes dryer outlet	.35	
	Automatic clothes washer	.35	
	Electric range outlet	.35	
	Electric water heater outlet	.35	
	Special purpose outlet	.35	
	X-ray unit and its appurtenances	5.00	
	Watts of festoon lighting (Watts) First 3,000 watts for each additional thousand watts	4.00 1.50	
	Horsepower—each motor first horsepower or less for each additional horsepower	1.75 .35	
	Electric service (including any single meter socket) for each additional socket	3.00 .35	
	Air conditioning service	1.50	
	Each KW(KVA) Generator (Transformer, Welder) First 100 KVA for each additional KW(KVA)	2.00 .01	
	Speaker, signal or alarm outlet	.15	
	Amplifiers	.50	
	Control panels	.25	
	Main control racks	1.00	
	T.V. and radio antennas—master system only	.75	
	Minimum fee for any permit	4.00	
	TOTAL FEE		4.00

Approval for the work under this permit will be given only after refuse and debris have been removed from job site and public right of way.

I hereby certify that I have carefully examined and read the above application; that the same is true and correct; and that the work herein described is to be done in accordance with all the provisions of the applicable Ordinances of the City of Las Vegas, Nevada and State laws whether herein specified or not.

SIGNED E.H. Denton
MASTER (ELECTRICIAN) (TECHNICIAN) (OWNER)

DATE 2-7-78

BUILDING DIVISION 710

DATE 2-9-78

PERMIT NO. 3597

PERMIT FEE: \$ 34.00

#3597 SR#02201
CITY - LAS VEGAS
BLDG. & SAFETY
02/10/78

MUST BE MACHINE VALIDATED

D. Gatewood 2/7/79

CITY OF LAS VEGAS, NEVADA

DEPARTMENT OF PUBLIC SERVICES - AIR CONDITIONING APPLICATION & PERMIT
 DIVISION OF BUILDING AND SAFETY

ADDRESS OF CONSTRUCTION: 6301 Cambria Avenue

OWNER'S NAME: Becker Enterprises

CIRCLE: Addition; Remodel; New Bldg; TYPE OF BLDG.: SFD APT. COMM. PUBLIC

CONTRACTOR'S NAME: CENTRAL AIR CONDITIONING INC. STATE LICENSE # 11997 CITY LICENSE # 00057

UNITS	DESCRIPTION	FEE	TOTAL	UNITS	DESCRIPTION	FEE	TOTAL
	Unit heater - floor, wall or suspended	4.00			EVAPORATIVE COOLERS:		
	FOR EACH FORCED-AIR OR GRAVITY-TYPE FURNACE OR BURNER INCLUDING DUCTS AND VENT ATTACHED TO SUCH APPLIANCES:				5 outlets or under	3.00	
		Up to and including 100,000 B.t.u.'s	4.00		Over 5 and up to and including 10	5.00	
		Over 100,000 B.t.u.'s	6.00		Each additional outlet over 10	.25	
	FOR EACH HEATING APPLICATION, REFRIGERATION UNIT, COMFORT COOLING AND HEATING UNIT, ABSORPTION UNIT, COMPRESSOR OR BOILER:				VENTILATION:		
		Up to and including 3 ton or horsepower, or absorption system up to and including 100,000 B.t.u.'s	4.00		For each fan connected to a single duct	1.00	
1-3		Over 3 ton or 3 horsepower up to and including 10, or absorption system over 100,000 B.t.u.'s up to and including 250,000 B.t.u.'s	7.00	\$7.00	For each commercial or industrial ventilation system	5.00	
		Over 10 ton or 10 horsepower up to and including 30, or absorption system over 250,000 B.t.u.'s up to and including 1,000,000 B.t.u.'s	12.00		For each commercial kitchen hood	5.00	
		Over 30 ton or 30 horsepower up to and including 50, or absorption system over 1,000,000 B.t.u.'s up to and including 1,700,000 B.t.u.'s	20.00		MISCELLANEOUS:		
	Over 50 ton or 50 horsepower, or absorption system over 1,700,000 B.t.u.'s	30.00		For each water cooling tower	8.00		
	FOR EACH AIR HANDLING UNIT INCLUDING DUCTS ATTACHED THERETO:			Duct work only - each opening	.25		
		Up to and including 10,000 CFM	2.00		For installation or relocation of each commercial or industrial incinerator	15.00	
		Over 10,000 CFM	4.00		Gas piping related to the air cond. work in single family dwelling only	3.00	
				For each appliance, piece of equipment, any mechanical work or alteration or replacement not included in this schedule, the permit fee shall be computed the same as building permit fees by using the cost of installation for the valuation amount:			
				FOR THE ISSUANCE OF EACH PERMIT		3.00	
				TOTAL PERMIT FEE \$		\$10.00	

I hereby certify that I have carefully examined and read the above application; that the same is true and correct; and that the work herein described is to be done in accordance with all the provisions of the applicable Ordinances of the City of Las Vegas, Nevada and the State Laws, whether herein specified or not.

Approval for the work under this permit will be given only after refuse and debris have been removed from job site and public right of way.

SIGNED Karlene Appenroth Date January 17, 1978
 Air Conditioning Contractor - Owner

BUILDING DIVISION MM Date 2-10-78

PERMIT NO. 3611-6 PERMIT FEE \$ 10.00

RECEIPT

MUST BE MACHINE VALIDATED

12890

G. Gatewood 4-11-79

CITY OF LAS VEGAS, NEVADA

CONST. VAL. \$ 1650.00

LOG NO. & AREA _____

DEPARTMENT OF PUBLIC SERVICES
DIVISION OF BUILDING & SAFETY

APPLICATION & BUILDING PERMIT - for:
Fence, Wall, Retaining Wall.

ADDRESS OF CONSTRUCTION:

6301 Cambria

OWNER:

Ball James

LOT(s)

7

BLOCK

9

SUBDIVISION

CHAR Hgt 351-C

ZONE:

R1

Materials of Construction:

Block

Concrete

Wire

Wood

Other

Yes No

PLANS:

CALCS:

ARCHITECT: _____

ENGINEER: _____

CONTRACTOR:

Owner

STATE LICENSE # _____

CITY LICENSE # _____

TOTAL SQUARE FEET:

660

TOTAL LINEAL FEET: 110

Remarks:

110 x 6

CONDITIONS OF THE PERMIT:

1. Any type of retaining wall must be engineered by a Civil or Structural Engineer.
2. If a home owner takes out the Building Permit and if the owner sublets the work to a Contractor, then the Contractor must take out the permit and pay for it.
3. No fence or wall can be built on City property or rights-of-way, but this is not intended to preclude construction within utility easements if utilities will not be damaged or made inaccessible.
4. The fence or wall shall not enclose any water meter, light standard, or fire alarm box and shall not come closer than 24" from the nearest fire hydrant outlet.
5. Department inspectors must approve footings before concrete is poured and block wall reinforcing before grouting is done.
6. Maximum height of any wall or fence is 6', side and rear yards; 4' maximum in front yard with the vertical surface above the height of 2' - 50% open.
7. I must not obstruct required onsite parking space (2 spaces for each dwelling unit) by the erection of this fence or wall.
8. By the signing of this application I herewith agree to the requirements outlined above.

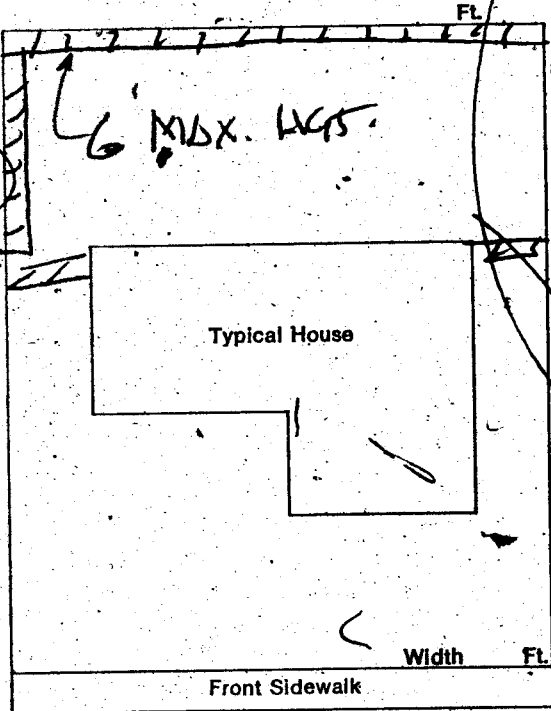

1 LULA \$.00
 WALL \$ 15.00
 STL \$ 15.00
 TOTL \$ 15.00
 CHEK \$ 15.00

A#2405 SR#001/01
 CITY - LAS VEGAS
 BLDG. & SAFETY

SIGNED:

CONTRACTOR

AGENT

OWNER

DATE:

PLANNING DEPT: _____

Date:

3/26/79

PUBLIC WORKS DEPT: _____

Date:

3-16-79

BUILDING DIVISION: _____

Date:

3/26/79

#1285)

PERMIT NO:

2405

PERMIT FEE \$

15.00

RECEIPT

MUST BE MACHINE VALIDATED

G. Gatewood 4-11-79

CITY OF LAS VEGAS, NEVADA

CONST. VAL. \$ 1650.00

LOG NO. & AREA _____
DEPARTMENT OF PUBLIC SERVICES
DIVISION OF BUILDING & SAFETY

APPLICATION & BUILDING PERMIT - for:
Fence, Wall, Retaining Wall.

ADDRESS OF CONSTRUCTION: 6301 Cambria OWNER: Ball, James

LOT(s) 7 BLOCK 9 SUBDIVISION CHAR Hgt 351-C ZONE: R1

Materials of Construction: Block Concrete Wire Wood Other Yes No
PLANS:
CALCS:

ARCHITECT: _____ ENGINEER: _____
CONTRACTOR: Owner STATE LICENSE # _____ CITY LICENSE # _____

TOTAL SQUARE FEET: 660 TOTAL LINEAL FEET: 110

Remarks:
110 x 6

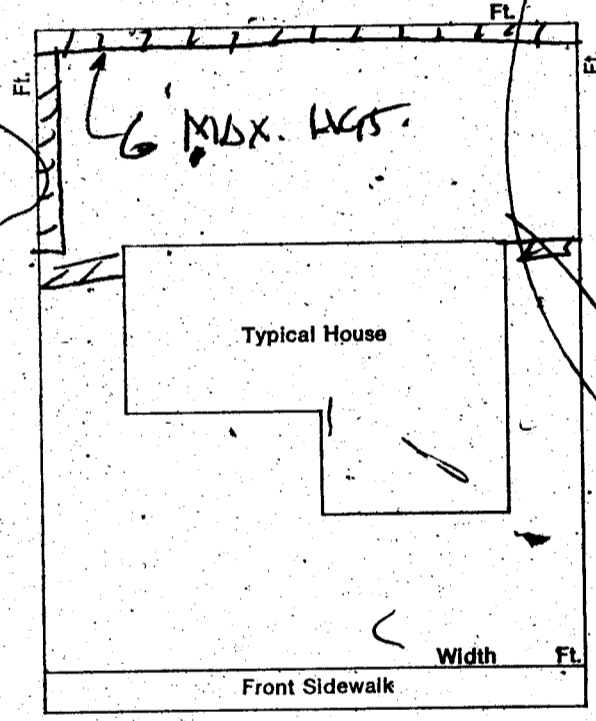

CONDITIONS OF THE PERMIT:

1. Any type of retaining wall must be engineered by a Civil or Structural Engineer.
2. If a home owner takes out the Building Permit and if the owner sublets the work to a Contractor, then the Contractor must take out the permit and pay for it.
3. No fence or wall can be built on City property or rights-of-way, but this is not intended to preclude construction within utility easements if utilities will not be damaged or made inaccessible.
4. The fence or wall shall not enclose any water meter, light standard, or fire alarm box and shall not come closer than 24" from the nearest fire hydrant outlet.
5. Department Inspectors must approve footings before concrete is poured and block wall reinforcing before grouting is done.
6. Maximum height of any wall or fence is 6', side and rear yards; 4' maximum in front yard with the vertical surface above the height of 2' - 50% open.
7. I must not obstruct required onsite parking space (2 spaces for each dwelling unit) by the erection of this fence or wall.
8. By the signing of this application I herewith agree to the requirements outlined above.

1 LULA \$.00
 WALL \$ 15.00
 STL \$ 15.00
 TOTL \$ 15.00
 CHEK \$ 15.00
 A#2405 SR#001/01
 CITY - LAS VEGAS
 BLDG. & SAFETY

SIGNED: *James Ball* CONTRACTOR AGENT OWNER DATE: 3/27/79

PLANNING DEPT: _____ Date: 3/26/79
 PUBLIC WORKS DEPT: _____ Date: 3-16-79
 BUILDING DIVISION: _____ Date: 3/26/79
 #12850 PERMIT NO: 2405 PERMIT FEE \$ 15.00

RECEIPT

MUST BE MACHINE VALIDATED

Steven Kyrillos 3/3/81

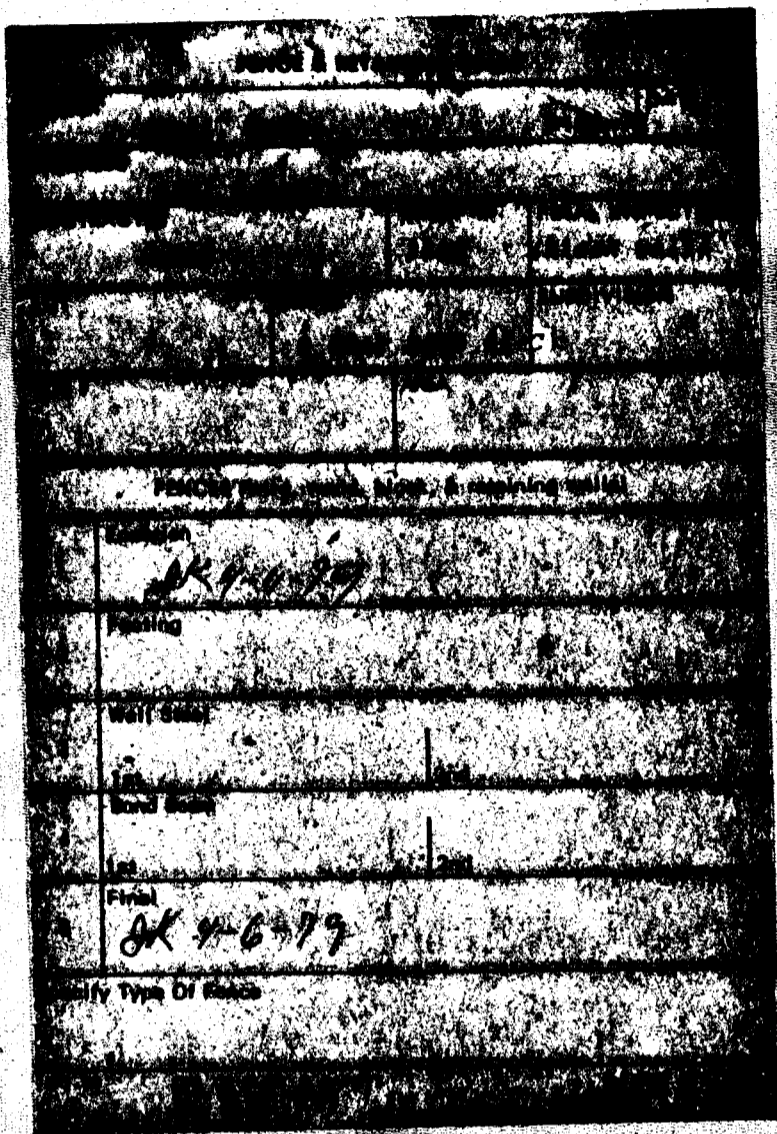

DIVISION of BUILDING & SAFETY – CITY of LAS VEGAS, NEVADA

OWNER Becker & Sons ADDRESS 6301 Cambria Ave. DATE 1-3-78
 GEN. CONT. Becker TYPE OF STRUCTURE SFD
 PERMIT NO. 2605-11 LEGAL DESCRIPTION L 7 B 9 Charleston Heights 51-C

BUILDING	MECHANICAL	ELECTRICAL
Investigation	Plumbing Cont. <u>Big Town</u>	Temp. pole cont. <u>Denton</u>
Location & Footing <u>SC 12-30-77</u>	Permit No. <u>2550-6</u> Date	Permit No. <u>3597</u> Date <u>2-9-78</u>
Stem Wall <u>SC 1-4-78</u>	Heat & Vent. A/C Cont. <u>Central ac</u>	Inspection <u>10-2-10-78</u> Date
Concrete Slab Floor <u>SC 1-9-78</u>	Permit No. <u>3611-6</u> Date <u>2-20-78</u>	Electrical Cont. <u>Denton</u>
Floor Framing	Sewer Cont. <u>Becker</u>	Permit No. <u>3528-6</u> Date <u>2-10-78</u>
Fireplace Footing	Permit No. <u>2604</u> Date	Fixtures Cont.
Chimney Steel	Rough Soil <u>KW 1-10-78</u>	Permit No. Date
Vert. Steel Reinf.	Rough Water <u>KW 1-10-78</u>	Slab
Horiz. Steel Reinf.	Top-Out <u>KW 1-6-78</u>	Rough <u>2-17-78</u>
Roof Sheathing <u>SC 3-3-78</u>	Rough Gas	Final Rough
Framing <u>2-8-78</u>	A/C Rough Duct <u>KW 9-9-78</u>	Final Fixture
Backing for siding	Ref. Rough Piping	Final Electrical <u>M 4-1-78</u>
Ext. Lath <u>3-28-78</u>	Final Plumbing <u>M 6-1-78</u>	Temporary Service
Ext. Scratch <u>4-20-78</u>	Final Gas	MISCELLANEOUS
Ext. Brown <u>5-2-78</u>	Final Air Cond. <u>M 6-1-78</u>	
Int. Lath	Final Refrig.	
Int. Brown	Final Sewer <u>KW 1-10-78</u>	
Drywall	Final Septic Tank	Grading & Drainage
Insulation		On-Site Parking Spaces App.
Final Building <u>H B 6-P-78</u>		Eng. Approval of
Appr. for Occu.		Off Site Improvements

INSPECTOR: _____ DATE: _____

APPROVED FOR OCCUPANCY & METER H B 6-P-78

PLEASE NOTE REMARKS ON REVERSE SIDE 6301 Cambria Ave. LOG # _____ AREA # _____ T 27-3 78-114