

6429 Addely Dr

Lot 4 Blk 1 Approach 80 Zone RPD8

Theresa Kyriakos 1-6-81

### CITY OF LAS VEGAS, NEVADA

LOG NO. & AREA T15 380

CONST. VAL. \$ 21,530.00

DEPARTMENT OF PUBLIC SERVICES  
DIVISION OF BUILDING AND SAFETY

APPLICATION & BUILDING PERMIT - for:  
Dwellings, Duplexes, Misc. Residential Const.

ADDRESS OF CONSTRUCTION: 6429 Ardway Dr

OWNER: Dasco, Inc.

LOT(s) 4 BLOCK 1 SUBDIVISION Approach 80 ZONE R-908

Existing structure on lqt: Dwelling  Accessory Bldgs.  Vacant Lot  Other

PROPOSED CONSTRUCTION: Framed Siding USE: SFD

MATERIALS OF CONSTRUCTION: Wood Frame  Concrete Block  Reinforced Concrete  Steel Frame

SQUARE FEET OF FLOOR AREAS: 1st 790 2nd 231 Other 52 TOTAL SQ. FT. 1073

FIRE ZONE: R-3 Occupancy Group R-3 CONST. TYPE: V-N

ARCHITECT: Steve Mead Assoc. ENGINEER: VTH NO. of UNITS 1 NO. of STORIES 1

Plans Submitted: Yes  No  Calculations Submitted: Yes  No  Sewer Fee Req'd.: Yes  No

CONTRACTOR: Dasco, Inc. STATE LICENSE # 9778A CITY LICENSE # C11-2812-05733

ADD'L. PERMITS REQ'D.: Air Cond  Elec.  Plumbing  Signs  Paving  Fence  Public Works  Curb-gutters   
Incinerators  Fire Sprinkling System

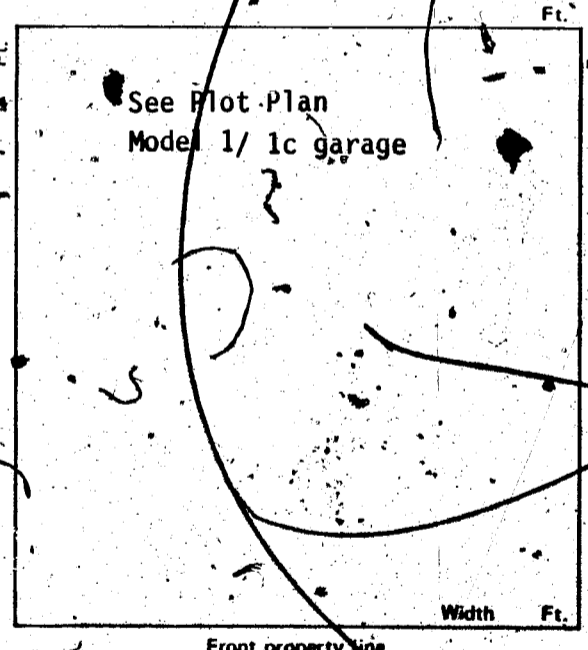

#### CONDITIONS OF THE PERMIT:

1. I agree to call the City Building Department for inspections before concrete is poured, before rough wiring, electrical, plumbing, framing is covered. Also for Air conditioning, drywall and sheathing inspection.
2. I agree that when the job is completed that I will call for final inspection before occupancy.
3. I agree to perform all construction in accordance with City Ordinances and Building Codes.
4. The Contractor's signature below denotes authority from the owner to sign in his behalf and that the owner is aware of all requirements of this application and permit. Separate permits must be taken out for work outlined above this agreement.
5. I have read and understand the contents of this application and permit; I hereby state that the information I have supplied on this application is true and correct.

Approval for the work under this permit will be given only after refuse and debris have been removed from job site and public right of way.

SIGNED: Dasco, Inc. Contractor  
BY: [Signature] Agent pr Owner

PLANNING DEPT.: [Signature] Date: 11/18/80

PUBLIC WORKS DEPT: Nash Date: 11-18-80

BUILDING DIVISION: M.J. Date: 12-10-80

PERMIT NO.: 7636-36 PERMIT FEE \$ 114.00

1721-2401

RECEIPT

MUST BE MACHINE VALIDATED

Theresa Kyriakis 1-6-81

# CITY OF LAS VEGAS, NEVADA

DEPARTMENT OF PUBLIC SERVICES — PLUMBING APPLICATION & PERMIT  
DIVISION OF BUILDING AND SAFETY

ADDRESS OF CONSTRUCTION: **6029 ADDELY DRIVE**

OWNER'S NAME: **DASCO, INC**

CIRCLE: Addition; Remodel; New Bldg. TYPE OF BLDG.: SFD APT. COMM. PUBLIC

CONTRACTOR'S NAME: **FREMONT PLUMBING, INC**

STATE LICENSE # **10035A** CITY LICENSE # **8014**

| UNITS                            | DESCRIPTION   | FEE   | TOTAL |
|----------------------------------|---|-------|-------|
| <b>PERMIT ISSUANCE</b>           |   |       |       |
| 1                                | For Issuing Each Permit   | 10.00 | 10.00 |
|                                  | For Issuing Each Supplemental Permit                                | 4.50  |       |
| <b>FIXTURE CHARGE</b>            |   |       |       |
| 1                                | Bath Tub  | 2.00  | 2.00  |
|                                  | Shower  | 2.00  |       |
| 1                                | Lavatory  | 2.00  | 2.00  |
| 1                                | Toilet  | 2.00  | 2.00  |
|                                  | Urinal  | 2.00  |       |
|                                  | Floor Drain   | 2.00  |       |
|                                  | Floor Sink  | 2.00  |       |
|                                  | Wash Tray   | 2.00  |       |
|                                  | Sink  | 2.00  |       |
| 1                                | Garbage Disposal (residential)                                      | 2.00  | 2.00  |
|                                  | Garbage Disposal (commercial)                                       | 5.00  |       |
| 1                                | Clothes Dryer (gas) (venting)                                       | 2.00  | 2.00  |
| 1                                | Clothes Washer (residential)  | 2.00  | 2.00  |
|                                  | Clothes Washer (commercial)   | 2.00  |       |
|                                  | Dishwasher (residential)  | 2.00  |       |
|                                  | Dishwasher (commercial)   | 2.00  |       |
|                                  | Dental Unit   | 2.00  |       |
|                                  | Drinking Fountain   | 2.00  |       |
|                                  | Refrigerator - Ice Maker, Water Dispenser                           | 2.00  |       |
|                                  | Any other water using equipment, Attached coffee Makers, Ice Makers | 2.00  |       |
| 1                                | Water Heaters (gas) (electric)                                      | 2.00  | 2.00  |
| <b>SEWER SYSTEM</b>              |   |       |       |
| 1                                | New, Replacement, Modification, or Any Drainage Work                | 10.00 | 10.00 |
|                                  | Grease or Sand Trap or Interceptor                                  | 2.00  |       |
|                                  | Trailer Trap (rental parks)   | 5.00  |       |
| <b>WATER SOFTENERS</b>           |   |       |       |
|                                  | Non Permanent Type (rental)   | 2.00  |       |
|                                  | Permanent Type (connected to drain)                                 | 2.00  |       |
| <b>SWIMMING POOLS</b>            |   |       |       |
|                                  | Private or Wading Pool (including spa)                              | 20.00 |       |
|                                  | Public or Semi Public   | 30.00 |       |
|                                  | Spas - Performed (private)  | 10.00 |       |
|                                  | Spas - Performed (commercial)                                       | 20.00 |       |
| <b>WATER DISTRIBUTION SYSTEM</b> |   |       |       |
| 1                                | Single Family Dwelling  | 6.00  | 6.00  |
|                                  | Multi Family Dwelling   | 6.00  |       |
|                                  | Plus Each Dwelling Unit   | 3.00  |       |
|                                  | Commercial Building per floor                                       | 3.00  |       |
|                                  | Plus Each Unit (leased space or office)                             | 2.00  |       |

| UNITS                                      | DESCRIPTION   | FEE   | TOTAL    |
|--|---|-------|----------|
|  | Hotel or Motel  | 8.00  |          |
|  | Plus Each Unit  | 3.00  |          |
|  | Trailer Park  | 30.00 |          |
|  | Plus Each Space   | 2.00  |          |
|  | Irrigation  | 8.00  |          |
| <b>FUEL PIPING SYSTEM</b>                  |   |       |          |
| 1  | Single Family Dwelling  | 6.00  | 6.00     |
|  | Multi-Family Dwelling   | 10.00 |          |
|  | Plus Each Unit  | 2.00  |          |
|  | Commercial Building (per floor)   | 6.00  |          |
|  | Plus Each Unit (leased space or office)   | 6.00  |          |
|  | Medium Pressure Gas System (plan check)   | 12.00 |          |
| 4  | Each Gas Appliance (any type)   | 2.00  | 8.00     |
|  | Standby Emergency (generating engines)  | 5.00  |          |
|  | Steam Boilers   | 5.00  |          |
|  | Service Station Fuel Tank and Piping System   | 10.00 |          |
|  |   | 10.00 |          |
| <b>AUTOMATIC FIRE EXTINGUISHING SYSTEM</b> |   |       |          |
|  | Underground Piping  | 20.00 |          |
|  | Distribution Piping (per foot)  | 05    |          |
|  | Sprinkler Head (each)   | 20    |          |
|  | In Range Hood and Vent  | 10.00 |          |
|  | Dry Standpipe System  |       |          |
|  | Piping  | 75.00 |          |
|  | Each Outlet   | 2.00  |          |
|  | Wet Standpipe System  |       |          |
|  | Piping  | 10.00 |          |
|  | Fire Hose Cabinet   | 2.00  |          |
| <b>SOLAR ENERGY SYSTEMS</b>                |   |       |          |
|  | Collectors (including piping) (per collector)   | 5.00  |          |
|  | Storage Tanks (each)  | 5.00  |          |
| <b>PIPELINE CONTRACT</b>                   |   |       |          |
|  | For Onsite Sewer, Gas or Water Contract Value Fee based on Building Code Permit Valuation Chart.                      |       |          |
|  | Inspections for which no fee is specifically indicated (minimum charge - one half hour)                               | 15.00 | per hour |
|  | Additional plan review required by changes, additions or revisions to approved plans (minimum charge - one half hour) | 15.00 | per hour |

Plumbing permit fees may be computed the same as building permit fees by using the cost of installation for valuation amount when such work is not included in the above schedule.

I hereby certify that I have carefully examined and read the above application; that the same is true and correct, and that the work herein described is to be done in accordance with all the provisions of the applicable Ordinances of the City of Las Vegas, Nevada, and the State Laws, whether herein specified or not.

Approval for the work under this permit will be given only after refuse and debris have been removed from job site and public right of way.

PLM # 1710 00  
STL \$ 1750.00  
TOTL \$ 1750.00  
CHECK RECEIPT: 00  
#7168 SR#001/01  
CITY - LAS VEGAS  
BLDG. & SAFETY  
# 12/11/80

SIGNED J. E. Cannon Date 12/11/80  
Registered Master Plumber, Spec. Cont'r. or Owner.  
BUILDING DIVISION Toni Date 12/11/80  
PERMIT NO. 7168 PERMIT FEE \$ 54.00

*W. J. ... 6-28-82*

# CITY OF LAS VEGAS, NEVADA

**DEPARTMENT OF PUBLIC SERVICES — AIR CONDITIONING APPLICATION & PERMIT**  
**DIVISION OF BUILDING AND SAFETY**

ADDRESS OF CONSTRUCTION: 6425 Adely Dr., Apt. 3, Bldg. 1 OWNER'S NAME: Proco, Inc.

CIRCLE: Addition; Remodel; New Bldg. TYPE OF BLDG.: SFD APT. COMM. PUB. STATE LICENSE # 11191

CONTRACTOR'S NAME: Certified Air Cond. Co., Inc. STATE LICENSE # 11417

| UNITS | DESCRIPTION  | FEE   | TOTAL |
|-------|--|-------|-------|
|       | <b>PERMIT ISSUANCE</b>   |       |       |
|       | For the issuance of each permit.   | 10.00 | 10.00 |
|       | For issuing each supplemental permit.  | 3.00  |       |
|       | <b>UNIT FEE SCHEDULE</b>   |       |       |
|       | For the installation or relocation of each forced-air or gravity-type furnace or burner, including ducts and vents attached to such appliance, up to and including 100,000 Btu/h.  | 6.00  |       |
|       | For the installation or relocation of each forced-air or gravity-type furnace or burner, including ducts and vents attached to such appliance over 100,000 Btu/h.  | 7.50  |       |
|       | For the installation or relocation of each floor furnace, including vent.  | 6.00  |       |
|       | For the installation or relocation of each suspended heater, recessed wall heater or floor-mounted unit heater.  | 6.00  |       |
|       | For the installation, relocation or replacement of each appliance vent installed and not included in an appliance permit.  | 3.00  |       |
|       | For the repair, alteration of, or addition to each heating appliance, refrigeration unit, cooling unit, absorption unit, or each heating, cooling, absorption, or evaporative cooling system, including installation of controls regulated by this code. | 6.00  |       |
|       | For the installation or relocation of each boiler or compressor to and including three horsepower, or each absorption system to and including 100,000 Btu/h.   | 11.00 | 11.00 |
| 1     | For the installation or relocation of each boiler or compressor over three horsepower to and including 15 horsepower, or each absorption system over 100,000 Btu/h and including 500,000 Btu/h.  | 15.00 |       |
|       | For the installation or relocation of each boiler or compressor over 15 horsepower to and including 50 horsepower, or each absorption system over 500,000 Btu/h to and including 1,000,000 Btu/h.  | 22.50 |       |
|       | For the installation or relocation of each boiler or refrigeration compressor over 50 horsepower, or each absorption system over 1,750,000 Btu/h.  | 37.50 |       |

| UNITS | DESCRIPTION   | FEE            | TOTAL |
|-------|---|----------------|-------|
|       | For each duct system to and including 10,000 cubic feet per minute including ducts attached thereto.<br>Note: This fee shall not apply to air-handling unit which is a portion of a factory-assembled appliance, cooling unit, evaporative cooler or absorption unit for which a permit is required elsewhere in this code. | 4.50           |       |
|       | For each air-handling unit over 10,000 cfm.   | 7.50           |       |
|       | For each evaporative cooler other than portable.  | 4.50           |       |
|       | For each mechanical exhaust fan connected to a single duct.   | 3.00           | 3.00  |
|       | For each mechanical exhaust fan connected to a single duct system which is not a portion of a heating or air-conditioning system authorized by permit.  | 4.50           |       |
|       | For the installation of each hood which is served by mechanical exhaust, including the ducts for such hood.   | 4.50           |       |
|       | For the installation or relocation of each domestic-type incinerator.   | 7.50           |       |
|       | For the installation or relocation of each commercial or industrial-type incinerator.   | 30.00          |       |
|       | For each appliance or piece of equipment regulated by this code but not classed in other appliance categories, or for which no other fee is listed in this code.  | 4.50           |       |
|       | When Chapter 22 is applicable (see Section 103), permit fees for fuel-gas piping shall be as follows:<br>For each gas-piping system of one to four outlets.<br>For each gas-piping system of more than four outlets, per outlet.  | 2.00<br>50     |       |
|       | <b>OTHER INSPECTIONS AND FEES:</b>  |                |       |
|       | Inspections outside of normal business hours (minimum charge — two hours).  | 15.00 per hour |       |
|       | Reinspection fee assessed under provisions of Section 305 (1).  | 20.00 each     |       |
|       | Inspections for which no fee is specifically indicated (minimum charge — one-half hour).  | 15.00 per hour |       |
|       | Additional plan review required by changes, additions or revisions to approved plans (minimum charge — one-half hour).  | 15.00 per hour |       |
|       | <b>TOTAL PERMIT FEES</b> 24.00  |                |       |

I hereby certify that I have carefully examined and read the above application; that the same is true and correct and that the work herein described is to be done in accordance with all the provisions of the applicable Ordinances of the City of Las Vegas, Nevada and the State Laws, whether herein specified or not.

Approval for the work under this permit will be given only after refuse and debris have been removed from jobsite and public right of way.

SIGNED: [Signature] Date: 1-9-81  
 Air Conditioning Contractor - Owner

BUILDING DIVISION: Toni Date: 1/12/81  
 PERMIT NO.: 7878-14 PERMIT FEE: 24.00

**RECEIPT**

# CITY OF LAS VEGAS, NEVADA

DEPARTMENT OF PUBLIC SERVICES — ELECTRICAL APPLICATION & PERMIT  
DIVISION OF BUILDING AND SAFETY

ADDRESS OF CONSTRUCTION: Approach 80 - L 4 B 1  
6429 Addely Drive

OWNER'S NAME: Dasco, Inc.

CIRCLE: Addition, Remodel, New Bldg. TYPE OF BLDG.: SFD APT. COMM. PUBLIC

CONTRACTOR'S NAME: RIC Electric Co., Inc. STATE LICENSE # 13175 CITY LICENSE # C11-10628

| UNITS | DESCRIPTION   | FEE   | TOTAL |
|-------|---|-------|-------|
| 37    | Receptacles - 20 Outlets - 6 Switches - 11  | .40   | 14.80 |
|       | Wall or Ceiling Space Heaters   | .70   |       |
|       | Blast Coil Heaters (per kilowatt)   | .70   |       |
| 1     | Garbage Grinder Outlet  | .70   | .70   |
|       | Trash Compactor   | .70   |       |
|       | Dishwasher Outlet   | .70   |       |
| 1     | Clothes Dryer Outlet  | .70   | .70   |
|       | Automatic Clothes Washer Outlet   | .70   |       |
|       | Electric Range  | .70   |       |
|       | Electric Water Heater   | .70   |       |
| 6     | Each Fixture or Socket  | .30   | 1.80  |
|       | Each Mercury Arc Lamp and Equipment (sodium)                                      | 1.00  |       |
| 2     | Each Special Purpose Outlet   | .70   | 1.40  |
|       | Each X-ray Unit and its Appurtenances   | 10.00 |       |
|       | Area Lighting - First 3000 Watts  | 8.00  |       |
|       | For Each Additional 1000 Watts  | 3.00  |       |
|       | Total Horsepower Each Motor - Generator, Transformer, Welder                      |       |       |
|       | First Horsepower or KVA   | 3.00  |       |
|       | For Each Additional Horsepower up to 50   | .50   |       |
|       | For Each Horsepower over 50   | .35   |       |
|       | Temporary Power and Lights - Temporary Pole                                       | 6.00  |       |
| 1     | Electric Service, Including First Meter Socket                                    | 6.00  | 6.00  |
|       | For Each Additional Meter Socket  | .50   |       |
|       | Services over 200 to 600 Amperes  | 12.50 |       |
|       | 600 to 1200 Amperes   | 25.00 |       |
|       | over 1200 Amperes   | 50.00 |       |
|       | Sub Panel   | 3.00  |       |
| 1     | Permanently Connected Air Conditioning Service (Heating/Cooling)                  | 3.00  | 3.00  |
|       | Speaker Outlets   | .30   |       |
|       | Signal or Alarm Outlets   | .30   |       |
|       | Amplifiers  | 2.00  |       |
|       | Control Panels  | .50   |       |
|       | T.V. Outlets - Master System Only   | .30   |       |
|       | Swimming Pool (residential)   | 20.00 |       |
|       | Swimming Pool (commercial)  | 30.00 |       |
|       | Spas  | 8.00  |       |
|       | Recreational Vehicles (per space)   | 3.00  |       |
|       | Busways - for Trolley and Plug-in Type Busways, Each 100 Feet or Fraction Thereof | 3.00  |       |
| 1     | Fee for issuing Each Permit   | 10.00 | 10.00 |

Other inspections and fees:

1. Inspections outside of normal business hours = \$15.00 per hour (minimum charge two hours).
2. Re-inspection fee assessed under provisions of Section 305(b) of the Uniform Building Code = \$15.00 per hour.
3. Inspections for which no fee is specifically indicated = \$15.00 per hour (minimum charge one half hour).
4. Additional plan review required by changes, additions or revisions to approved plans = \$15.00 per hour (minimum charge one half hour).

Approval for the work under this permit will be given only after refuse and debris have been removed from job site and public right of way

38.40

I hereby certify that I have carefully examined and read the above application; that the same is true and correct; and that the work herein described is to be done in accordance with all the provisions of the applicable Ordinances of the City of Las Vegas, Nevada and the State Laws, whether herein specified or not.

SIGNED [Signature] Date \_\_\_\_\_  
Master (Electrician) (Technician) (Owner)

BUILDING DIVISION Toni Date 2/4/81

PERMIT NO. 9499-3 PERMIT FEE \$ 38.40

#1721-2462

RECEIPT

J. Conroy 11/1/81

|  |   |                               |        |
|--|---|-------------------------------|--------|
| OWNER <b>Dasco Inc.</b>                      |   | ADDRESS <b>6429 Addely Dr</b> |        |
| DATE <b>12-31-80</b>                         |   | GEN. CONT. <b>Same</b>        |        |
| SFD <b>7636-36</b>                           |   | PERMIT NO. <b>7636-36</b>     |        |
| TYPE OF STRUCTURE <b>L-4-B-1 Approach 80</b> |   | FINAL INSPECTION              |        |
| LEGAL DESCRIPTION                            |   | LOT #                         | AREA # |
| APPROVED FOR OCCUPANCY & METER               |   | <b>F15 3/80</b>               |        |
| <b>BUILDING</b>                              |   | <b>MECHANICAL</b>             |        |
| Investigation                                | Plumbing Cont. <b>J. Conroy</b>                 |                               |        |
| Location & Footing                           | Permit No. <b>7168</b> Date <b>12/4/80</b>      |                               |        |
| Concrete Slab Floor <b>10/17/81</b>          | Heat & Vent. A/C Cont. <b>2/1/81</b>            |                               |        |
| Fireplace Footing                            | Permit No. <b>717813</b> Date <b>1/12/81</b>    |                               |        |
| Chimney Steel                                | Sewer Cont. <b>Dasco Inc.</b>                   |                               |        |
| Vent. Steel Reinf.                           | Permit No. <b>7636</b> Date <b>12/31-80</b>     |                               |        |
| Mech. Steel Reinf.                           | Rough Bell                                      |                               |        |
| Framing <b>10/22/81</b>                      | Rough Water                                     |                               |        |
| Est. Lath                                    | Top Out <b>8/21/81</b>                          |                               |        |
| Est. Brown                                   | Rough Gas                                       |                               |        |
| Drywall <b>10/22/81</b>                      | A/C Rough Duct <b>10/29/81</b>                  |                               |        |
| Final Building <b>BM 7/8/81</b>              | Final Plumbing <b>12/1/81</b>                   |                               |        |
| Appr. for Occu. <b>M 7/8/81</b>              | Final Gas <b>12/4/81</b>                        |                               |        |
| <b>ELECTRICAL</b>                            |   |                               |        |
| Temp. Pole Cont.                             | Final Air Cond. <b>12/2/81</b>                  |                               |        |
| Permit No.                                   | Final Sewer <b>12/12/80</b>                     |                               |        |
| Date   | <b>REMARKS</b>                                  |                               |        |
| Inspection                                   |   |                               |        |
| Date   |   |                               |        |
| Electrical Cont. <b>Ric 9/20</b>             |   |                               |        |
| Permit No. <b>8443</b> Date <b>2-4-81</b>    |   |                               |        |
| Rough  | PLEASE NOTE ADDITIONAL REMARKS ON REVERSE SIDE. |                               |        |
| Final Rough                                  | DIV OF BLDG & SAFETY                            |                               |        |
| Final Electrical <b>10/15-22/81</b>          | CITY OF LAS VEGAS                               |                               |        |
| Temporary Service                            | REV. 10-78                                      |                               |        |
|  | 79-3-16   |                               |        |



*Uplander Allen 6-28-72*

**CITY OF LAS VEGAS, NEVADA**

**DEPARTMENT OF PUBLIC SERVICES - AIR CONDITIONING APPLICATIONS SECTION  
DIVISION OF BUILDING AND SAFETY**

ADDRESS OF CONSTRUCTION: 3131 Adams Dr. Las Vegas, NV OWNER'S NAME: \_\_\_\_\_

CIRCLE: Addition; Remodel; New Bldg. TYPE OF BLDG.: RES. APT. COMM. PUBLIC

CONTRACTOR'S NAME: Carr Med Air Cond. Co., Inc. STATE LICENSE # 11191 CITY LICENSE # 11417

| UNITS                    | DESCRIPTION  | FEE   | TOTAL |
|--------------------------|--|-------|-------|
| <b>PERMIT ISSUANCE</b>   |  |       |       |
|                          | For the issuance of each permit.   | 10.00 | 10.00 |
|                          | For issuing each supplemental permit.  | 3.00  |       |
| <b>UNIT FEE SCHEDULE</b> |  |       |       |
|                          | For the installation or relocation of each forced-air or gravity-type furnace or burner, including ducts and vents attached to such appliance, up to and including 100,000 Btu/h.  | 6.00  |       |
|                          | For the installation or relocation of each forced-air or gravity-type furnace or burner, including ducts and vents attached to such appliance over 100,000 Btu/h.  | 7.50  |       |
|                          | For the installation or relocation of each floor furnace, including vent.  | 6.00  |       |
|                          | For the installation or relocation of each suspended heater, recessed wall heater or floor-mounted unit heater.  | 6.00  |       |
|                          | For the installation, relocation or replacement of each appliance vent installed and not included in an appliance permit.  | 3.00  |       |
|                          | For the repair, alteration of, or addition to each heating appliance, refrigeration unit, cooling unit, absorption unit, or each heating, cooling, absorption, or evaporative cooling system, including installation of controls regulated by this code. | 6.00  |       |
| 1                        | For the installation or relocation of each boiler or compressor to and including three horsepower, or each absorption system to and including 100,000 Btu/h.   | 6.00  | 6.00  |
|                          | For the installation or relocation of each boiler or compressor over three horsepower to and including 15 horsepower, or each absorption system over 100,000 Btu/h and including 500,000 Btu/h.  | 11.00 |       |
|                          | For the installation or relocation of each boiler or compressor over 15 horsepower to and including 30 horsepower, or each absorption system over 500,000 Btu/h to and including 1,000,000 Btu/h.  | 18.00 |       |
|                          | For the installation or relocation of each boiler or compressor over 30 horsepower to and including 50 horsepower, or for each absorption system over 1,000,000 Btu/h to and including 1,750,000 Btu/h.  | 22.50 |       |
|                          | For the installation or relocation of each boiler or refrigeration compressor over 50 horsepower, or each absorption system over 1,750,000 Btu/h.  | 37.50 |       |

| UNITS                              | DESCRIPTION   | FEE            | TOTAL |
|------------------------------------|---|----------------|-------|
|                                    | For each air-handling unit to and including 10,000 cubic feet per minute, including ducts attached thereto.<br>Note: This fee shall not apply to an air-handling unit which is a portion of a factory-assembled appliance, cooling unit, evaporative cooler or absorption unit for which a permit is required elsewhere in this code. | 4.50           |       |
|                                    | For each air-handling unit over 10,000 cfm.   | 7.50           |       |
|                                    | For each evaporative cooler other than portable type.   | 4.50           |       |
| 1                                  | For each ventilation fan connected to a single duct.  | 3.00           | 3.00  |
|                                    | For each ventilation system which is not a portion of any heating or air-conditioning system authorized by a permit.  | 4.50           |       |
|                                    | For the installation of each hood which is served by mechanical exhaust, including the ducts for such hood.   | 4.50           |       |
|                                    | For the installation or relocation of each domestic-type incinerator.   | 7.50           |       |
|                                    | For the installation or relocation of each commercial or industrial-type incinerator.   | 30.00          |       |
|                                    | For each appliance or piece of equipment regulated by this code but not classed in other appliance categories, or for which no other fee is listed in this code.  | 4.50           |       |
|                                    | When Chapter 22 is applicable (see Section 103), permit fees for fuel-gas piping shall be as follows:<br>For each gas-piping system of one to four outlets.<br>For each gas-piping system of more than four outlets, per outlet.  | 2.00<br>50     |       |
| <b>OTHER INSPECTIONS AND FEES:</b> |   |                |       |
|                                    | Inspections outside of normal business hours (minimum charge - two hours).  | 15.00 per hour |       |
|                                    | Reinspection fee assessed under provisions of Section 305 (1).  | 15.00 each     |       |
|                                    | Inspections for which no fee is specifically indicated (minimum charge - one-half hour).  | 15.00 per hour |       |
|                                    | Additional plan review required by changes, additions or revisions to approved plans (minimum charge - one-half hour).  | 15.00 per hour |       |
| <b>TOTAL PERMIT FEE \$</b>         |   | <b>19.00</b>   |       |

I hereby certify that I have carefully examined and read the above application; that the same is true and correct, and that the work herein described is to be done in accordance with all the provisions of the applicable Ordinances of the City of Las Vegas, Nevada and the State Laws, whether herein specified or not.

Approval for the work under this permit will be given only after refuse and debris have been removed from job site and public right of way.

SIGNED: [Signature]  
Air Conditioning Contractor - Owner

BUILDING DIVISION: 1000

PERMIT NO.: 7878-13

RECEIPT